

BENCHMARKS:

#1: "□" CUT CHISELED ON CURB,
15.2' S. OF SW COR., LOT 6,
BLOCK A, ROCKY FORD 2ND
ADDITION.
ELEV. = 1385.10 NAVD88

#2: "□" CUT CHISELED ON CURB,
8.6' N. & 11.7' W. OF SW COR.,
LOT 14, BLOCK C, ROCKY FORD
2ND ADDITION.
ELEV. = 1380.11 NAVD88

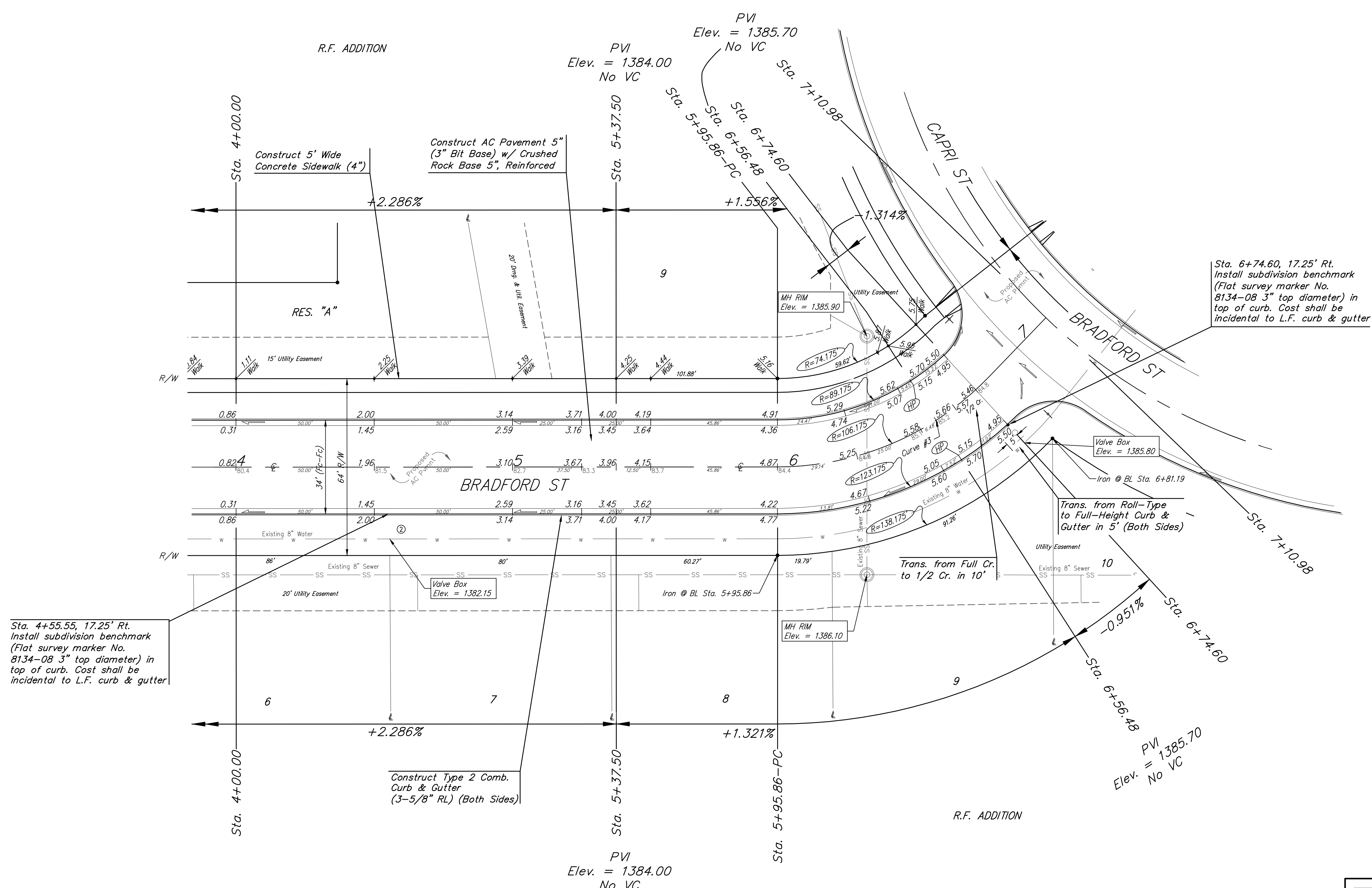
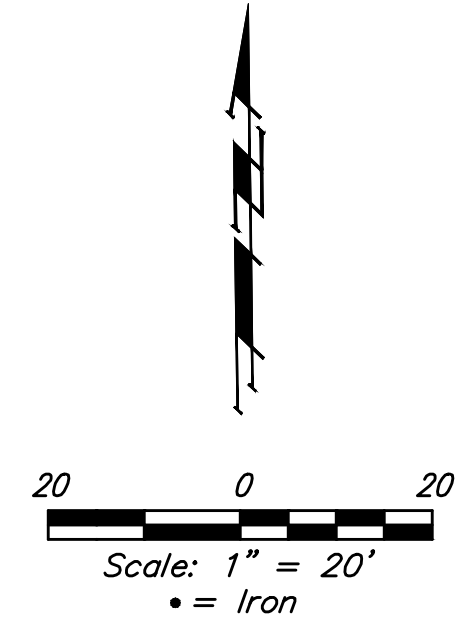

Sta. 4+55.55, 17.25' Rt.
Install subdivision benchmark
(Flat survey marker No.
8134-08 3" top diameter) in
top of curb. Cost shall be
incidental to L.F. curb & gutter

Sta. 6+74.60, 17.25' Rt.
Install subdivision benchmark
(Flat survey marker No.
8134-08 3" top diameter) in
top of curb. Cost shall be
incidental to L.F. curb & gutter

Curve #3
Curve Data Based on Centerline
Rad. = 106.17' Delta = 46°02'58" Tangent = 45.12'
Arc = 78.74' L.C. = 83.05' Def./Ft. = 17.54487 Min.

Station	Arc	Face Chord Lengths		Defl.	Total Defl.
		0' Left	0' Right		
5+95.86	-	-	-	0°00'00"	0°00'00"
6+00.00	4.14'	3.77'	5.20'	1°12'38"	1°12'38"
6+25.00	25.00'	22.69'	31.35'	7°18'37"	8°31'15"
6+50.00	25.00'	22.69'	31.35'	7°18'38"	15°49'53"
6+74.60	24.60'	22.33'	30.85'	7°11'36"	23°01'29"

Subdivision Benchmarks

Street & Station	Location Description	Elevation
Bradford St 2+03.55, 17.25' Rt.	Adjacent to Fire Hydrant North of the NE Cor., Lot 3, Blk B	
Bradford St 6+74.60, 17.25' Rt.	Adjacent to Fire Hydrant at W. End of SE Curb Return of Bradford St.	
Capri St 6+42.36, 17.25' Rt.	Adjacent to Fire Hydrant North of the NE Cor., Lot 2, Blk D	

Roll type curb & gutter to
be constructed on the pavement
on this sheet.
Top of curb elevation are given
for full height curb.

	R.F. Addition - Phase I	
	BRADFORD	
Sta. 4+00.00 to Sta. 6+74.60		
Baughman Company, P.A. 315 Ellis St. Wichita, KS 67211 P 316-262-7271 F 316-262-0149		
ENGINEERING SURVEYING PLANNING LANDSCAPE ARCHITECTURE		
PROJECT NUMBER 472-2019-085533	DESIGN AEG	DRAWN HW
REVISIONS:	APPROVED	DATE 05/11/20
	SCALE Noted	SHEET
		8 OF 28