

BENCHMARKS:

#1: "□" CUT CHISELED ON CURB,
15.2' S. OF SW COR., LOT 6,
BLOCK A, ROCKY FORD 2ND
ADDITION.
ELEV. = 1385.10 NAVD88

#2: "□" CUT CHISELED ON CURB,
8.6' N. & 11.7' W. OF SW COR.,
LOT 14, BLOCK C, ROCKY FORD
2ND ADDITION.
ELEV. = 1380.11 NAVD88

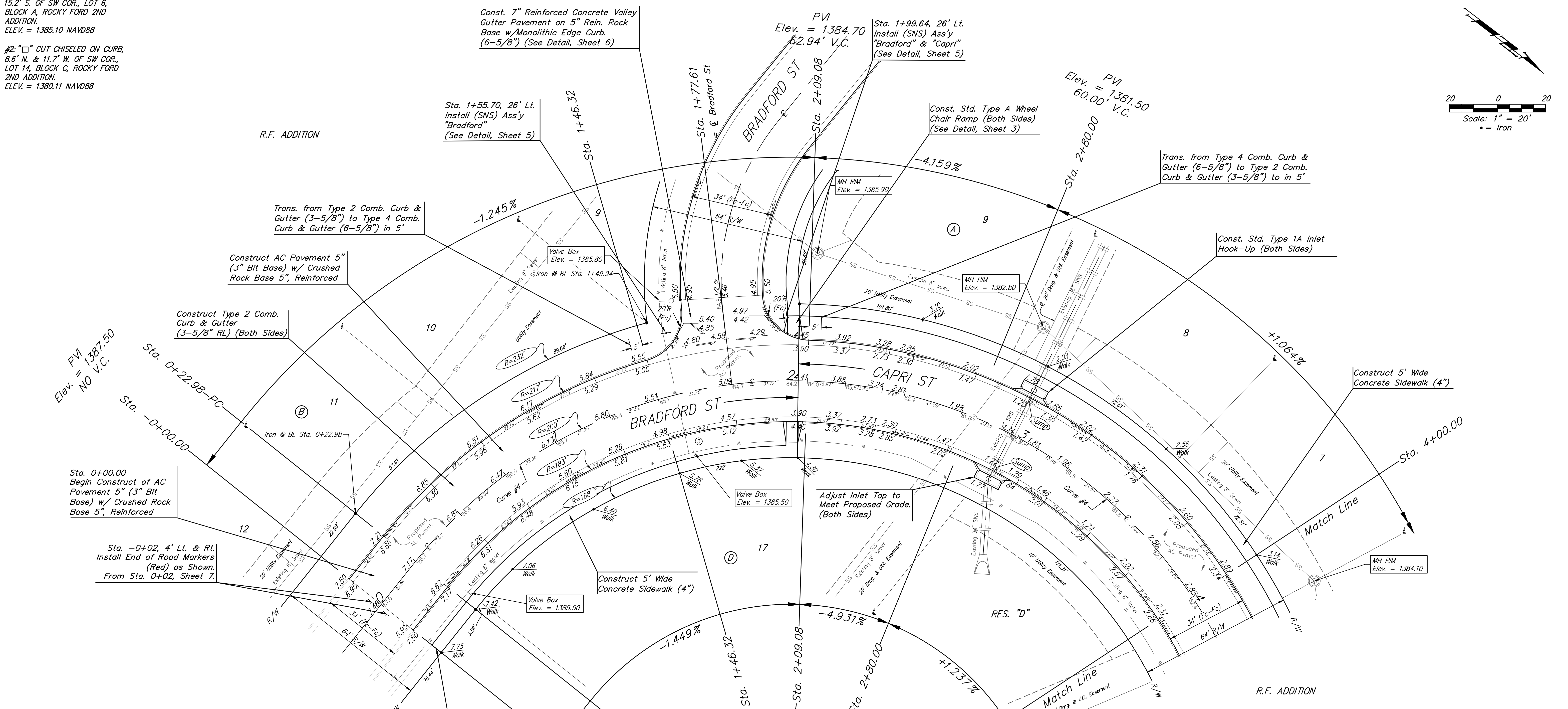
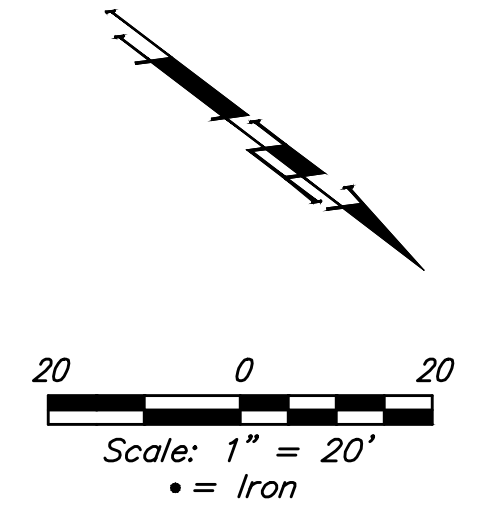

Curve #4
Curve Data Based on Centerline

Rad. = 200' Delta = 138°27'05" Tangent = 527.22'
Arc = 483.29' L.C. = 373.99' Def./Ft. = 8.59431 Min.

Station	Arc	Face Chord Lengths		Def.	Total Def.
		0' Left	0' Right		
0+22.98	-	-	-	0'00"00"	0'00"00"
0+25.00	2.02'	2.19'	1.85'	0'17"22"	0'17"22"
0+50.00	25.00'	27.11'	22.86'	3'34"51"	3'52"13"
0+75.00	25.00'	27.11'	22.86'	3'34"52"	7'27"05"
1+00.00	25.00'	27.11'	22.86'	3'34"51"	11'01"56"
1+25.00	25.00'	27.11'	22.86'	3'34"51"	14'36"47"
1+50.00	25.00'	27.11'	22.86'	3'34"52"	18'11"39"
1+75.00	25.00'	27.11'	22.86'	3'34"51"	21'46"30"
2+00.00	25.00'	27.11'	22.86'	3'34"52"	25'21"22"
2+25.00	25.00'	27.11'	22.86'	3'34"51"	28'56"13"
2+50.00	25.00'	27.11'	22.86'	3'34"52"	32'31"05"
2+75.00	25.00'	27.11'	22.86'	3'34"51"	36'05"56"
3+00.00	25.00'	27.11'	22.86'	3'34"52"	39'40'48"
3+25.00	25.00'	27.11'	22.86'	3'34"51"	43'15'39"
3+50.00	25.00'	27.11'	22.86'	3'34"52"	46'50'31"

3+75.00	25.00'	27.11'	22.86'	3'34"51"	50'25"22"
4+00.00	25.00'	27.11'	22.86'	3'34"51"	54'00"13"
4+25.00	25.00'	27.11'	22.86'	3'34"52"	57'35"05"
4+50.00	25.00'	27.11'	22.86'	3'34"51"	61'09"56"
4+75.00	25.00'	27.11'	22.86'	3'34"52"	64'44'48"
5+00.00	25.00'	27.11'	22.86'	3'34"51"	68'19'39"
5+06.27	6.27'	6.80'	5.74'	0'53"53"	69'13"32"

Roll type curb & gutter to be constructed on the pavement on this sheet.
Top of curb elevation are given for full height curb.

Baughman R.F. Addition - Phase I
CAPRI
Sta. 0+00.00 to Sta. 4+00.00

Baughman Company, P.A. 315 Ellis St. Wichita, KS 67211 P 316-262-7271 F 316-262-0149
ENGINEERING | SURVEYING | PLANNING | LANDSCAPE ARCHITECTURE

PROJECT NUMBER 472-2019-085533	DESIGN AEG	DRAWN HW
REVISIONS:	APPROVED	DATE 05/11/20
SCALE Noted		SHEET 9 OF 28

C:\Projects\R.F. Addition_1802\F317\Engineering\Phase I\STR\STR PLANS.dwg