

4/6/2020 2:33:33 PM
 BIM 360://198014-003 - Watson Park Events Center New
 Building/198014-003-MASTER ELEC-R18.rvt

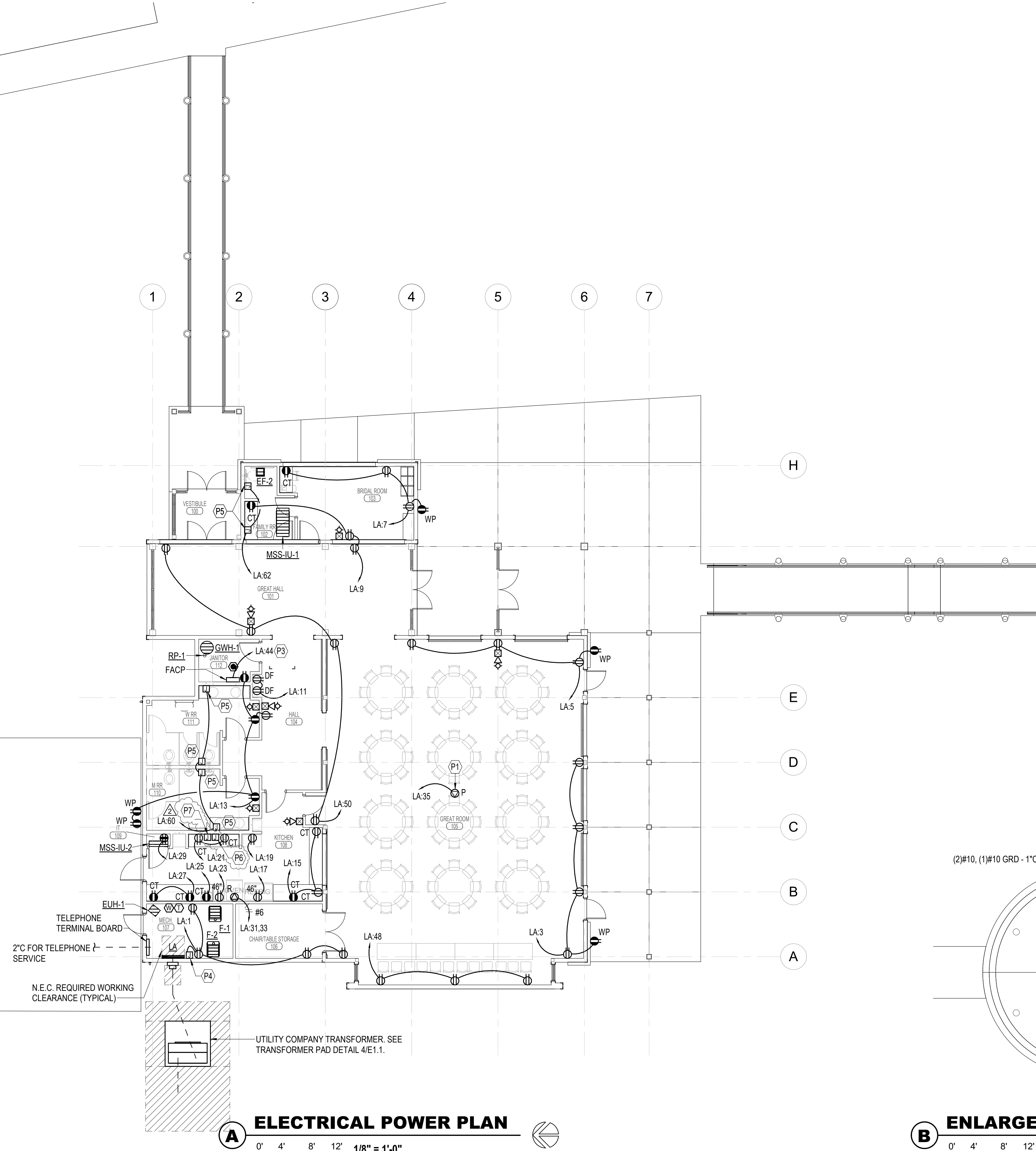

A ELECTRICAL POWER PLAN
 0' 4' 8' 12' 1/8" = 1'-0"

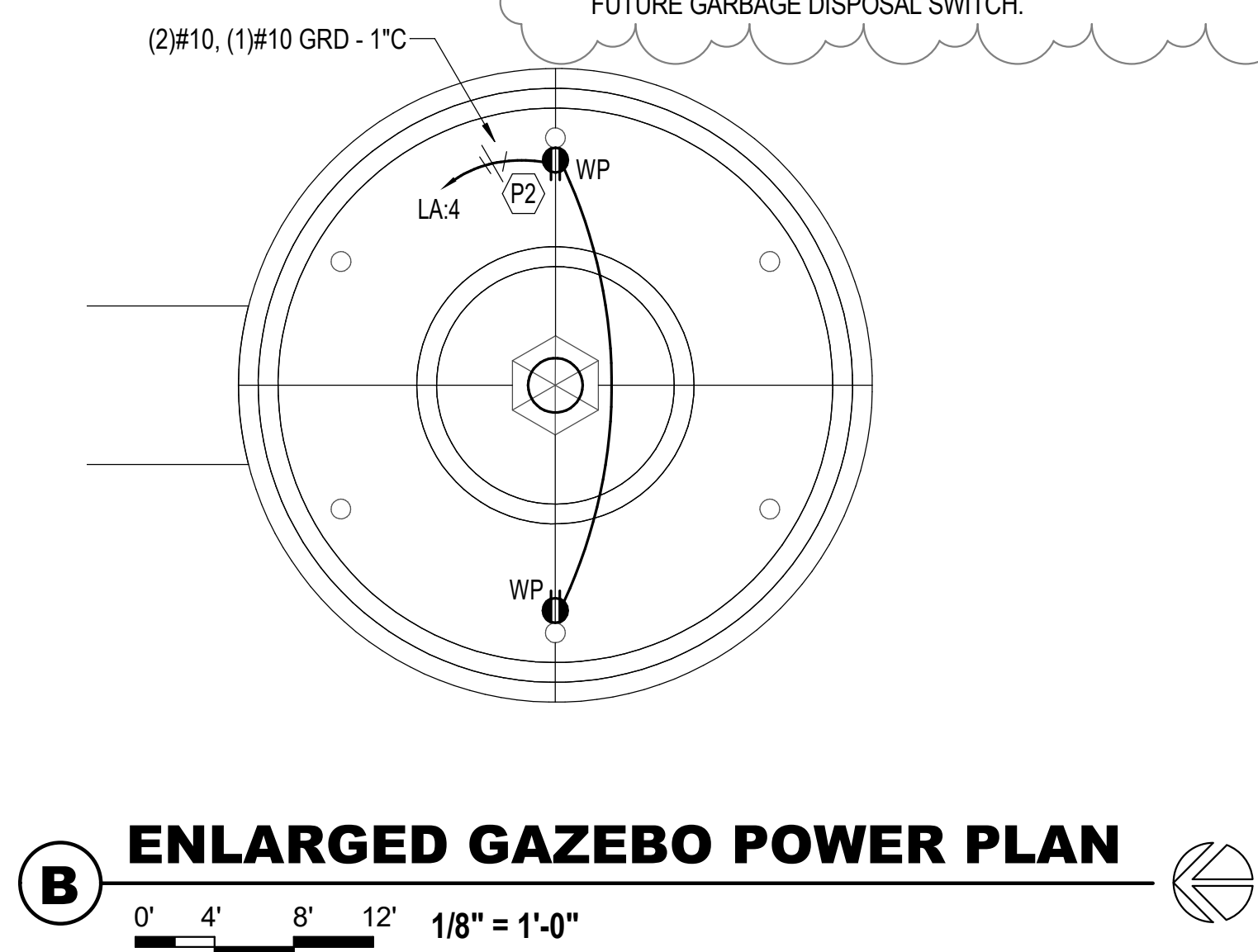

B ENLARGED GAZEBO POWER PLAN
 0' 4' 8' 12' 1/8" = 1'-0"

POWER PLAN NOTES:

1. BRANCH CIRCUITS ARE INDICATED AS ONE CIRCUIT HOME RUNS WITH INDIVIDUAL NEUTRALS. A MAXIMUM OF THREE CIRCUITS (MAXIMUM OF THREE PHASE CONDUCTORS) MAY BE GROUPED IN A SINGLE CONDUIT. WHERE MULTIPLE CIRCUITS ARE LOCATED IN THE SAME RACEWAY, JUNCTION BOX OR ENCLOSURE, NEUTRALS SHALL BE MARKED OR LABELED TO INDICATE WHICH CIRCUIT THEY ARE ASSOCIATED WITH. SEE SPECIFICATION SECTION "LOW VOLTAGE ELECTRICAL POWER CONDUCTORS AND CABLES" FOR ADDITIONAL INFORMATION.
2. A GROUND CONDUCTOR SIZED PER N.E.C. ARTICLE 250 IS REQUIRED IN ALL CONDUITS.
3. FOR CONNECTION REQUIREMENTS TO MECHANICAL UNITS, SEE MECHANICAL EQUIPMENT CONNECTION SCHEDULE.
4. ALL PENETRATIONS IN THE RATED WALLS AND CEILINGS SHALL BE SEALED WITH A MATERIAL CAPABLE OF PREVENTING THE PASSAGE OF FLAMES AND HOT GASSES. THE SEALANT SHALL HAVE A T-RATING OF ONE HOUR.
5. ALL PIPING, CONDUIT, AND OUTLET BOXES (ELECTRIC, TELEPHONE, COMPUTER, ETC.) IN THE RATED WALLS OR CEILING SHALL BE CONSTRUCTED OF NON-COMBUSTIBLE MATERIAL.
6. OUTLET BOXES (ELECTRIC, TELEPHONE, COMPUTER, ETC.) SHALL BE LIMITED TO TWO OUTLET BOXES PER STUD SPACE. OUTLET BOXES ON OPPOSITE SIDES OF THE RATED WALLS SHALL BE SEPARATED BY A HORIZONTAL DISTANCE OF 24 INCHES.

KEYED NOTES:

- P1 VERIFY EXACT LOCATION OF PROJECTOR WITH I.T. PRIOR TO ROUGH-IN.
- P2 ROUTE WIRING BACK TO PANEL 'LA' THROUGH EXISTING (2)3/4" CONDUIT STUBBED UP AT COLUMN.
- P3 PROVIDE (2)TELEPHONE LINES FOR FIRE ALARM CONTROL COMMUNICATION.
- P4 POWER CONNECTION FOR MOTORIZED DAMPER TO BE INTERLOCKED WITH FURNACE FANS. MOTORIZED DAMPER TO BE OPEN WHEN FURNACE FAN IS ON.
- P5 JUNCTION BOX MOUNTED ABOVE NEAREST ACCESSIBLE CEILING FOR CONNECTION TO LAVATORY/FLUSH VALVE SENSORS. COORDINATE LOCATION WITH PLUMBING CONTRACTOR. CONTRACTOR TO PROVIDE ALL LINE-LOW VOLTAGE WIRING, 1/2" CONDUIT DOWN WALL TO SENSOR LOCATIONS, AND CONNECTIONS TO PROVIDE A COMPLETE AND WORKING SYSTEM.
- P6 ROUTE EMPTY 3/4" CONDUIT WITH PULLROPE FROM ACCESSIBLE CEILING DOWN TO JUNCTION BOX WITH BLANK COVERPLATE AT 16" AFF FOR CONNECTION OF FUTURE GARBAGE DISPOSAL.
- P7 ROUTE EMPTY 3/4" CONDUIT WITH PULLROPE FROM ACCESSIBLE CEILING DOWN TO JUNCTION BOX WITH BLANK VINYL COVERPLATE AT 40" AFF FOR FUTURE GARBAGE DISPOSAL SWITCH.

