

**BENCHMARKS:**  
 BM #1: City of Wichita BM Disk  
 South end of East return  
 Marblefalls & 48th ST N  
 SW of the NW corner of Lot 4,  
 Block A, Falcon Falls 2nd  
 Addition  
 Elev. = 1354.34 (NGVD29)

BM #2: "□" Top of Curb NE of  
 the NW corner of Lot 5, Block  
 B, Falcon Falls 2nd Addition  
 Elev. = 1359.13 (NGVD29)

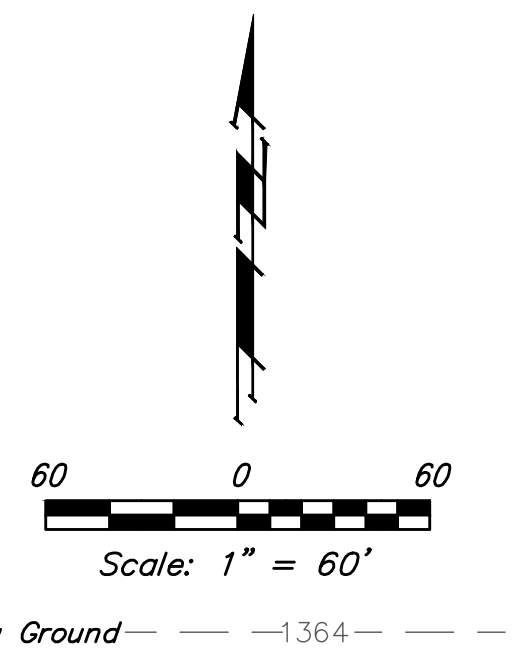
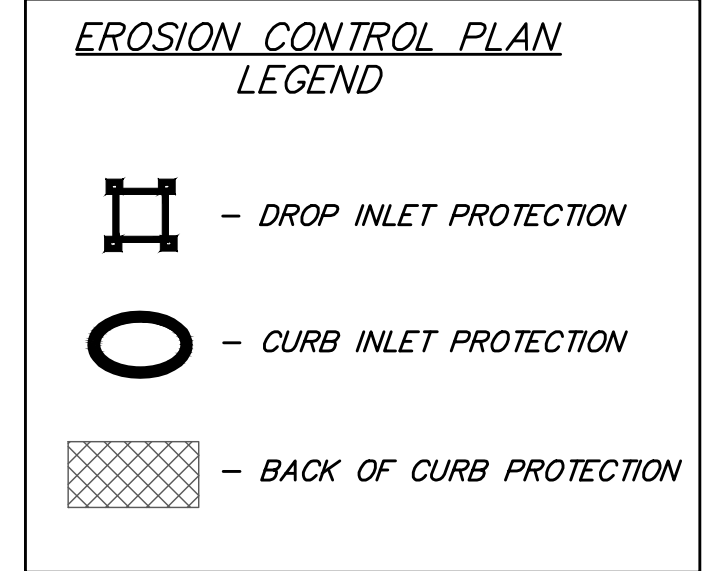
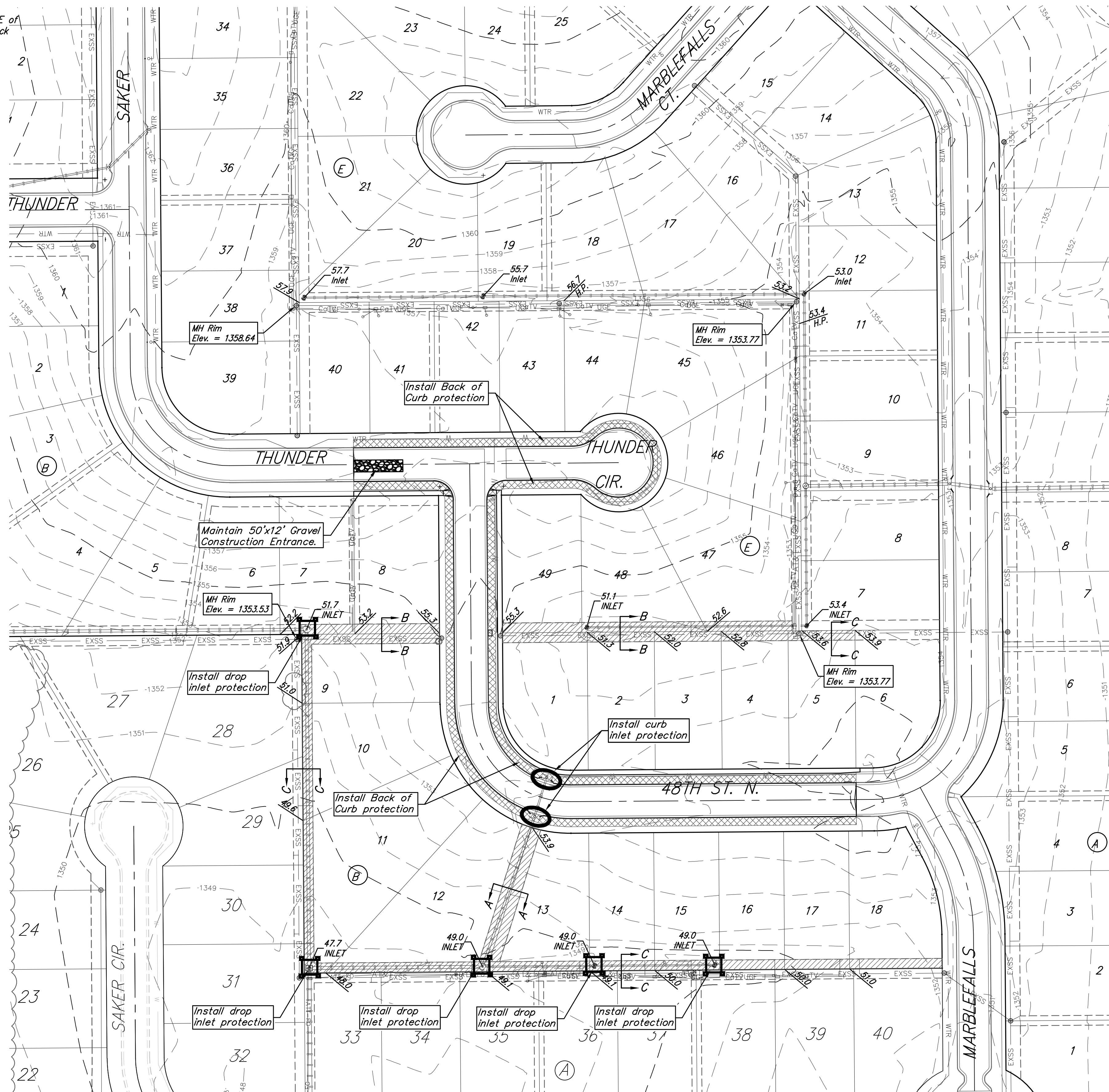

= Easements To Be Graded

Easements were graded with the previous phase Storm water Drain project. The Contractor of this project shall fine grade the easements as shown to the elevations given on the easement grading plan.

The Contractor shall 'straight' grade the easements between the elevations given. Where a callout designates 'Match', the Contractor will grade to the existing ground elevation.

Excess excavation from easement grading and from sanitary sewer construction shall be placed on the lots as indicated to the elevations shown.

All cost to be included in the Lump Sum bid item "Easement Grading"

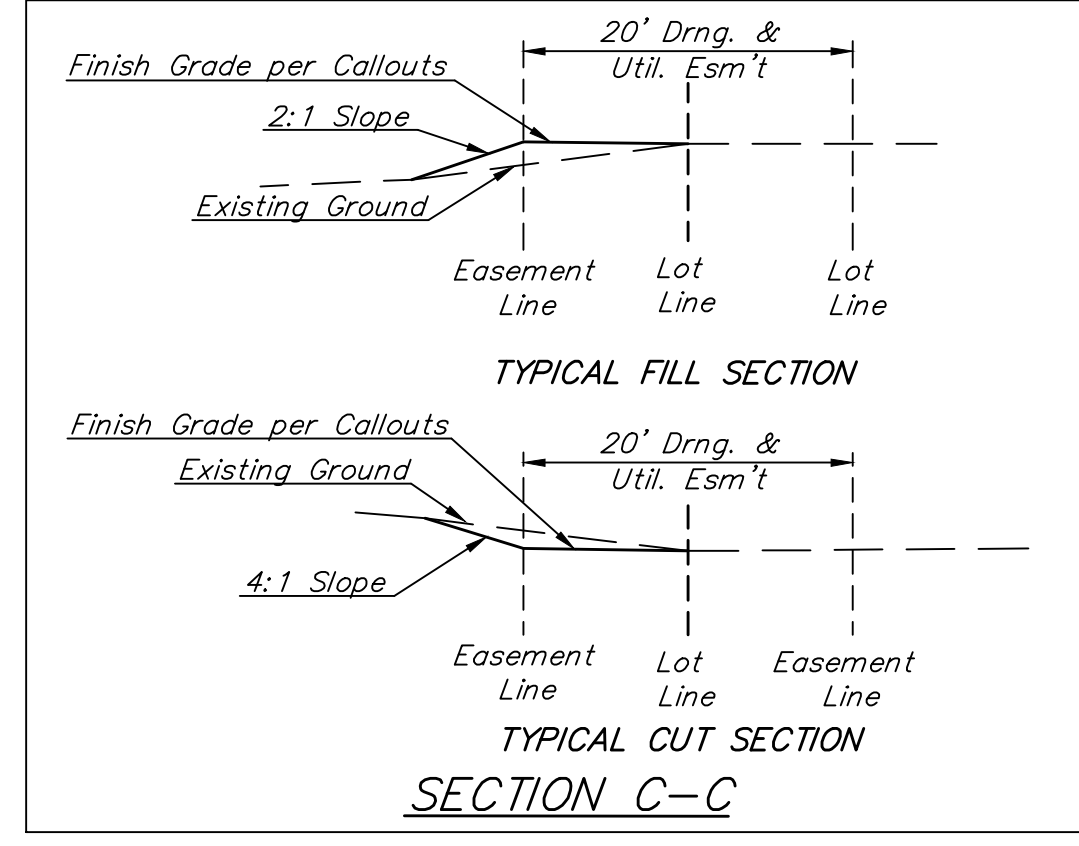
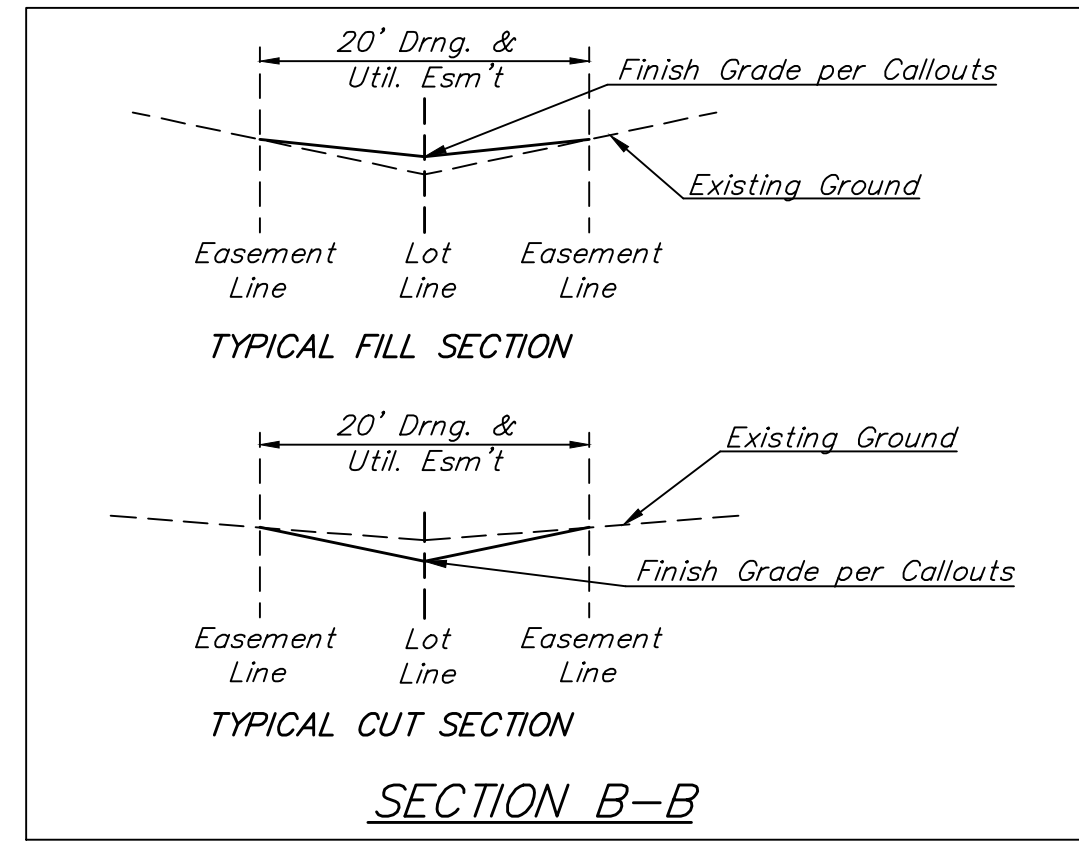
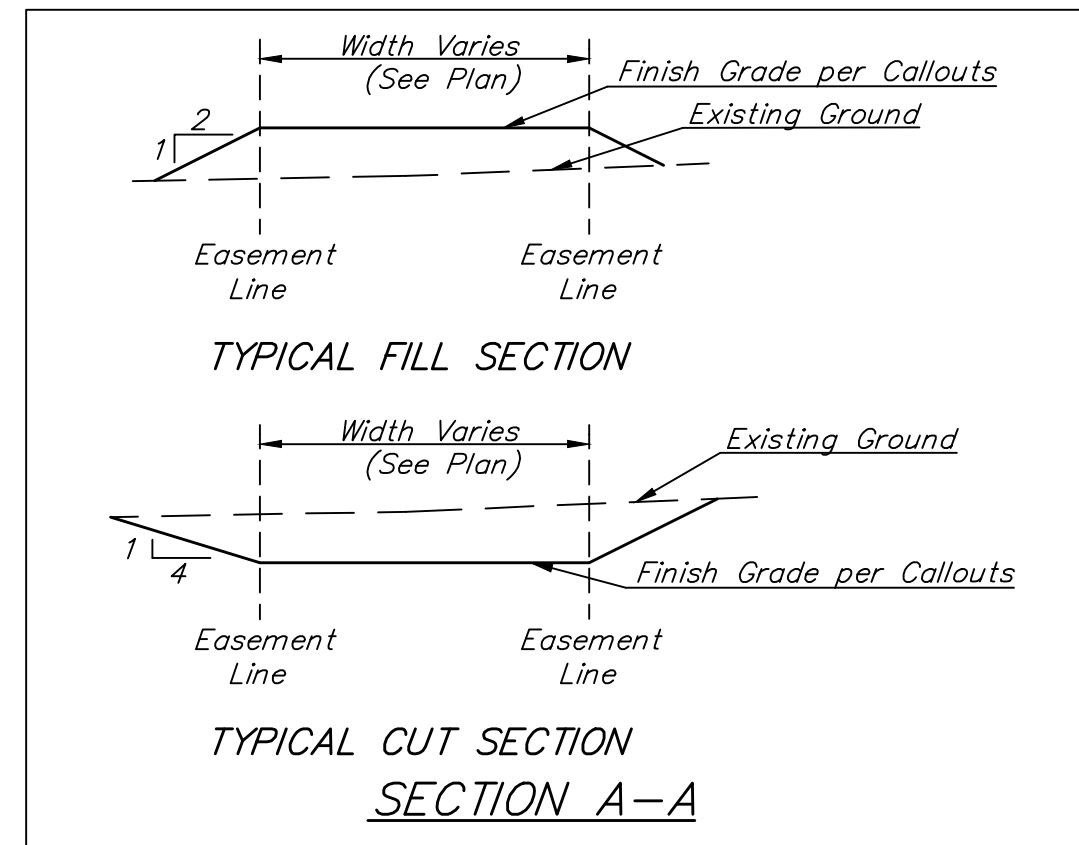

EROSION CONTROL MEASURE	INSTALL	MAINTAIN
BACK OF CURB PROTECTION (LF)	1,955	0
CONSTRUCTION ENTRANCE (EA)	0	1
CURB INLET BARRIER (EA)	2	0
DROP INLET BARRIER (EA)	5	0
MAINTAIN EROSION CONTROL BMP's (LS)	0	1

\* ALL EXISTING BMPs INCLUDING CONSTRUCTION ENTRANCE, SEDIMENT BARRIERS, SILT FENCE, CUT-OFF TRENCH, AND EROSION CONTROL MAT SHALL BE MAINTAINED AND REPAIRED IF NECESSARY.

- NOTES:**
- Contractor shall make sure all erosion control is in place before project is accepted. This plan represents the minimum standard. Any additional erosion control measures shall be installed by the Contractor as needed.
  - Removal of Gravel Construction Entrance for pavement construction shall be included in bid item "Site Clearing & Restoration"
  - This Plan is **Not** To Be Used As A Comprehensive Grading Plan. All Spot Elevations Are Proposed & Subject To Change.
- All areas disturbed during construction shall be seeded, mulched, and fertilized as per Cover Sheet General Notes.

**Baughman** Falcon Fall 2nd Addition - Phase 4B  
**EROSION CONTROL**  
 Street Improvements

Baughman Company, P.A. 315 Ellis St. Wichita, KS 67211 P 316-262-7271 F 316-262-0149  
 ENGINEERING | SURVEYING | PLANNING | LANDSCAPE ARCHITECTURE

PROJECT NUMBER 472-85468	DESIGN AEG	DRAWN JAK
REVISIONS:	APPROVED	DATE June 29, 2020
	SCALE Noted	SHEET <b>10 OF 22</b>