

MATCH SHEET 16

MATCH SHEET 16

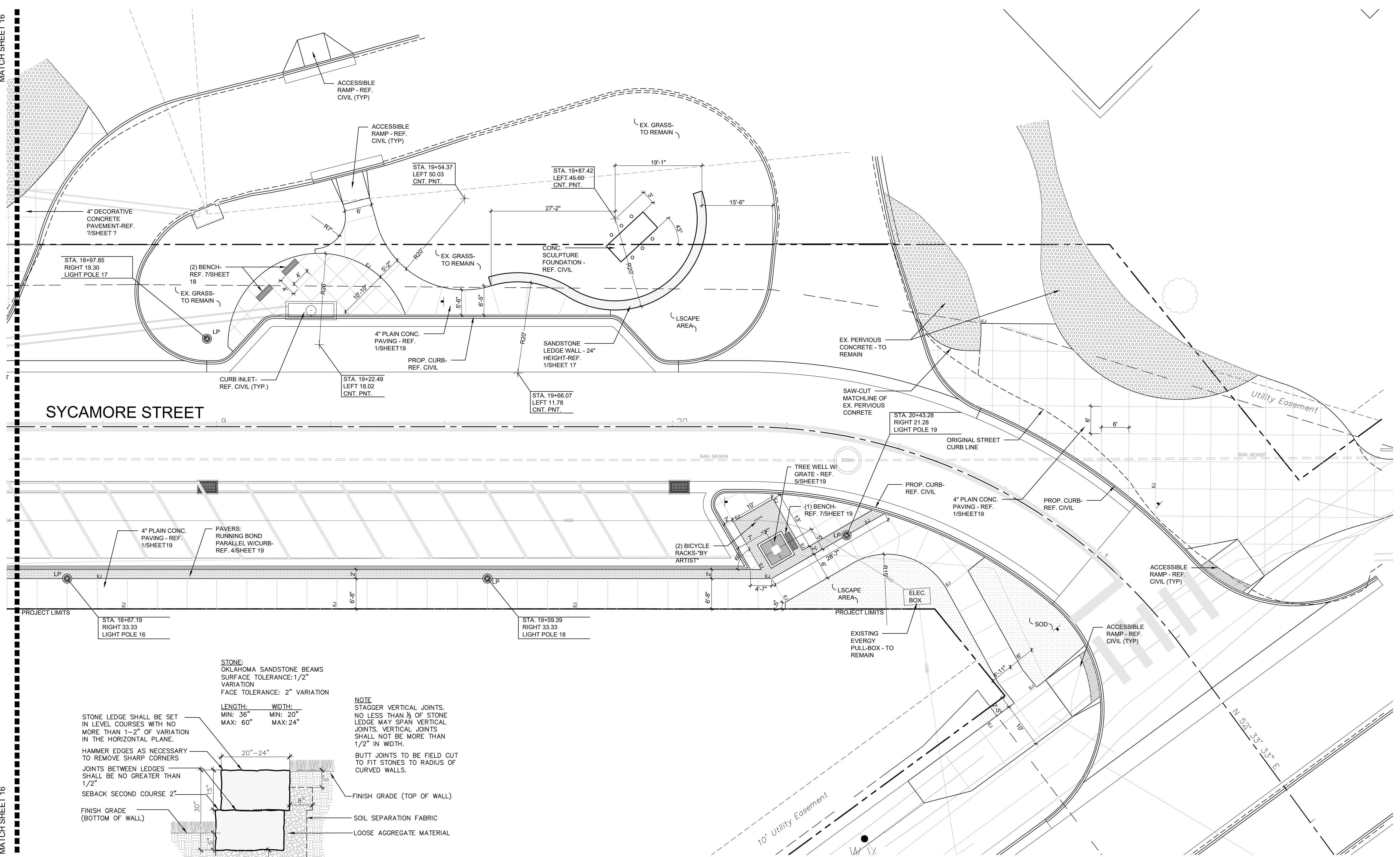

STONE:
OKLAHOMA SANDSTONE BEAMS
SURFACE TOLERANCE: 1/2"
VARIATION
FACE TOLERANCE: 2" VARIATION

LENGTH: WIDTH:
MIN: 36" MIN: 20"
MAX: 60" MAX: 24"

STONE LEDGE SHALL BE SET
IN LEVEL COURSES WITH NO
MORE THAN 1-2" OF VARIATION
IN THE HORIZONTAL PLANE.

HAMMER EDGES AS NECESSARY
TO REMOVE SHARP CORNERS
JOINTS BETWEEN LEDGES
SHALL BE NO GREATER THAN
1/2"

SEBACK SECOND COURSE 2"
FINISH GRADE
(BOTTOM OF WALL)

FINISH GRADE
(TOP OF WALL)

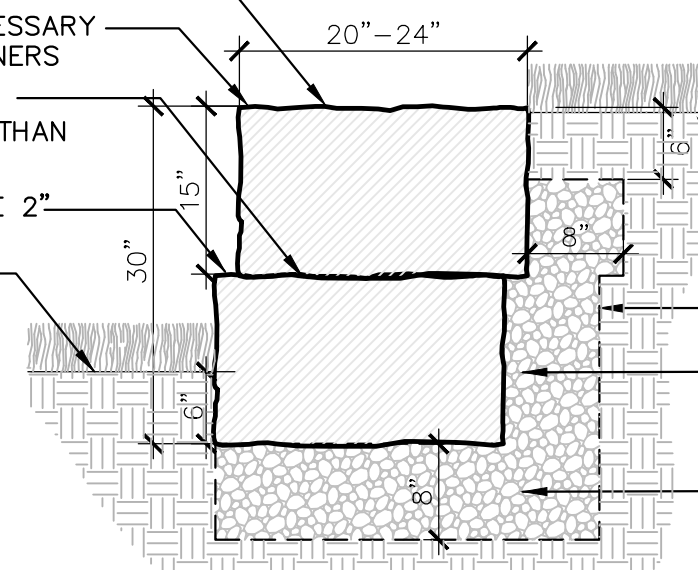

NOTE
STAGGER VERTICAL JOINTS.
NO LESS THAN 1/8 OF STONE
LEDGE MAY SPAN VERTICAL
JOINTS. VERTICAL JOINTS
SHALL NOT BE MORE THAN
1/2" IN WIDTH.
BUTT JOINTS TO BE FIELD CUT
TO FIT STONES TO RADIUS OF
CURVED WALLS.

1 SANDSTONE LEDGE WALL SECTION

3/4" = 1'-0"

Tran Systems
245 NORTH WACO
SUITE 222
WICHITA, KANSAS 67202
PHONE: 316-303-3000
FAX: 316-462-5629

CONSULTANTS:
LK ARCHITECTURE, INC.
345 RIVERVIEW
SUITE 200
WICHITA, KANSAS 67208
PHONE: 316-268-0230

SYCAMORE STREET IMPROVEMENTS
WICHITA, KANSAS
CITY OF WICHITA

REVISIONS:	DESCRIPTION	DATE	MARK

PROJ NO: 472-85284
SCALE: 1" = 10'-0"
DATE: 05/29/2020
DESIGNED BY: J. Best
DRAWN BY: J. Best
CHECKED BY: J. Best

SHEET TITLE:
HARDSCAPE PLAN

SHEET NO.
17
SHEET 17 OF 97

A HARDSCAPE PLAN

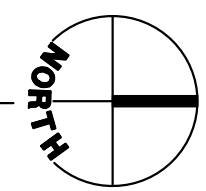
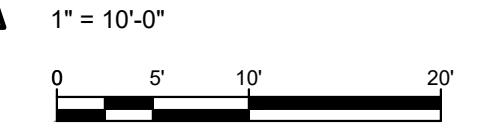

IF THIS DRAWING IS LESS THAN 22" X 36" IT IS A REDUCED SIZE DRAWING