

LEGEND

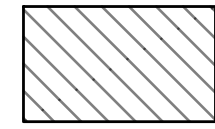

PHASE I

PHASE I

Phase I construction shall construct the Sycamore Street Improvements between Douglas Avenue and McLean Boulevard. Sycamore Street shall be a full closure during construction. During construction, the Advanced Learning Library shall remain open to the public at all times and their main access will be off of 2nd Street. During the time of construction the Contractor shall erect a temporary construction fence to prevent the general public from entering the construction site from the library entrance/exit. During construction the Contractor shall be in close communication with the adjacent Developers and Contractors as to phase in construction to minimize impact to all construction participants and the completion of the front of their buildings. Major items of work include but is not limited to concrete pavement, storm sewer, water line installation, curb & gutter, sidewalk, entrances, streetscape, pavement markign and signing, grading, and sodding.

SITE DEVELOPMENT CONTACTS

HUTTON	EPC APARTMENT SITE	IGC HOTEL SITE
<p><i>Project Manager:</i> Hunter White Hutton Construction (316) 942-8855</p> <p><i>Superintendent:</i> Derek Pyeatt Hutton Construction (316) 207-1493</p>	<p><i>Project Manager:</i> Nick Penner Crossland Construction (316) 680-8514</p> <p><i>Superintendent:</i> Wayne McGrane Crossland Construction (316) 218-2868</p>	<p><i>Chris Hopping</i> TGC Group (316) 364-1127</p>

GENERAL NOTES

- The construction phasing indicates major items of work and a general sequence of construction. It does not include all items of work. Certain situations may arise which preclude adhering to the original Construction Phasing. Should this occur, the Contractor may submit to the Engineer an alternate plan for approval.
- All traffic control shall conform to the latest edition of the Manual of Uniform Traffic Control Devices (MUTCD).
- Speed limit in the work zones shall remain the same prior to construction unless otherwise noted on the plans or at the discretion of the Engineer.
- All existing signs in conflict with the traffic control or the final lane configuration shall be covered or removed and either reset or stored on site for retrieval by the Owner as directed by the Engineer. Existing signs necessary for traffic during construction shall be adjusted (and later reset), as necessary, as directed by the Engineer.
- Pavement markings conflicting with the traffic control shall be either removed or covered with an approved removable tape during construction. Temporary pavement markings shall be Type I Temporary Pavement Marking Tape. The Contractor shall maintain all temporary pavement markings throughout their intended service life.
- As work is complete, the Contractor shall install permanent signing and pavement markings as in the pavement marking and signing plans or as directed by the Engineer.
- The roadway Contractor is not responsible for any traffic control needed for the greenway construction. The greenway construction is a separate contract that will be constructed by EPC's general Contractor, Crossland Construction. All labor and materials needed to sign and maintain traffic control for the greenway construction shall be the responsibility of Crossland Construction.
- The Contractor shall close sideroads as needed to complete the work necessary through the intersection. All sideroad closures shall be approved by the Engineer prior to the closure. No two consecutive sideroads shall be closed at the same time.
- The Contractor will be required to provide access to property owners or occupants during construction. The Contractor shall provide seven (7) days notice to property owners and occupants before beginning improvements in the vicinity of their property.
- The Contractor shall only close drives/entrances to businesses and residences during the time improvements are being made in the vicinity of the property.
- The Contractor shall work with adjacent businesses and residents to maintain access as long as possible in advance of the work area and restore access as soon as possible after the construction is completed in the area.
- The Contractor shall notify all property owners or business owners of any significant traffic changes during construction a minimum of seven (7) days in advance of traffic changing.
- All improvements from the south end to station 17+19.18 shall be constructed first.

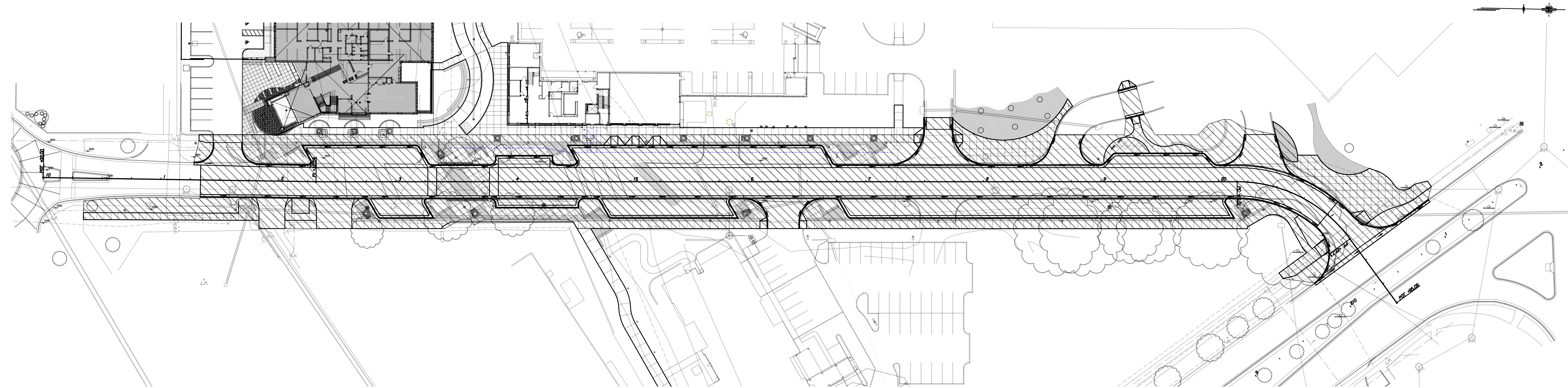

Tran Systems
 245 NORTH WACO
 SUITE 222
 WICHITA, KANSAS 67202
 PHONE: 316-303-3000
 FAX: 316-462-5629

CONSULTANTS:

 LK ARCHITECTURE, INC.
 345 RIVERVIEW
 SUITE 200
 WICHITA, KANSAS 67208
 PHONE: 316-268-0230

SYCAMORE STREET IMPROVEMENTS
 WICHITA, KANSAS

REVISIONS:	MARK	DATE	DESCRIPTION

PROJ NO: 472-85463
 SCALE: 1"=50'
 DATE: 6/1/2020
 DESIGNED BY: TAU
 DRAWN BY: TAU
 CHECKED BY: MDB

SHEET TITLE:
CONSTRUCTION PHASING OVERVIEW

SHEET NO.
62
 SHEET 62 OF 97