

**BENCHMARKS:**

BM #1: "□" South end of Womer St. median approximately 565' south of 37th St. N.  
Elev. = 1324.11 NAVD88

BM #2: "□" Top of curb inlet, west side of Womer St. approximately 1,400' south of 37th St. N.  
Elev. = 1325.82 NAVD88

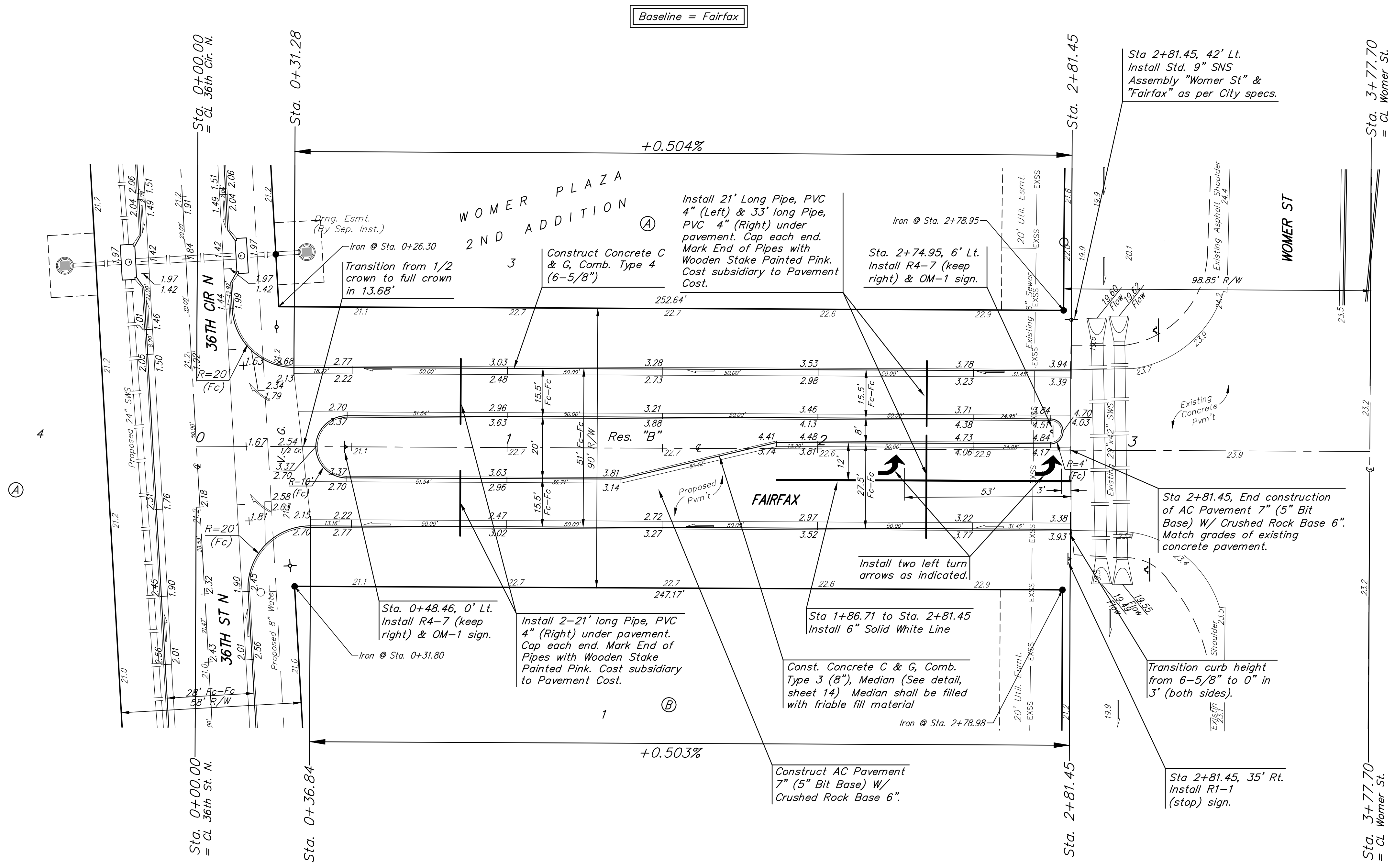
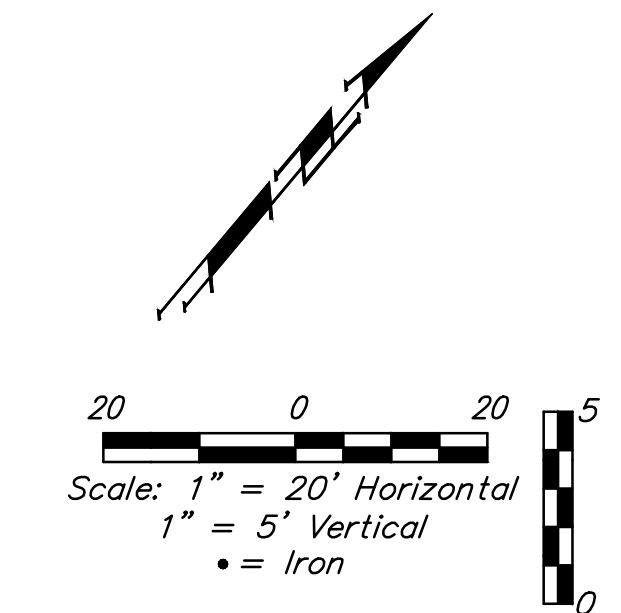

**Baughman Company, P.A.**  
115 E. WILSON ST. #111, FAYETTEVILLE, NC 28404  
ENGINEERING | SURVEYING | PLANNING | LANDSCAPE ARCHITECTURE  
Dillon | Senior | Designer | Drafter | Surveyor | Estimator | Director  
Dillon | Senior | Designer | Drafter | Surveyor | Estimator | Director  
Dillon | Senior | Designer | Drafter | Surveyor | Estimator | Director  
Dillon | Senior | Designer | Drafter | Surveyor | Estimator | Director

WOMER PLAZA 2ND ADD.  
**FAIRFAX**  
STREET IMPROVEMENTS