

3 Chemical Exhaust Fan Detail
Scale: Not to Scale

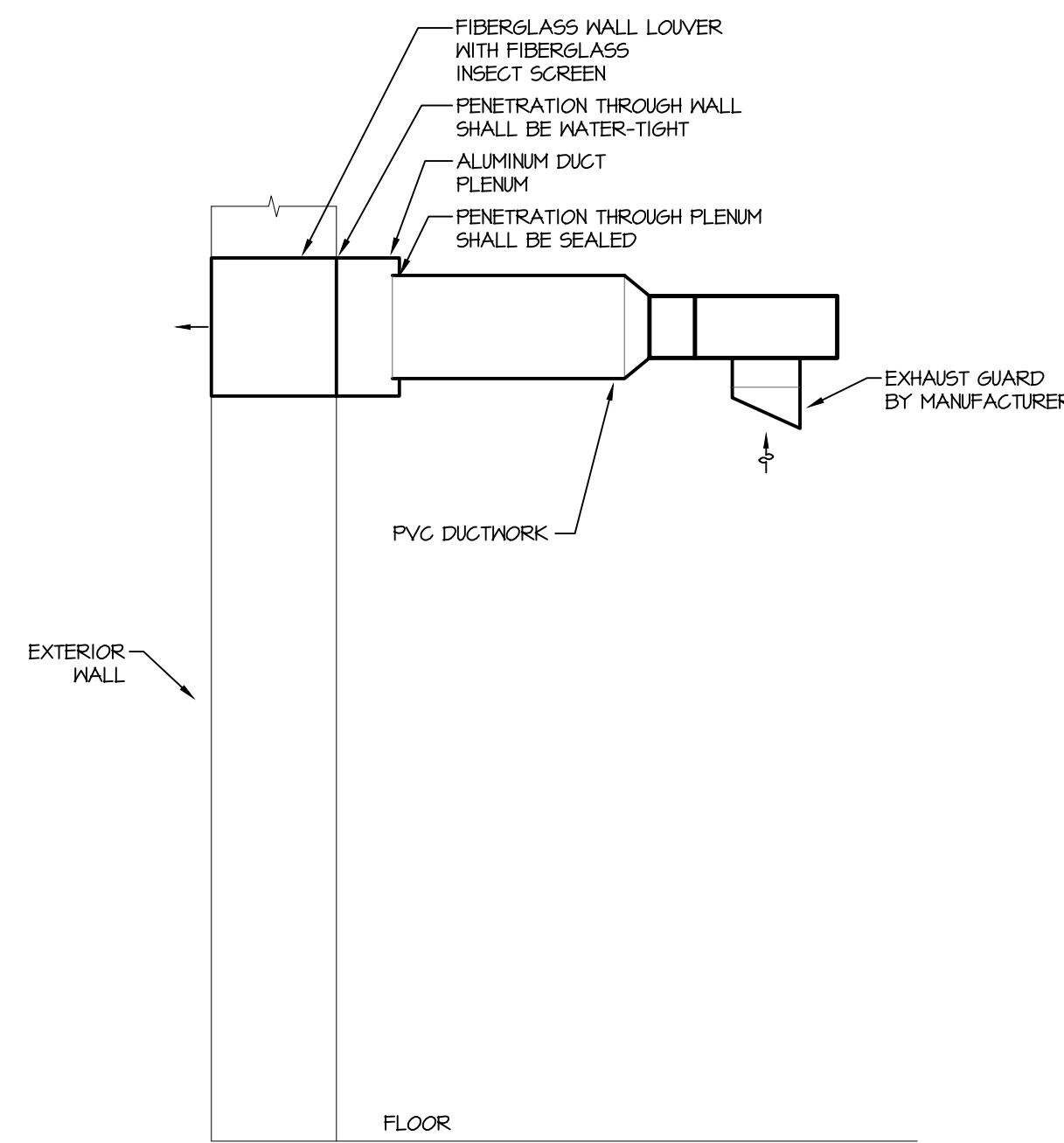

2 Filter Exhaust Fan Detail
Scale: Not to Scale

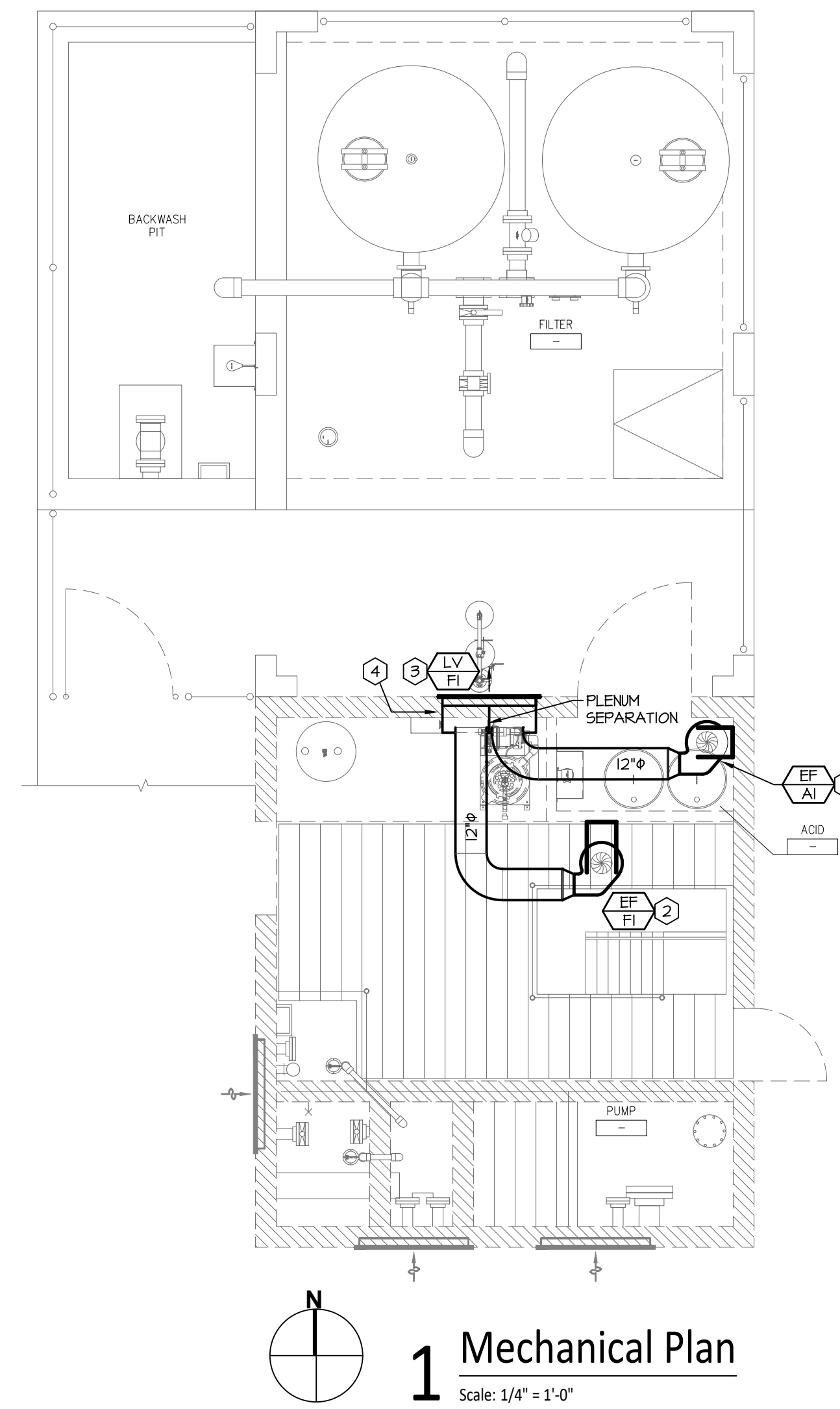

1 Mechanical Plan
Scale: 1/4" = 1'-0"

GENERAL NOTES:

- A. THESE DRAWINGS ARE DIAGRAMMATIC AND INDICATE THE GENERAL EXTENT OF THE WORK. PROVIDE SHEET METAL SYSTEMS COMPLETE AND PER APPLICABLE CODES INCLUDING ALL NECESSARY OFFSETS, FITTINGS AND SPECIAL RADIUS OR MITRED ELBOWS WHICH ARE REQUIRED DUE TO SPACE CONSTRAINTS OR OTHER CONDITIONS.
- B. COORDINATE THE INSTALLATION OF THE DUCTWORK AND EQUIPMENT WITH THE WORK OF ALL OTHER TRADES. VERIFY ALL CLEARANCES PRIOR TO THE FABRICATION OF ANY SYSTEM COMPONENTS.
- C. DUCTWORK SHALL NOT BE LOCATED OVER ELECTRICAL EQUIPMENT OR PANELS. PROVIDE THE CODE REQUIRED WORKING CLEARANCE AROUND ALL ELECTRICAL EQUIPMENT AND PANELS.
- D. PROVIDE ALL MISCELLANEOUS SUPPORTING STEEL, ETC. FOR THE PROPER INSTALLATION OF ALL MECHANICAL SYSTEMS.
- E. COORDINATE FLOOR, WALL, ROOF PENETRATIONS, LOUVER SIZES, PAD LOCATIONS, ETC. WITH THE ARCHITECTURAL TRADES.
- F. REFER TO ARCHITECTURAL REFLECTED CEILING PLANS AND WALL ELEVATIONS FOR EXACT LOCATION OF GRILLES, REGISTERS, AND DIFFUSERS.
- G. ALL DUCTWORK DIMENSIONS INDICATE THE INSIDE CLEAR DIMENSION.

PLAN NOTES:

1. PROVIDE CENTRIFUGAL FAN AS SCHEDULED MOUNTED HIGH IN CHEMICAL ROOM. CENTERLINE OF FAN OUTLET SHALL BE AT APPROXIMATELY THE SAME HEIGHT AS THE CENTERLINE OF THE ASSOCIATED LOUVER. PROVIDE 12" PVC PIPE DOWN TO 12" AFF. JOG DUCTWORK TO BE TIGHT AGAINST WALLS IN THE CORNER TO ALLOW FOR REMOVAL OF CHEMICAL CONTAINERS WHEN REQUIRED. DISCHARGE DUCTWORK SHALL HAVE FLEXIBLE CONNECTION. PROVIDE 12" PVC PIPE AND ROUTE TO DUCT PLENUM. COORDINATE EXACT LOCATION WITH ARCHITECTURAL ELEVATIONS.
2. PROVIDE CENTRIFUGAL FAN AS SCHEDULED MOUNTED HIGH IN PUMP ROOM. CENTERLINE OF FAN OUTLET SHALL BE AT APPROXIMATELY THE SAME HEIGHT AS THE CENTERLINE OF THE ASSOCIATED LOUVER. DISCHARGE DUCTWORK SHALL HAVE FLEXIBLE CONNECTION. PROVIDE 12" PVC PIPE AND ROUTE TO DUCT PLENUM. COORDINATE EXACT LOCATION WITH ARCHITECTURAL ELEVATIONS.
3. PROVIDE LOUVER AS SCHEDULED TO REPLACE EXISTING LOUVER. REFER TO ARCHITECTURAL PLANS FOR SPECIFIC LOUVER LOCATION. CONTRACTOR SHALL FIELD VERIFY DIMENSIONS OF EXISTING LOUVER PRIOR TO ORDERING.
4. PROVIDE DUCT PLENUM ON BACK OF LOUVER. EXHAUST DUCT PENETRATIONS INTO DUCT PLENUM SHALL BE SEALED TIGHT. ALUMINUM PLENUM INTERIOR SHALL BE SPRAYED WITH EPOXY FINISH, GRAY.

EXHAUST FAN SCHEDULE

MARK	MANUFACTURER	MODEL	CFM	S.P.	DRIVE	RPM	WATTS	HP	V/PH	NOTES
EF-AI	FANAM	CBI-200	650	0.5	DIRECT	1125	-	1/4	120/1	1,3
EF-FI	FANAM	CBI-200	550	0.75	DIRECT	1125	-	1/4	120/1	1,2,3

- NOTES:**
1. FAN HOUSING AND WHEEL SHALL BE CONSTRUCTED OF POLYPROPYLENE.
 2. PROVIDE FAN WITH MANUFACTURER'S INLET GUARD.
 3. PROVIDE FAN WITH MANUFACTURER'S DISCONNECT SWITCH.

LOUVER SCHEDULE

MARK	MANUFACTURER	MODEL	SERVICE	SIZE W x H (IN.)	AIRFLOW CFM	MIN. FREE AREA (S.F.)	MAX. PD INCHES WC	NOTES
LV-FI	RUSKIN	SF640	EXHAUST	42x16	1200	2.02	0.05	1

- PLAN NOTES:**
1. PROVIDE FIBERGLASS LOUVER WITH FIBERGLASS INSECT SCREEN.

- GENERAL NOTES:**
- A. PROVIDE MOUNTING FRAME TO MATCH CONSTRUCTION.
 - B. CUSTOM COLOR TO BE SELECTED BY ARCHITECT DURING THE SUBMITTAL PROCESS.
 - C. PROVIDE ALL FASTENERS, HANGERS, AND ASSOCIATED DEVICES REQUIRED FOR COMPLETE INSTALLATION.



WICHITA, KANSAS
Pool Improvements
HARVEST PARK



CASEY JOHN STEINER
LICENSE #19423

Date: 8-14-20 Job #: 1820529

Drawn: CDW Checked: MST

Issue: CONSTRUCTION DOCUMENTS

MECHANICAL PLAN,
DETAILS &
SCHEDULES

SP-M1