

BENCHMARKS:

BM #1: "□" on top of curb near the NW corner of Lot 27, Block E, Firefly Way Addition. Elev. = 1398.85 NAVD88

BM #2: "□" on top of curb near the SW corner of Lot 54, Block D, Firefly Way Addition. Elev. = 1398.61 NAVD88

BM #3: "□" on top of curb near the NW corner of Lot 6, Block D, Firefly Way Addition. Elev. = 1400.77 NAVD88

WATER VALVE LOCATION TABLE

VALVE NUMBER	STREET	BASILINE STATION	OFFSET DISTANCE	OFFSET DIRECTION
V1	Woodspring	1+77.87	26'	Rt.
V2	Woodspring	2+02.87	26'	Rt.
V3	Woodspring	4+17.60	26'	Rt.

Baseline = CL Woodspring

Paving contractor will be responsible to operate all water valves on the project, in the presence of the inspector, to ensure accessibility to the valves, and that all valves (except blowoffs) are left in the "ON" position when the project is completed.

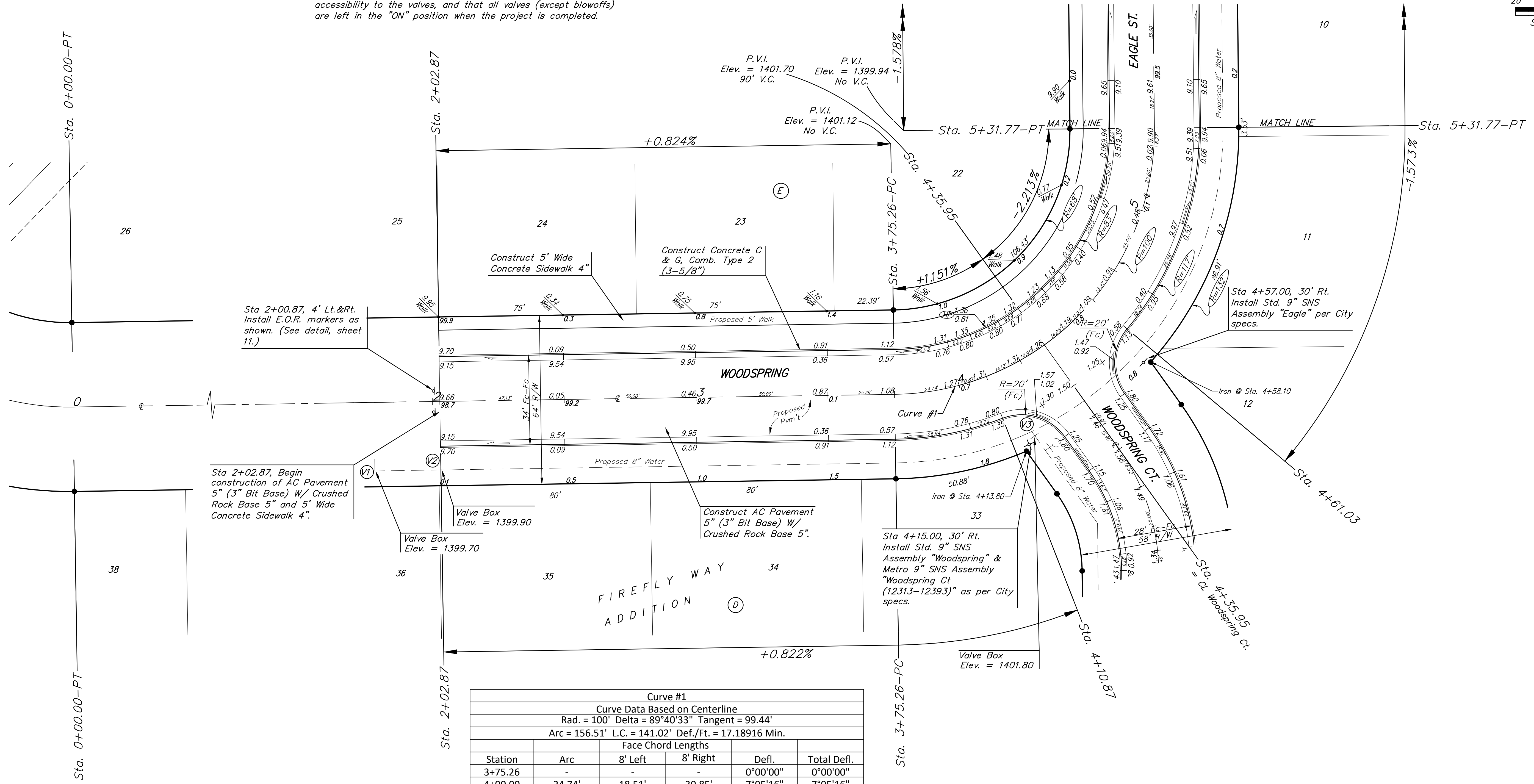
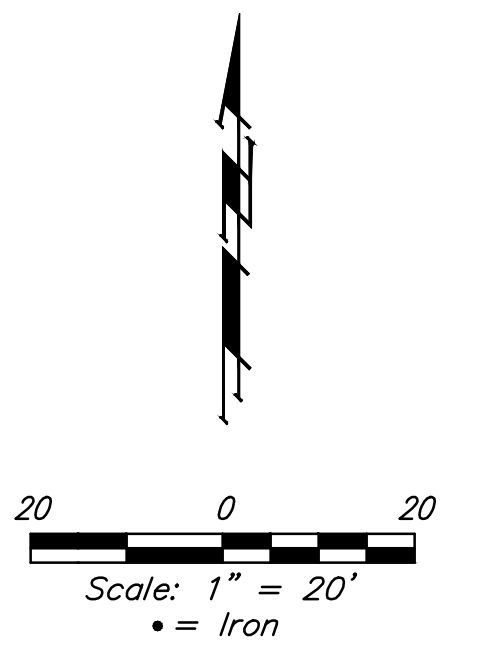

Curve #1					
Curve Data Based on Centerline					
Rad. = 100' Delta = 89°40'33" Tangent = 99.44'					
Arc = 156.51' L.C. = 141.02' Def./Ft. = 17.18916 Min.					
Face Chord Lengths					
Station	Arc	8' Left	8' Right	Defl.	Total Defl.
3+75.26	-	-	-	0°00'00"	0°00'00"
4+00.00	24.74'	18.51'	30.85'	7°05'16"	7°05'16"
4+10.87	10.87'	8.15'	13.58'	3°06'50"	10°12'06"
4+25.00	14.13'	10.59'	17.65'	4°02'53"	14°14'59"
4+35.95	10.95'	8.21'	13.68'	3°08'14"	17°23'13"
4+50.00	14.05'	10.53'	17.55'	4°01'30"	21°24'43"
4+61.03	11.03'	8.27'	13.78'	3°09'36"	24°34'19"
4+75.00	13.97'	10.47'	17.45'	4°00'08"	28°34'27"
5+00.00	25.00'	18.70'	31.17'	7°09'44"	35°44'11"
5+25.00	25.00'	18.70'	31.17'	7°09'43"	42°53'54"
5+31.77	6.77'	5.08'	8.46'	1°56'22"	44°50'16"

NOTE: ROLL TYPE CURB & GUTTER (TYPE 2) TO BE CONSTRUCTED ON THE PAVEMENT SHOWN ON THIS SHEET. TOP OF CURB ELEVATIONS ARE GIVEN FOR FULL HEIGHT CURB (TYPE 4).