

FIRST COURSE SECOND COURSE

**CORNER DETAIL A**

90 DEGREE OUTSIDE CORNER  
SCALE: NONE

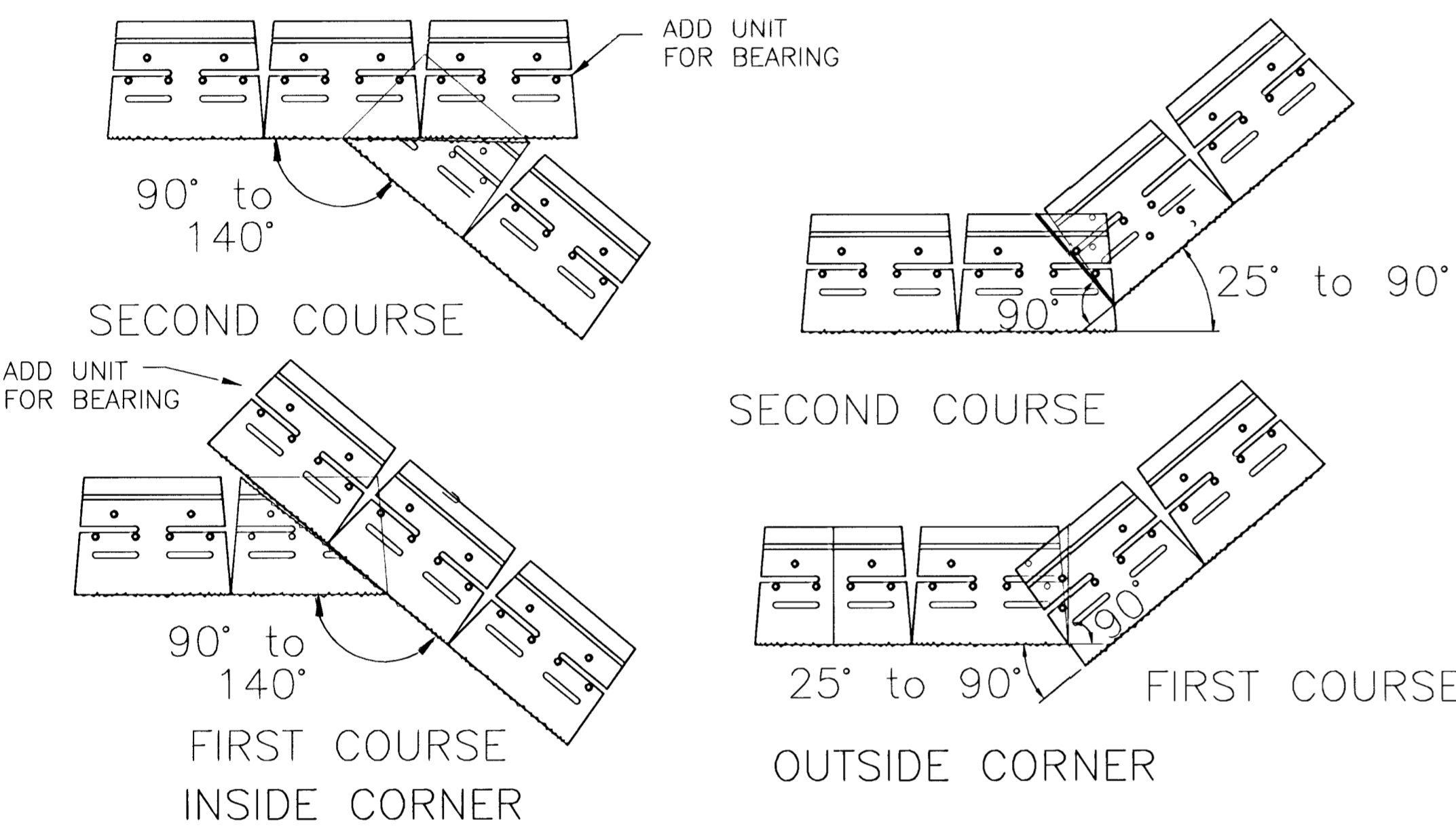

**CORNER DETAIL B**

OBLIQUE ANGLE CORNERS  
SCALE: NONE

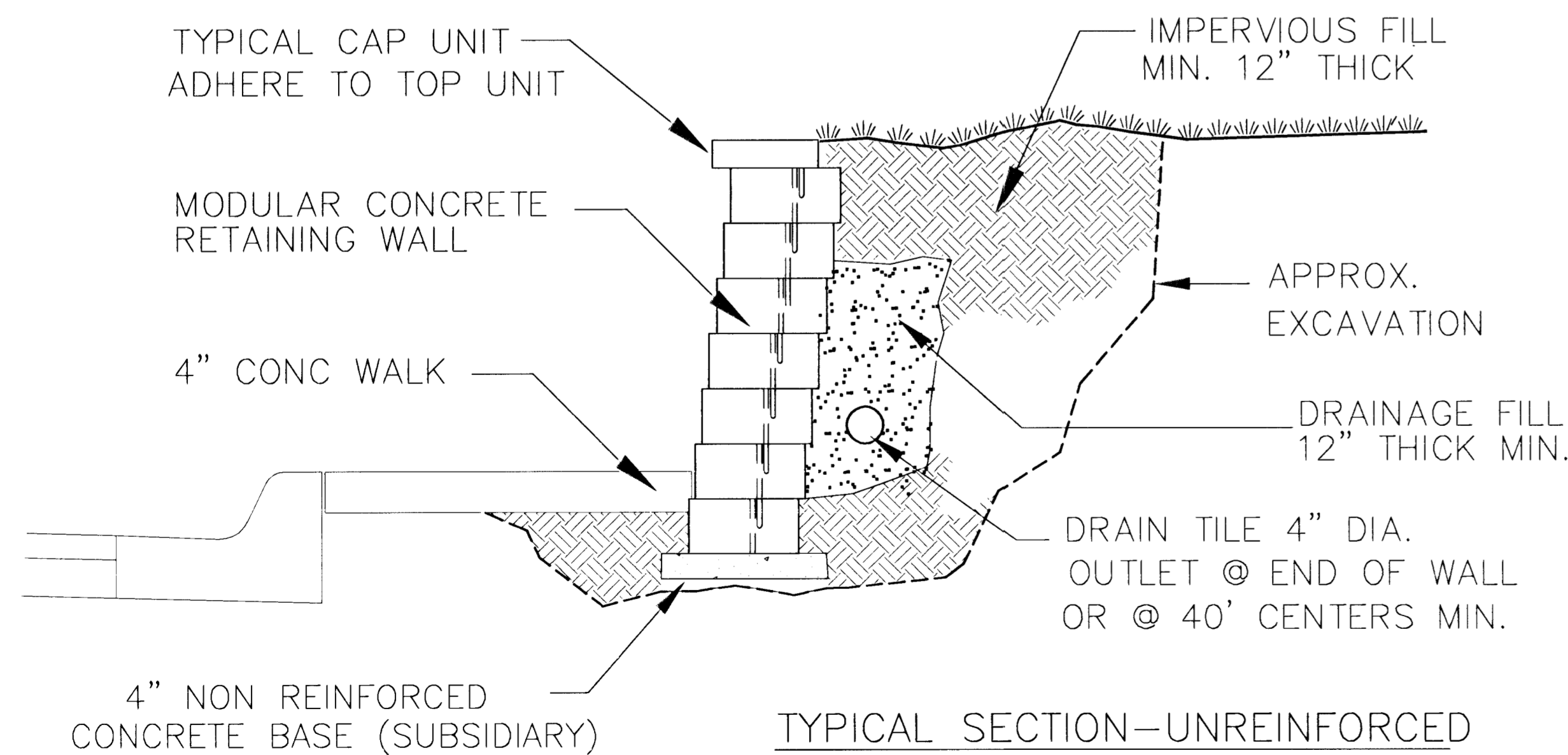

**TYPICAL SECTION—UNREINFORCED**

MODULAR CONCRETE  
RETAINING WALL

SCALE: NONE

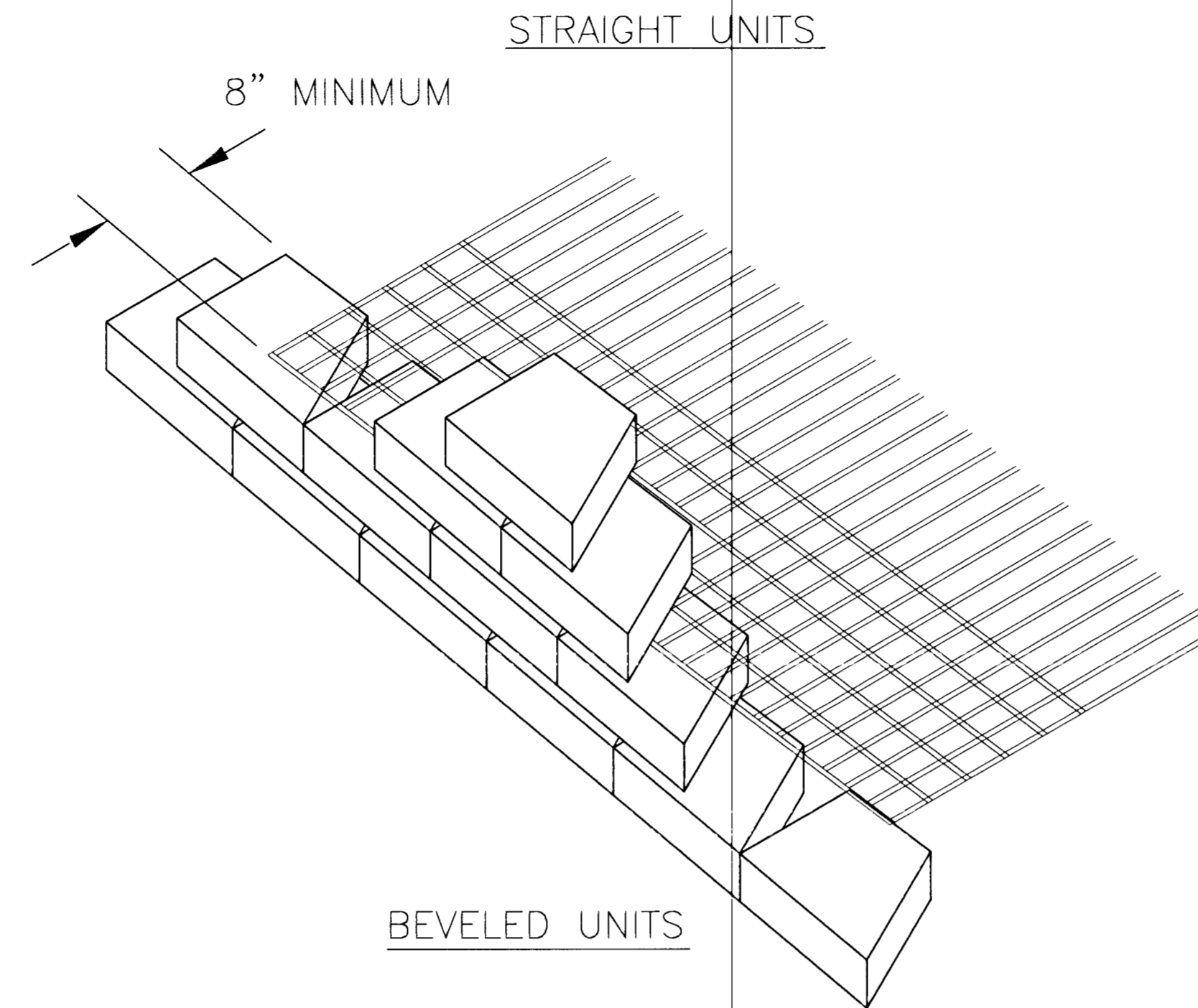

**STRAIGHT UNITS**

8" MINIMUM

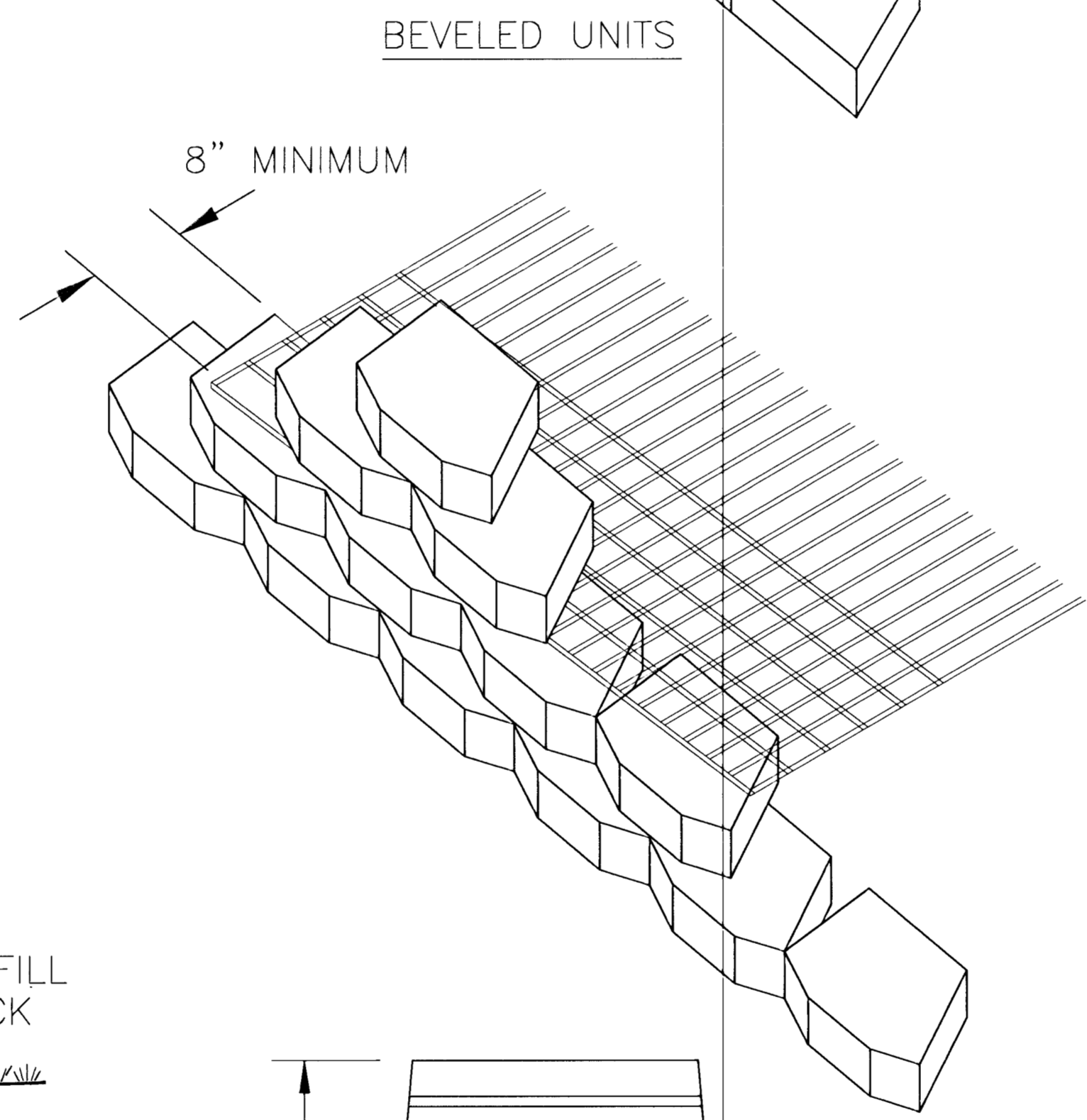

**BEVELED UNITS**

8" MINIMUM

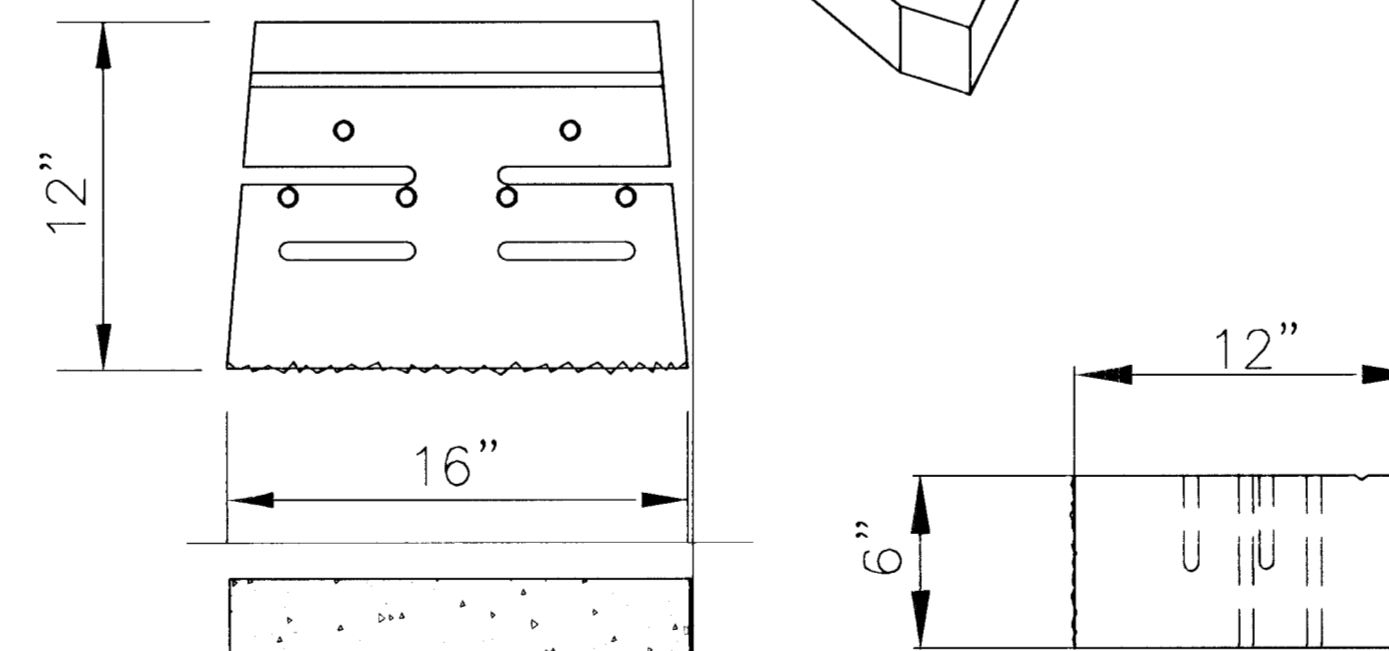

**TYPICAL UNIT**

UNIT DIMENSIONS  
SCALE: NONE

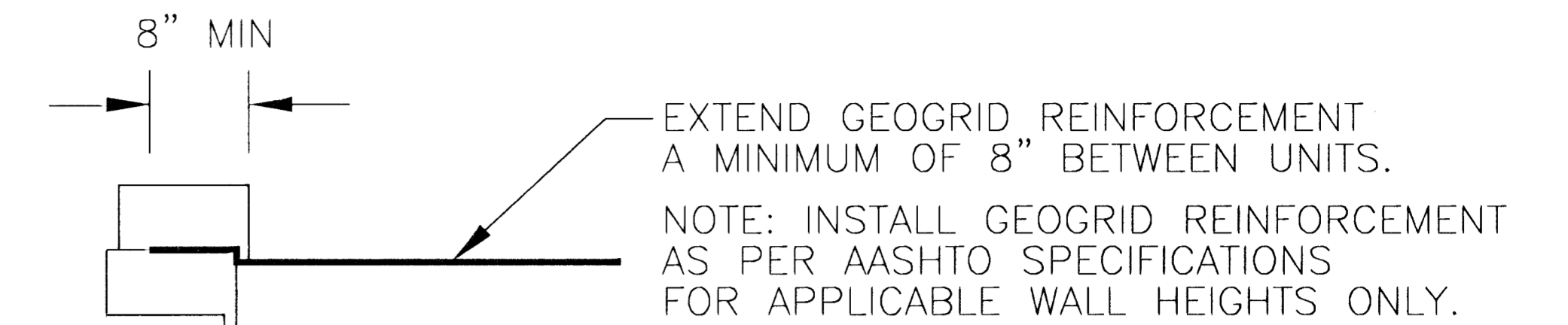

**CONNECTION DETAIL**

SCALE: NONE

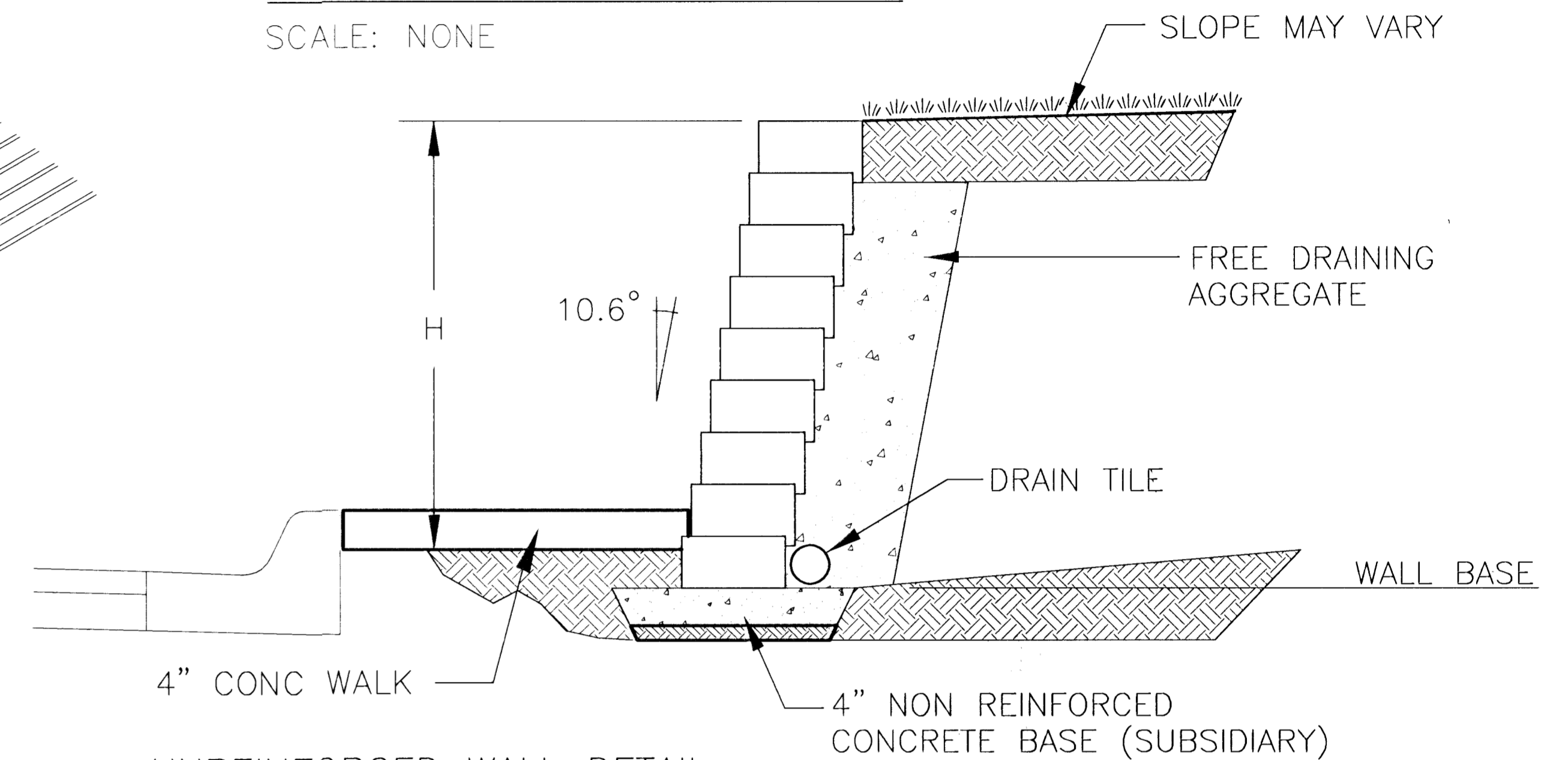

**UNREINFORCED WALL DETAIL**

SCALE: NONE

**GENERAL NOTES**

1. STRIP ALL VEGETATION AND ORGANIC SOIL FROM THE WALL AND GRID ALIGNMENT.
2. BENCH CUT ALL EXCAVATED SLOPES.
3. DO NOT OVER EXCAVATE UNLESS DIRECTED BY SITE SOIL ENGINEER TO REMOVE UNSUITABLE SOIL.
4. SITE SOIL ENGINEER SHALL VERIFY FOUNDATION SOILS AS BEING COMPETENT PER THE DESIGN STANDARDS AND PARAMETERS.
5. BASE SHALL CONSIST OF NON-REINFORCED CONCRETE MINIMUM 4" THICK.
6. CAPSTONE AND TOPCOURSE SHALL BE GLUED USING WEATHER PROOF CONSTRUCTION ADHESIVE, LIQUID NAILS OR APPROVED OTHER.
7. MINIMUM EMBEDMENT OF WALL BELOW FINISH GRADE SHALL BE 12" FOR WALL HEIGHTS FROM 4' AND UP, 6" BELOW 4' UNLESS SHOWN DIFFERENTLY.
8. FOLLOW APPLICABLE PROVISIONS OF THE MANUFACTURERS INSTALLATION INSTRUCTIONS AND AASHTO SPECIFICATIONS.
9. DRAINAGE FILL 12" THICK SHALL BE INSTALLED BEHIND THE WALL TO WITHIN 18" OF THE TOP OF THE WALL.
10. WHERE DRAIN TILE IS USED PROVIDE OUTLETS @ MIN. 40' CC.
11. BACKFILL AND COMPACT IN FRONT OF THE WALL AS WALL IS INSTALLED.
12. COMPACTION TESTS SHALL BE TAKEN AS THE WALL IS INSTALLED. THE MINIMUM NUMBER OF TESTS SHALL BE DETERMINED BY THE SITE SOILS ENGINEER.
13. COMPACTION SHALL BE TO 95% OF MAXIMUM STANDARD PROCTOR DENSITY.
14. SEE ELEVATION FOR GEOGRID TYPE, LENGTH AND LOCATION IF REQUIRED.
15. GEOGRID SHALL BE THE TYPE AND LENGTH AS SHOWN. PULL GEOGRID TIGHT PRIOR TO BACKFILLING.
16. PROVIDE LATERAL DRAINAGE SWALES TO DIRECT FLOWS AROUND THE ENDS OF THE WALL.
17. ESTABLISH TURF AS SOON AS THE WALL IS COMPLETED.
18. FINAL WALL ALIGNMENT SHALL BE LOCATED IN THE FIELD.

IF DIFFERENT CONDITIONS EXIST, THE CONTRACTOR MUST CONTACT THE FIELD ENGINEER PRIOR TO CONSTRUCTION OF THE RETAINING WALL.

PROJECT NUMBER 472-76-245-83324		SHEET NAME RetwallDetail		ENGINEERING DIRECTORY F:\Eng\Hydraulic\Details	
DESIGN JFB	DRAWN STAFF	APPROVED JFB	DATE Sept. 2002	SCALE Noted	BAUGHMAN NO 99-09-E450

CAPITAL IMPROVEMENT PROJECT  
**RETAINING WALL DETAILS**  
HYDRAULIC AVENUE PAVING - 47TH STREET SOUTH TO MACARTHUR ROAD

**BAUGHMAN COMPANY, P.A.**  
ENGINEERING, SURVEYING, & PLANNING  
316-262-7271 • 315 ELLIS • WICHITA, KANSAS 67211