

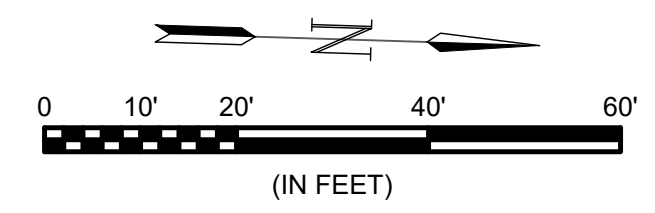

© 2020 GARVER, LLC
 THIS DOCUMENT, ALONG WITH THE IDEAS AND DESIGNS CONVEYED HEREIN, SHALL BE CONSIDERED INSTRUMENTS OF PROFESSIONAL SERVICE AND ARE PROPERTY OF GARVER, LLC. ANY USE, REPRODUCTION, OR DISTRIBUTION OF THIS DOCUMENT, ALONG WITH THE IDEAS AND DESIGNS CONTAINED HEREIN, IS PROHIBITED UNLESS AUTHORIZED IN WRITING BY GARVER, LLC OR EXPLICITLY ALLOWED IN THE GOVERNING PROFESSIONAL SERVICES AGREEMENT FOR THIS WORK.

8535 E. 21st St. N.
 Suite 130
 Wichita, KS 67206
 (316) 264-8008



▲ THESE ELEVATIONS ARE TOP AND FLOWLINE OF 3" ROLL CURB.

■ THESE ELEVATIONS ARE TOP AND FLOWLINE OF 8" MEDIAN CURB. (INNER CURB ONLY)

THE REMAINDER OF GRADES ON THIS AND OTHER SHEETS ARE FULL HEIGHT 6" (0.55') CURB GRADES. ROLL CURB 3" (0.30') SHALL BE CONSTRUCTED ON THIS PROJECT EXCEPT IN CIRCULAR ROUND-A-BOUT AS NOTED.

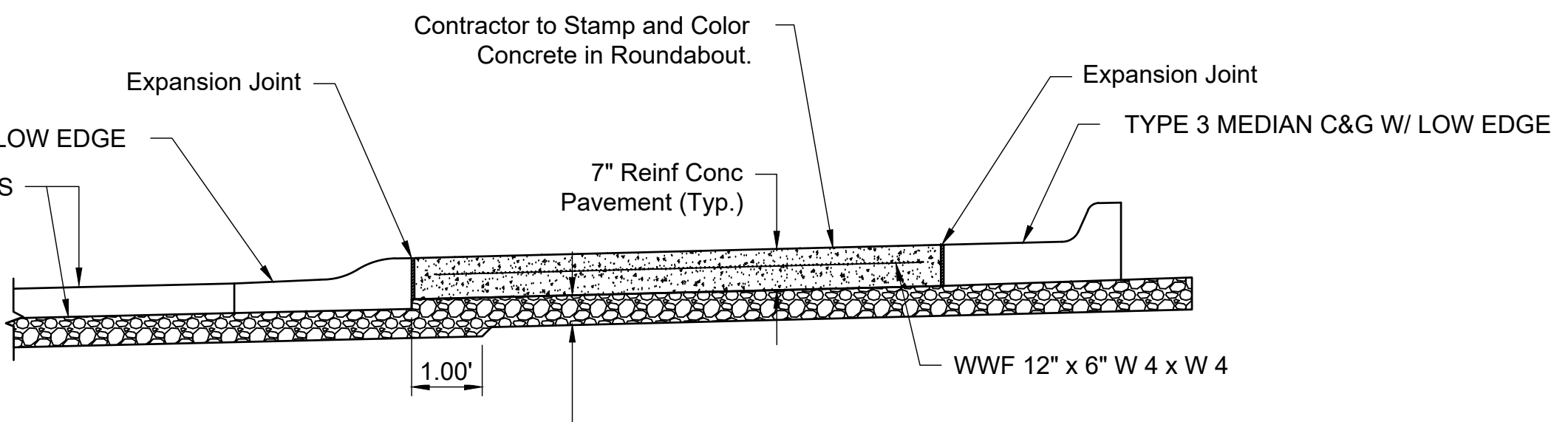
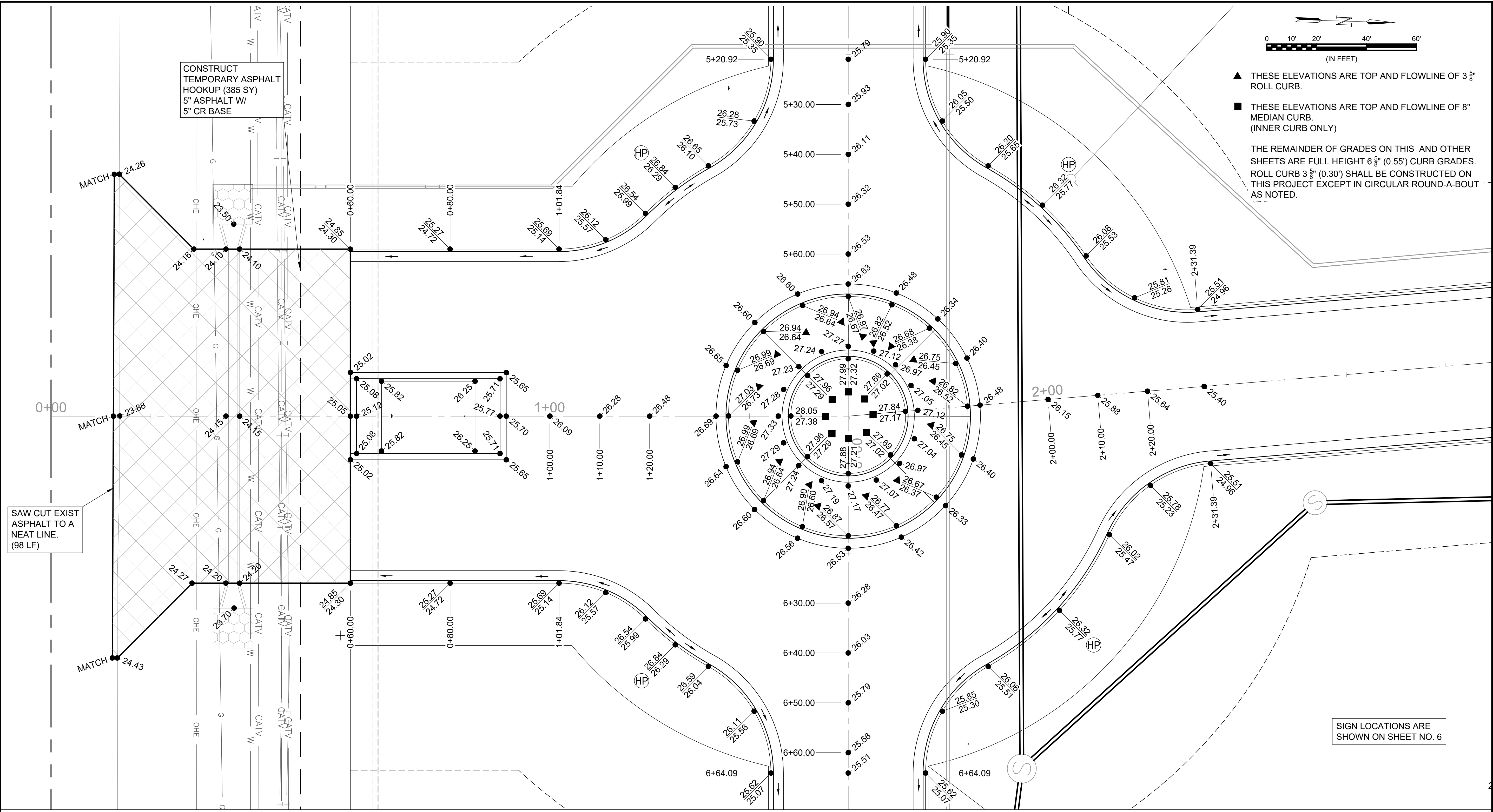

Stamped & Colored Concrete
 Color: Rustic Brown w/ Dark Gray color release
 Pattern: English Yorkstone from Scofield Systems (or approved equal)
 Contractor shall apply sealer and water repellent to stamped concrete.
 Decra-Seal Natural Water Based Enhance and WR Meadows Water Repellent (or approved equals)

SIGN LOCATIONS ARE SHOWN ON SHEET NO. 6

REV.	DATE	DESCRIPTION	BY



CITY OF WICHITA
 WICHITA, KANSAS
 EMERALD BAY 4th ADD.
 PHASE 2 - PAVING

EMMALYN ENTRANCE

JOB NO.: 19T41016
 DATE: SEPT. 2020
 DESIGNED BY: .
 DRAWN BY: .

BAR IS ONE INCH ON ORIGINAL DRAWING
 0 IF NOT ONE INCH ON THIS SHEET, ADJUST SCALES ACCORDINGLY.

DRAWING NUMBER

SHEET NUMBER **5** OF **21**

File: L:\2019\19T41016 - Emerald Bay 4th PH 2\Drawings\C3D\Paving Sheets\EMMALYN ENTRANCE.dwg, Last Save: 12/1/2020 9:14 AM, Last saved by: E.Glover
 Last plotted by: Glover, Eric J., Plot Style: ---, Plot Scale: 1:2.5649, Plot Date: 12/1/2020 1:16 PM, Plotter used: None