

PLOTTED: Thursday, February 11, 2021 @ 03:09PM

J:\PROJECTS\2019\1901010483\_COW\_RCB\_TYLER AND HARRY\_190483\_CADD\SHOTS\06 CIVIL\GRD\190483-05-8900.DWG

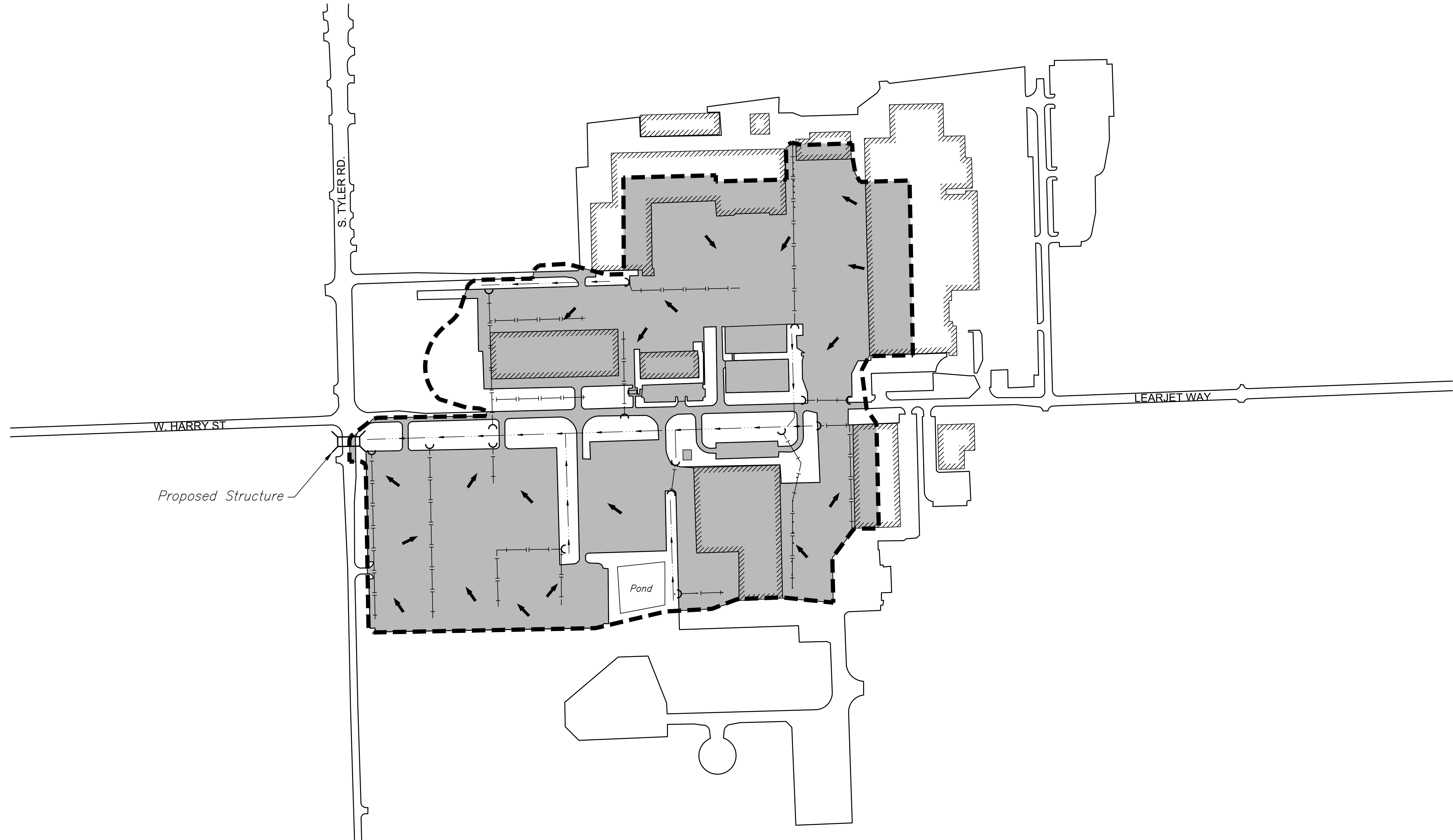

Total Area = 64.0 acres

Impervious Area = 51.3 acres (80%)

**LEGEND**

- = Drainage System Boundary
- = Direction of Flow
- = Existing Storm Sewer
- = Existing Ditch
- = Buildings
- = Impervious Area

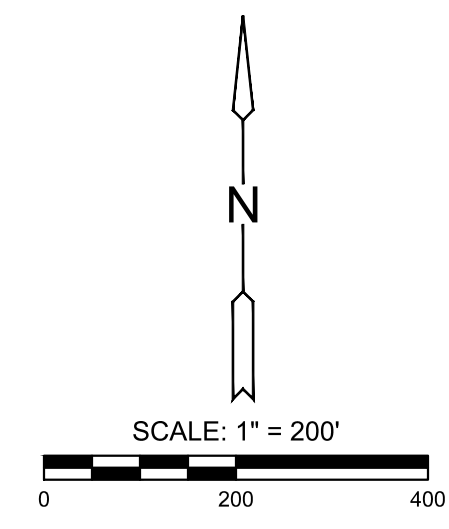

PLANS FOR  
**RCB REPLACEMENT-TYLER & HARRY**  
CITY OF WICHITA, KANSAS

©2021  
MKEC Engineering  
All Rights Reserved  
www.mkec.com  
These drawings and their contents, including, but not limited to, all concepts, designs, & ideas are the exclusive property of MKEC Engineering (MKEC), and may not be used or reproduced in any way without the express consent of MKEC.

**DRAINAGE MAP**

PROJECT NO.	1901010483	
DATE	FEB. 2021	
SCALE	1" = 200'	
DESIGNED	DRAWN	CHECKED
JRA	RAM	JRA

NO.	REVISION	DATE

SHEET NO.  
**40 OF 41**