

**BENCHMARKS:**

BM #1: "□" on top of curb near the NW corner of Lot 28, Block E, Firefly Way Addition.  
Elev. = 1399.50 NAVD88

BM #2: "□" on top of curb near the NE corner of Lot 34, Block D, Firefly Way Addition.  
Elev. = 1400.76 NAVD88

BM #3: "□" on top of curb near the NW corner of Lot 27, Block E, Firefly Way Addition.  
Elev. = 1398.85 NAVD88

Sta 0+00.00, Begin construction of AC Pavement 5" (3" Bit Base) W/ Crushed Rock Base 5" and 5' Wide Concrete Sidewalk 4".

Sawcut, remove and replace existing surface course as indicated. Sawcut existing asphalt to full depth at Sta. 0+00 to create neat asphalt construction joint.

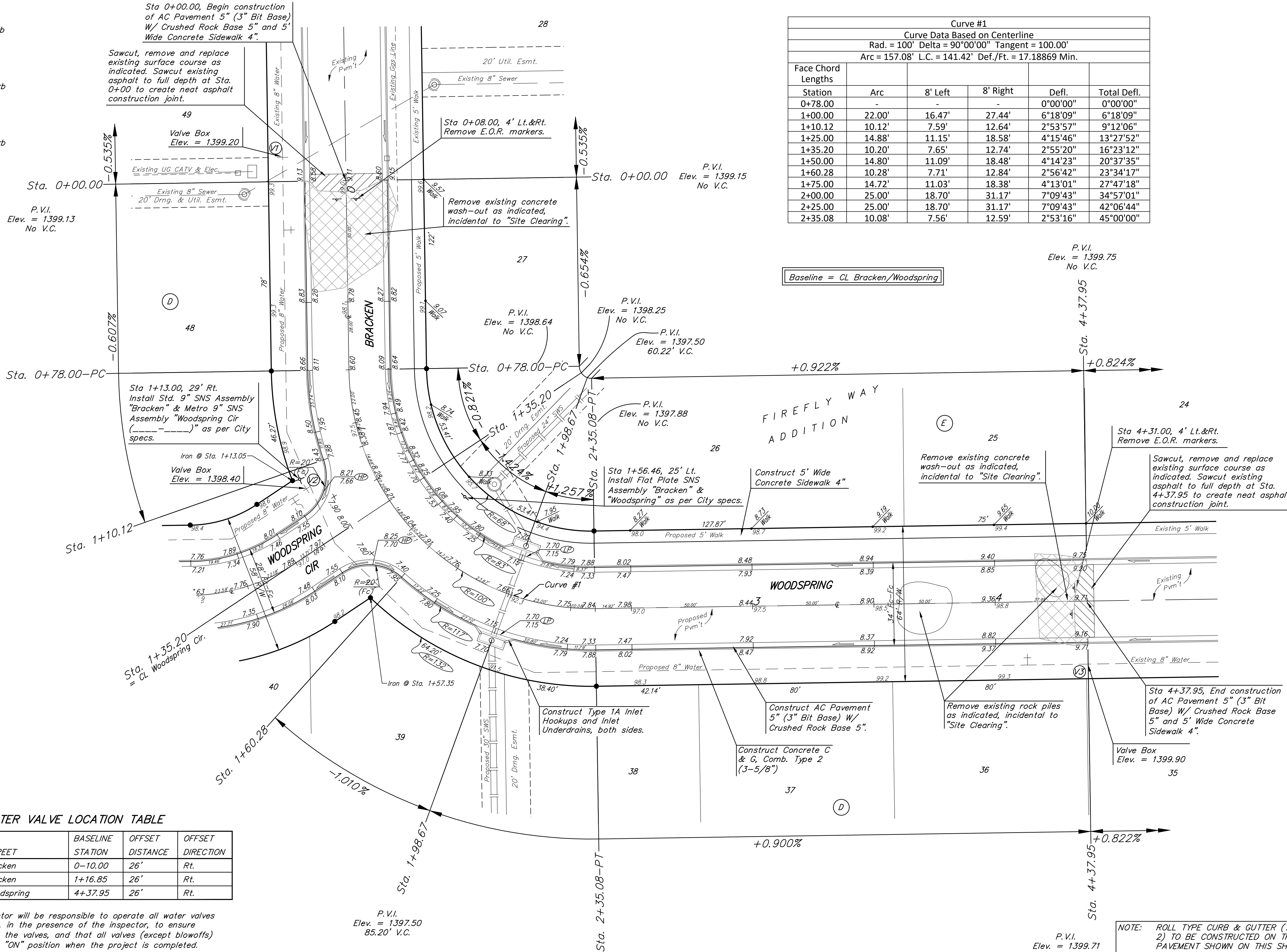

Curve #1					
Curve Data Based on Centerline					
Rad. = 100' Delta = 90°00'00" Tangent = 100.00'					
Arc = 157.08' L.C. = 141.42' Def./Ft. = 17.18869 Min.					
Face Chord Lengths	Arc	8' Left	8' Right	Defl.	Total Defl.
0+78.00	-	-	-	0°00'00"	0°00'00"
1+00.00	22.00'	16.47'	27.44'	6°18'09"	6°18'09"
1+10.12	10.12'	7.59'	12.64'	2°53'57"	9°12'06"
1+25.00	14.88'	11.15'	18.58'	4°15'46"	13°27'52"
1+35.20	10.20'	7.65'	12.74'	2°55'20"	16°23'12"
1+50.00	14.80'	11.09'	18.48'	4°14'23"	20°37'35"
1+60.28	10.28'	7.71'	12.84'	2°56'42"	23°34'17"
1+75.00	14.72'	11.03'	18.38'	4°13'01"	27°47'18"
2+00.00	25.00'	18.70'	31.17'	7°09'43"	34°57'01"
2+25.00	25.00'	18.70'	31.17'	7°09'43"	42°06'44"
2+35.08	10.08'	7.56'	12.59'	2°53'16"	45°00'00"

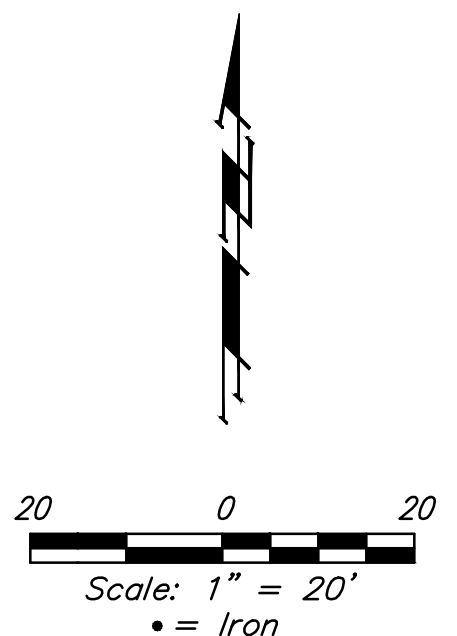

Baseline = CL Bracken/Woodspring

**WATER VALVE LOCATION TABLE**

VALVE NUMBER	STREET	BASILINE STATION	OFFSET DISTANCE	OFFSET DIRECTION
V1	Bracken	0-10.00	26'	Rt.
V2	Bracken	1+16.85	26'	Rt.
V3	Woodspring	4+37.95	26'	Rt.

Paving contractor will be responsible to operate all water valves on the project, in the presence of the inspector, to ensure accessibility to the valves, and that all valves (except blowoffs) are left in the "ON" position when the project is completed.

NOTE: ROLL TYPE CURB & GUTTER (TYPE 2) TO BE CONSTRUCTED ON THE PAVEMENT SHOWN ON THIS SHEET. TOP OF CURB ELEVATIONS ARE GIVEN FOR FULL HEIGHT CURB (TYPE 4).



**BAUGHMAN COMPANY**  
315 Ellis St.  
Wichita, KS 67211  
316-262-7271  
BaughmanCo.com

**WOODSPRING/ BRACKEN**

STREET IMPROVEMENTS

PROJECT NUMBER:  
20-06-E608

DESIGN: AEG DRAWN: TMS  
DATE: May 17, 2021

SHEET 2 OF 28

File: E:\Projects\Firefly Way-Ritchie\_16-04-P195\Engineering\Phase 5\SW\STRaws.dwg