

Scaled: 07-08-2021 5:15:17 PM by BJS
 Plot Scale: 1" = 40'-0" (1:480)
 User: Wichita-civil\2017\171395\001\main-trans\Drawings\171395-001-78C-TRAFFIC CONTROL-STAGE 2

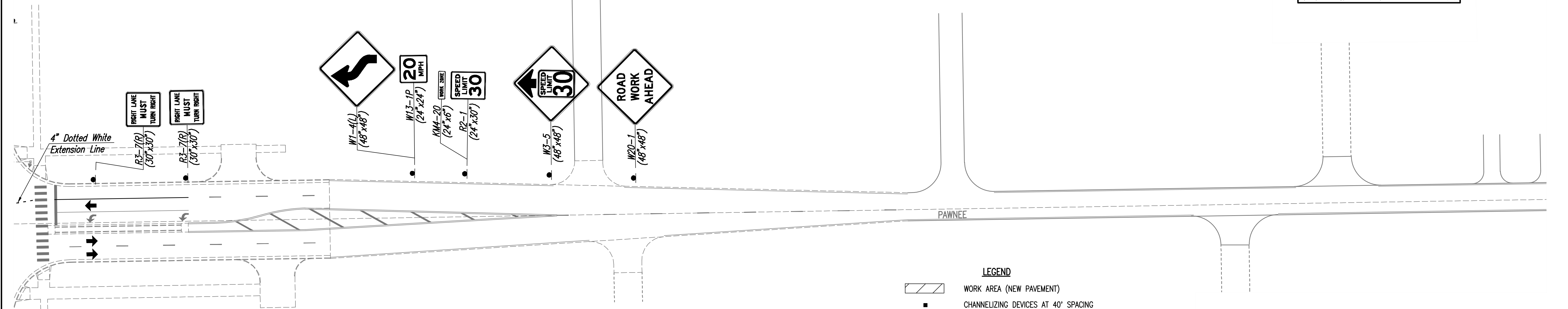
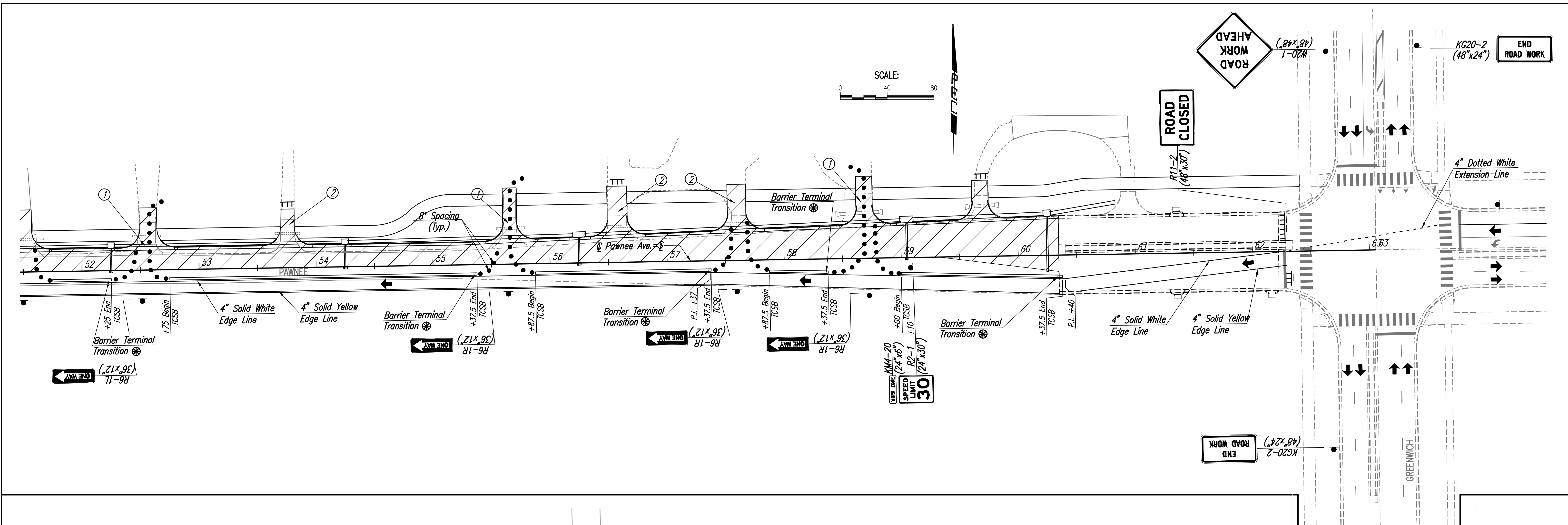

- ① Construct entrance half at a time. Place channelizing devices as necessary during construction to restrict access to work area.
- ② At least one entrance shall be open at all times during construction.

Note: Utilities are not shown on Traffic Control Plans. The Contractor is responsible for verification as to type and location of underground utilities as may be necessary to avoid damage thereto. The Contractor is responsible for repairing any damage to underground utilities.

Moving temporary concrete safety barrier, channelizing devices, and signs, and additional traffic control may be necessary to construct side roads and entrances. Unless closure is permitted, maintain all weather access at all times during construction. This shall be considered Subsidiary.

NOTE: SIGNS AND BARRICADES ARE SHOWN DIAGRAMMATICALLY ONLY. CONTRACTOR WILL BE RESPONSIBLE TO INSTALL THE REQUIRED NUMBER OF POSTS TO SUPPORT THE INSTALLATION.

LEGEND

	WORK AREA (NEW PAVEMENT)
	CHANNELIZING DEVICES AT 40' SPACING UNLESS OTHERWISE NOTED
	TRAFFIC CONTROL SIGN
	YELLOW TYPE "A" LOW INTENSITY WARNING LIGHT
	RED TYPE "B" HIGH INTENSITY WARNING LIGHT
	INSTALL TYPE I OBJECT MARKER AT END OF BARRIER TERMINAL
	18"x18" FLUORESCENT RED-ORANGE FLAGS
	TYPE III BARRICADE WITH TYPE A LOW INTENSITY FLASHING WARNING LIGHTS
	DIRECTION OF TRAFFIC

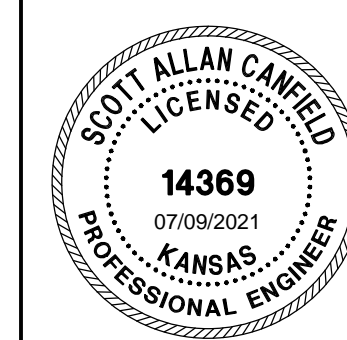

No.	Revision	By	Date

PAWNEE AVENUE FROM WEBB TO GREENWICH
 PAVING AND INCIDENTAL DRAINAGE IMPROVEMENTS
TRAFFIC CONTROL-STAGE 2
 GARY JANZEN, P.E.-CITY ENGINEER
 CITY OF WICHITA PROJECT NO. 472-85434

PROFESSIONAL ENGINEERING CONSULTANTS, P.A.
 303 SOUTH TOPEKA WICHITA, KS 67202
 316-262-2891 www.pec1.com

Designed by RJS	Job No. 171395-002	Sht. 78 of 134
Drawn by BJS, CP	Date APRIL 2021	