

J:\PROJECTS\2019\10483\_COW\_10TH-15TH BRIDGES\_190483\_CAD\SHETS\505\_CIVIL\PAV\19483-05-5001.DWG  
 PLOTTED: Wednesday, October 13, 2021 @ 03:29PM

### GENERAL NOTES

Unless shown or stated otherwise on these drawings, materials, and construction shall be in accordance with City of Wichita Standard Specifications and special provisions.

Contractor will be required to provide a minimum advance notice of seventy-two (72) hours to utility companies prior to starting any excavation as follows:

Kansas One-call 1-800-344-7233  
 or local Wichita 687-2470

The Contractor must notify the following in case of an emergency:

AT&T (telephone) 1-800-870-8390  
 Cox Communications (cable) 262-0661  
 Evergy (electric) 383-8600  
 Kansas Gas Service (gas) 1-888-482-4950  
 City of Wichita Water & Sewer Maint. 262-6000

The Contractor shall be responsible for preserving existing property irons shown on plans. The Contractor will be required to reestablish any shown property irons which are damaged or destroyed by his construction operations. Such irons shall be reestablished at the Contractor's expense by a licensed land surveyor in accordance with state laws.

Construction staking shall be performed by the City of Wichita Public Works Department. All staking performed by the City of Wichita will be done at no cost to the contractor. The contractor shall coordinate the survey staking with the City of Wichita Public Works Department and give the surveyor 24 hours notice when stakes are required.

Utility service lines, poles, valve boxes, meters, etc... are to be adjusted as necessary by others prior to construction unless the plans specifically call for their adjustment by the contractor. Existing utilities and their location, as shown on the plans, represent the best information obtainable for design. Some utilities have been relocated and may not reflect so on the plans. Location information has been obtained from the various utility companies and is either from company record drawings or company provided field locations. The plan locations shown are not guaranteed. Additional existing utilities may also be encountered. The contractor will be required to work around existing utilities within the right-of-way which do not conflict with proposed construction.

All stationing, radii, pavement widths, offset distances, etc... are measured to the back of the curb and gutter and along the project baseline unless otherwise noted on the plans. Spot elevations on plan sheets are at Back of Full-Height Curb and Gutter flow line. Spot elevations on Intersection Details are as noted. Cross-section elevations are existing surface and top of proposed surface at the project baseline.

Rubble from the removal of miscellaneous structures and excess excavation which is to be wasted shall be disposed of on sites to be provided by the contractor. These sites shall be approved by the Engineer as to suitability, appearance and site location. Locations that, in the opinion of the Engineer, will leave an unsightly appearance will not be approved. All disposal sites must be approved by the Kansas Department of Health and Environment. Material either stockpiled or disposed of in a flood plain would require a Kansas State Board of Agriculture permit. Any material dumped in waters of the United States or wetlands is subject to U.S. Corps of Engineers permitting regulations. Any material buried or stockpiled beyond approved construction limits would require additional archeological investigations unless buried in a previously approved borrow location. Millings from the "Mill and Overlay" operation shall become the property of the contractor and disposed of on sites provided by the contractor. These sites shall be approved by the Engineer as to suitability, appearance and site location.

A full-depth saw cut shall be provided at locations where proposed construction abuts an Existing Surface or Pavement for which partial removal of that surface or pavement is required. Saw Joint to facilitate removal within three (3) feet of Existing Joints will not be permitted and for such instances the Limits of Removal shall extend to the Existing Joint.

Contractor shall remove and deliver to 1801 S. McLean all regulatory signs, bollards, and manhole frames and lids, noted for removal during construction. Contractor shall also remove and deliver all existing road closure barricades, concrete blocks and snow fence. Contractor shall be responsible for the installation of new signs. All associated costs to transport the salvaged material will be Subsidiary to the bid item "Transportation of Salvaged Materials".

All areas disturbed by construction that are adjacent to developed properties shall be restored with sod to match existing turf type. Restoration of disturbed areas shall include, but not be limited to, top soil preparation and sodding. All Sodding work shall be in accordance with City Standard Specifications and the City Administrative Regulation No. AR6.5, which governs cleanup and restoration or replacement following construction. The "Recapitulation of Quantities" shows the estimated Square Yards of Sodding, with a bid item for the same. When the weather/season prevents the installation of Sod, the Contractor shall be responsible for installing Erosion Control Blanket (Curlax 1, or approved equal) at the Back of Curb (8' wide minimum). All costs for Erosion Mat installation shall be Subsidiary to "Site Restoration". See Sections 902.7 and 902.8 of the standard specifications.

Select Soil (Topsoil) shall be placed at a minimum depth of 6 inches or as specified on the drawings. The finished grade indicates the surface elevation after the prescribed select soil (topsoil) thickness has been placed. Where offsite select soil is needed, it shall be fertile natural topsoil, typical of the locality, obtained from well drained areas. Stockpiled topsoil may be used. It shall be without admixture of subsoil or silt and shall be free of stones, lumps, sticks, plants, or their roots, toxic substances or other extraneous matter that may be harmful to plant growth or would interfere with future maintenance. Topsoil pH range shall be 5.5 to 7.0. Topsoil shall be approved by the Project Engineer prior to placement. Select soil imported will be Subsidiary to excavation. No additional payment will be made to import off-site select soil.

All gravel or other similar debris larger than 1/2 inch in diameter shall be raked up and removed during final grade preparation.

Proposed curbs matching existing curbs shall be altered to match the shape and dimensions of the existing curb. Positive drainage shall be maintained through such transitions.

Contractor shall provide positive drainage away from all manhole covers.

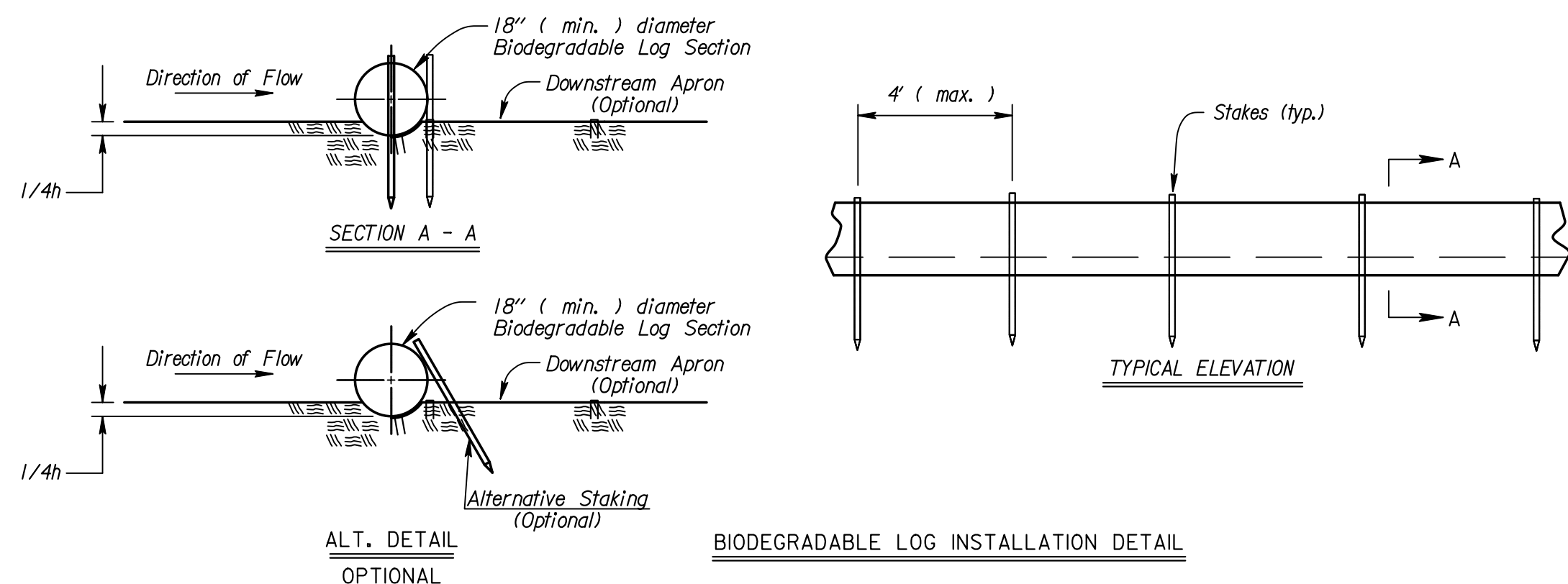

### PROJECT CONTROL & INFORMATION (15TH ST.)

Datum:  
 The Horizontal Datum is based on the Kansas Coordinate System of 1983(2011), South Zone. Coordinates shown have been modified to the ground using a combined adjustment factor of 1.0001200144. State Plane coordinates can be calculated by multiplying the shown values by 0.99988.

All elevations shown are based on the NAVD 88 vertical datum.

Control Points (GND):  
 CP-9  
 N: 1695251.697 E: 1653437.510 EL: 1306.846  
 5/8" rebar with Mid-Kansas id cap on the W edge of asphalt path near the NW corner of bridge.

CP-50  
 N: 1695188.884 E: 1653675.689 EL: 1306.436  
 5/8" rebar with Mid-Kansas id cap on N side of concrete vault SE of the bridge.

CP-500  
 N: 1695220.404 E: 1653801.956 EL: 1305.905  
 Mag Nail with MKEC Control washer set in the centerline of 15th St. 200' east of the bridge.

CP-501  
 N: 1695213.910 E: 1653351.301 EL: 1305.136  
 5/8" rebar with 2" MKEC Control id disk set 150' west of the bridge.

Benchmarks:  
 BM-1  
 N: 1695245.047 E: 1653598.631 EL: 1308.856  
 "+" Cut on E end of the NE Wing Wall of the 15th Street Bridge.

Note:  
 All Control Points shown have elevations established using standard surveying procedures and can be used as temporary benchmarks. When using a Control point as a temporary benchmark, it is recommended that cross-checks be made to other control points or benchmarks to confirm elevations prior to use.

### PROJECT CONTROL & INFORMATION (10TH ST.)

Datum:  
 The Horizontal Datum is based on the Kansas Coordinate System of 1983(2011), South Zone. Coordinates shown have been modified to the ground using a combined adjustment factor of 1.0001200144. State Plane coordinates can be calculated by multiplying the shown values by 0.99988.

All elevations shown are based on the NAVD 88 vertical datum.

Control Points (GND):  
 CP-100  
 N: 1691915.181 E: 1654636.574 EL: 1300.80  
 5/8" rebar with MKEC control id cap on the SW corner of 10th St. and Hydraulic Ave.

CP-101  
 N: 1691947.411 E: 1654350.455 EL: 1305.64  
 5/8" rebar with MKEC control id cap near the NW corner of the 10th St. Bridge

CP-102  
 N: 1691904.279 E: 1654061.114 EL: 1302.27  
 5/8" rebar with MKEC control id cap near the SW corner of 10th and New York St.

Benchmarks:  
 BM-1  
 N: 1691911.935 E: 1654732.059 EL: 1300.15  
 Square Cut on Top of Curb on E. side of curb inlet on the SE corner of 10th and Hydraulic Ave.

BM-2  
 N: 1691904.209 E: 1654465.950 EL: 1305.57  
 "+" Cut on Top of the SE Wing Wall of the 10th Street Bridge

BM-3  
 N: 1691910.085 E: 1654057.322 EL: 1301.76  
 Square Cut on Top Curb on the W. of the SW curb return on the SW corner of 10th & New York.

Note:  
 All Control Points shown have elevations established using standard surveying procedures and can be used as temporary benchmarks. When using a Control point as a temporary benchmark, it is recommended that cross-checks be made to other control points or benchmarks to confirm elevations prior to use.

Utilities:  
 The underground utilities shown hereon were marked in the field by the utility owners in response to Kansas One Call ticket number: 21136380 & 21136406. The surveyor makes no guarantee that the underground utilities shown comprise all such utilities in the area, either in service or abandoned. The surveyor further does not warrant that the underground utilities shown are in the exact location indicated although he does certify that they are located as accurately as possible from information available. The surveyor has not physically located the underground utilities.

RECAPITULATION OF QUANTITIES		
BID ITEM DESCRIPTION	QUANTITY	UNIT
<b>Lump Sum Bid Items</b>		
Mobilization	1	LS
Removal of Existing Structures	1	LS
Transportation of Salvaged Material	1	LS
Excavation	1405	CY
Fill, Compacted (90% Density)	729	CY
Seeding	1	LS
Sodding, Buffalo	1	LS
Signing	1	LS
Traffic Control	1	LS
<b>Measured Quantity Bid Items</b>		
Pavement &/or Curb Removed	1096	SY
Sidewalk, Drive &/or Parking Lot Removed	266	SY
Concrete Channel Lining Removed	661	SY
Concrete Sidewalk 4"	694	SF
Sidewalk Thickening	6	LF
Concrete C & G, Type 1 (6" & 1-1/2")	47	LF
Concrete Curb, Mono Edge (6" & 1-1/2")	16	LF
Concrete C & G Removed and Replaced	13	LF
Wheelchair Ramp w/ Detectable Warnings	2	EA
MH Adjusted w/New Ring & Cover	3	EA
Fence, Special	95	LF
Concrete Deck Removed & Replaced	11	SY
Concrete (Reinf.)	2	CY
Turf Reinforcement Mat	1650	SY
BMP, Back of Curb Protection	139	LF
BMP, Biodegradable Log	635	LF
BMP, Construction Entrance	2	EA

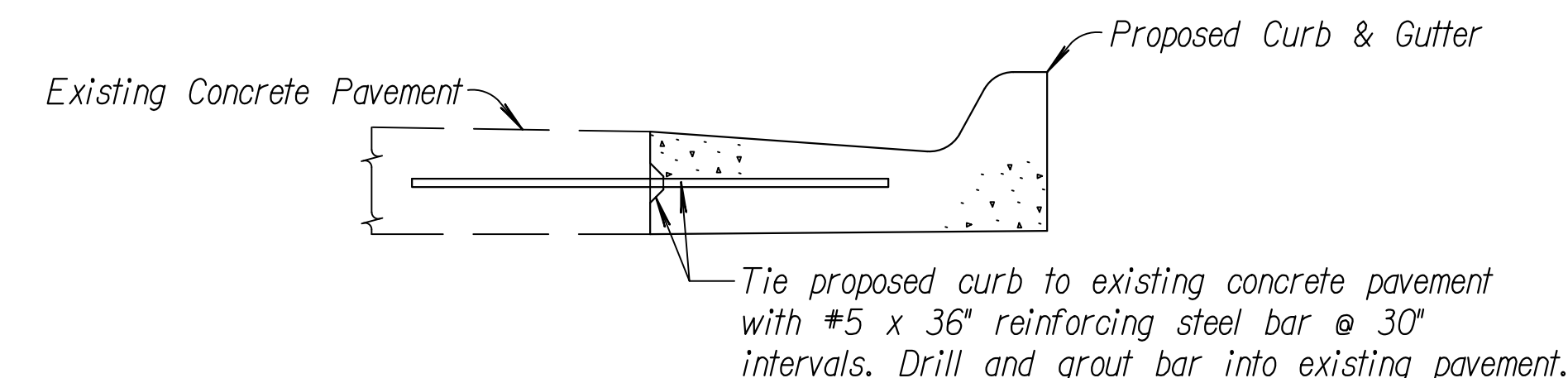

### CURB & GUTTER TIED TO EXISTING PAVEMENT

Location	EARTHWORK						Remarks
	Pavement and/or Curb Removed (SY)	Sidewalk, Drive, and/or Pkg Lot Removed (SY)	Concrete Channel Lining Removed (SY)	Excavation (CY)	VMF	Fill, Compacted (90% Density) (CY)	
Sta. 47+00.00 to Sta. 49+06.53	790.6	130.3				425.9	
Sta. 50+42.21 to Sta. 52+60.40	304.6	134.9				165.0	
West Bank In Channel			210.4	739.8	0.8	43.8	
East Bank In Channel			449.9	664.5	0.8	93.7	
Totals	1095.2	265.2	660.3	1,404.3		728.4	

FOR INFORMATION ONLY



PLANS FOR  
**10TH STREET - 15TH STREET BRIDGES**  
 WICHITA, KS

©2021 MKEC Engineering All Rights Reserved  
 www.mkec.com  
 These drawings and their contents, including, but not limited to, all concepts, designs, & ideas are the exclusive property of MKEC Engineering (MKEC), and may not be used or reproduced in any way without the express consent of MKEC.

### GENERAL NOTES & SUMMARY OF QUANTITIES

PROJECT NO.	1901010483	
DATE	JUNE 2021	
SCALE	NONE	
DESIGNED	JRA	
DRAWN	RAM	
CHECKED	JRA	
NO.	REVISION	DATE

SHEET NO.  
 2 OF 27