

Subdivision Bench Marks

No.	Street and Station	From CL	Description	Elevation
2	Tara Falls, Sta 22+42	17.50' Rt	S. End of S.E. Corner of Tara Falls & Michelle. 5'± South of Hydrant.	

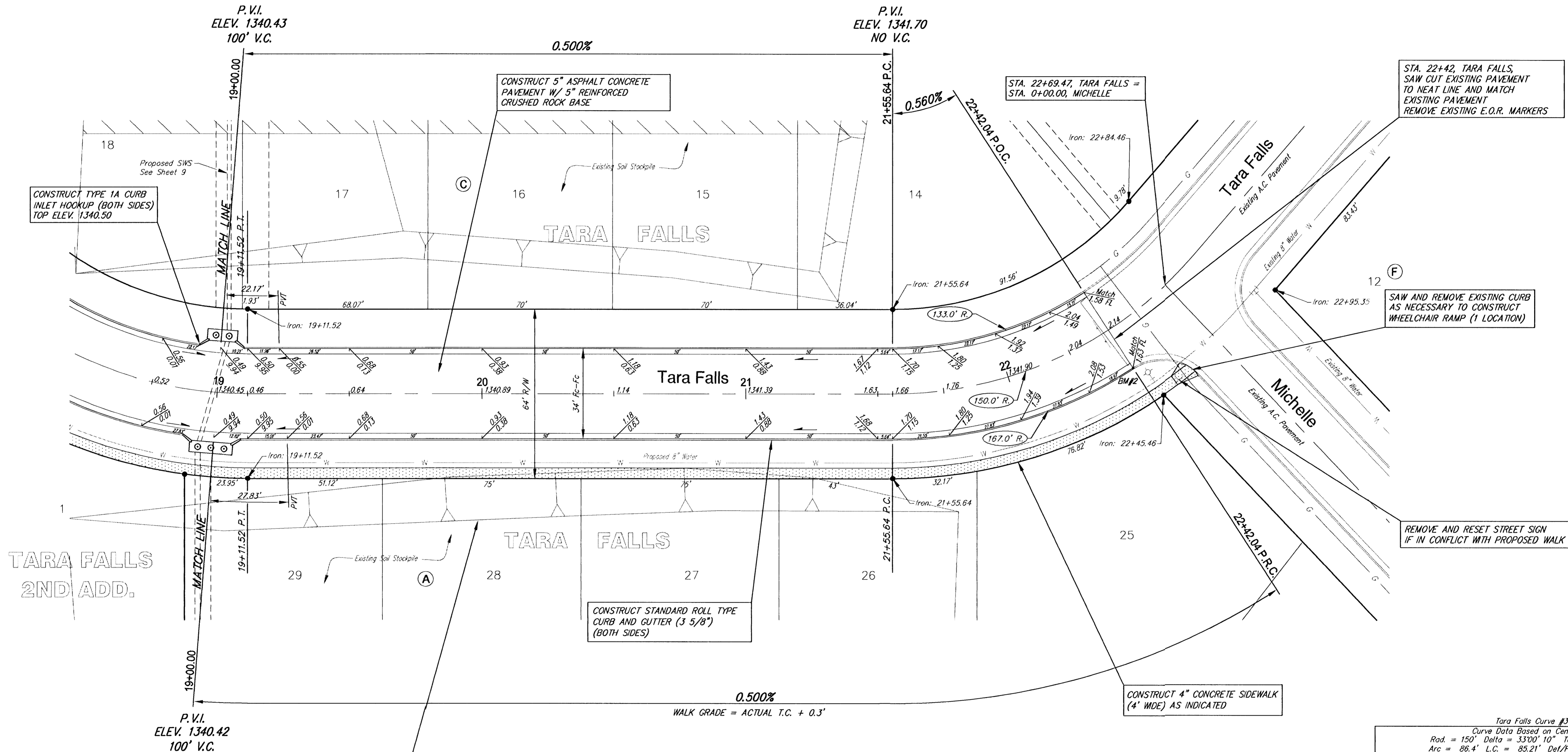

Tara Falls Curve #3  
 Curve Data Based on Centerline  
 Rad. = 150' Delta = 33'00" 10" Tangent = 44.44'  
 Arc = 86.4' L.C. = 85.21' Def/Ft. = 11.45930 Min.

Station	Arc	FACE CHORD LENGTHS			T. Defl.
		B Lt.	B Rt.	Defl.	
21+55.64	-	-	-	0'00'00"	0'00'00"
21+75.00	19.36'	16.12'	22.57'	3'41'51"	3'41'51"
22+00.00	25.00'	20.81'	29.13'	4'46'29"	8'28'20"
22+25.00	25.00'	20.81'	29.13'	4'46'29"	13'14'49"
22+42.04	17.04'	14.19'	19.87'	3'15'16"	16'30'05"

CONTRACTOR TO USE MATERIAL FROM EXISTING SOIL STOCKPILES FOR BORROW. EXCESS MATERIAL TO BE RELOCATED TO AREA INDICATED ON SHEET 12. DEPTH OF FILL NOT TO EXCEED 5'. TOTAL STOCKPILE VOLUME = 9,900 CU. YD.

CONSTRUCT 4" CONCRETE SIDEWALK (4' WDE) AS INDICATED

REMOVE AND RESET STREET SIGN IF IN CONFLICT WITH PROPOSED WALK

SAW AND REMOVE EXISTING CURB AS NECESSARY TO CONSTRUCT WHEELCHAIR RAMP (1 LOCATION)

STA. 22+42, TARA FALLS, SAW CUT EXISTING PAVEMENT TO NEAT LINE AND MATCH EXISTING PAVEMENT REMOVE EXISTING E.O.R. MARKERS

STA. 22+69.47, TARA FALLS = STA. 0+00.00, MICHELLE

CONSTRUCT 5" ASPHALT CONCRETE PAVEMENT W/ 5" REINFORCED CRUSHED ROCK BASE

CONSTRUCT TYPE 1A CURB INLET HOOKUP (BOTH SIDES) TOP ELEV. 1340.50

CONSTRUCT STANDARD ROLL TYPE CURB AND GUTTER (3 5/8") (BOTH SIDES)



SCALE: 1" = 20'  
 ● = IRON

NOTE: ROLL TYPE CURB AND GUTTER TO BE CONSTRUCTED ALONG PAVEMENT DEPICTED ON THIS SHEET

**TARA FALLS PHASE 2 PAVING**  
**TARA FALLS**  
**WICHITA, SEDGWICK COUNTY, KANSAS**

**SRB** 924 NORTH MAIN 316-264-8008  
 WICHITA, KANSAS 67203 FAX 264-4621  
 www.srb1.com E-mail: srb@srb1.com

**SAVOY, RUGGLES & BOHM, P. A.**  
 ENGINEERING & SURVEYING

PROJECT NUMBER  
 472-83374

DESIGN KWL	DRAWN KWL	UTILITY	REVIEW	DATE June 6, 2001	REVISED
---------------	--------------	---------	--------	----------------------	---------

PROJECT NO. 472-83374  
 SHEET 6 OF 27