

**GENERAL NOTES:**

1. Contractor will be required to provide a minimum advance notice of forty-eight (48) hours to utility companies prior to starting any excavation as follows:

Kansas One Call	687-2470
The Contractor must notify the following in case of an emergency:	
Southwestern Bell Telephone	1-316-571-2611
Cox Communications	262-4270 or 263-2061
Kansas Gas Service	832-3168
Western Resources KPL/KGE	264-1141
Peoples Natural Gas	942-8811
City of Wichita Water and Sewer Dept.	262-6000

2. Utility service lines, poles, valve boxes, meters, etc. are to be adjusted as necessary by others prior to construction unless the plans specifically call for their adjustment by the Contractor or unless the plans specifically identify a utility to be adjusted by its owner during construction. Existing utilities and their location, as shown on the plans, represent the best information obtainable for design. The Contractor will be required to work around existing utilities within the right-of-way which do not conflict with proposed construction.

3. A saw cut of at least one-half the depth of existing surface courses or one-fourth the depth of the existing total pavement thickness shall be provided where proposed pavement abuts an existing surface course or pavement removal. Sawed joint to facilitate removal within three (3) feet of existing joints will not be permitted and for such instances the limits of removal shall extend to the existing joint. Such saw cuts will not be paid for directly and this cost shall be considered as subsidiary to other bid items.

4. Rubble Removal - Rubble from the removal of miscellaneous structures and excess excavation which is to be wasted shall be disposed of on sites to be provided by the Contractor. These sites shall be approved by the Engineer as to suitability, appearance, and site location. Locations that, in the opinion of the Engineer, will leave an unsightly appearance will not be approved. All disposal sites must be approved by the Kansas Department of Health and Environment. Material either stockpiled or disposed of in a flood plain will require a Kansas State Board of Agriculture permit. Any material dumped in waters of the United States or wetlands is subject to US Corps of Engineers permitting regulations. Any material buried or stockpiled beyond approved construction limits would require additional archaeological investigations unless buried in a previously approved borrow location. The cost of disposing of rubble from the removal of miscellaneous structures and excess excavation, including loading and hauling shall be subsidiary to the other bid items.

5. The Contractor shall give all property owners and/or tenants of developed property abutting the project limits a minimum of ten (10) days advance notice prior to start of construction.

6. The Contractor shall be responsible for preserving property irons. The Contractor will be required to reestablish any property irons which are damaged or destroyed by his construction operations. Such irons shall be reestablished by a licensed land surveyor or a licensed professional engineer in accordance with state laws.

7. Trees and shrubs in public right-of-way which are in direct conflict with proposed new construction shall be removed by the Contractor with the Engineer's approval. Trees and shrubs which are not in direct conflict with proposed new construction shall be saved and protected from damage. This cost is subsidiary to other bid items.

8. In undeveloped areas, the street right-of-way shall be seeded with temporary Rye grass at a rate of 300 lbs/acre. Seeding in developed areas shall conform to the City's policy AR-78.

9. The Contractor must examine the construction site prior to bidding and be satisfied as to the work shown for completion. After bids have been received, the Contractor shall not assert that there was a misunderstanding of the quantities of work or of the nature of the work to be completed.

10. All construction and materials, unless otherwise noted, to comply with City of Wichita specifications and standards.

11. Any fence removed for construction shall be repaired in a condition equal to, or better than original, at no additional cost to the owner. This cost shall be considered subsidiary to other bid items.

12. Railroad ties and yard decorations within the limits of this project are to be stockpiled for their owner. This cost is subsidiary to the site clearing and restoration bid item.

13. Limits of earthwork shall match existing ground elevations at the right-of-way line unless otherwise noted on the plans. Where the new finished grade elevations do not match the existing ground elevations, the earthwork shall extend one foot beyond the right-of-way line and then slope up or down using permissible slopes to match the existing ground surface.

14. The Contractor will be required to obtain properly executed driveway request forms signed by property owners or their authorized representatives verifying driveway widths and locations. Such forms shall be submitted to the Engineer for review and approval.

15. The Contractor shall give property owners abutting this project, whose yards will be lower than the new finished grade elevations at the right-of-way line, an opportunity to utilize excess excavated material from the project to regrade their yards to drain to the new pavement. The Contractor will be required to dump and spread the excess material as required by the specifications when requested by the property owner. The Contractor shall ascertain that a dirt order form has been properly executed by the property owner before any such excess material is delivered to such properties.

16. Mailboxes within the limits of the project shall be removed and replaced by the Contractor as approved by the Engineer. The Contractor will be required to make satisfactory provisions for mail delivery to properties affected by this project during its construction. This cost is subsidiary to other bid items.

17. All entrance and cross road pipe within the project limits shall be removed by the Contractor unless otherwise noted on the plans. Removal of such pipes shall conform to the applicable section of the standard specifications. This cost is subsidiary to other bid items.

18. The Contractor shall adjust water valve boxes and fire hydrants as directed by the Engineer. This cost is subsidiary to other bid items. The Water Department shall field locate water valves one time during construction when requested by the Contractor. It shall be the Contractor's responsibility to preserve such field locations during the construction process. Water valves, water valve boxes, or fire hydrants damaged during construction shall be repaired by the Contractor at his own expense.

19. Street to be closed during construction except for temporary access coordinated with the adjacent properties. The Contractor shall use construction methods which shall minimize inconvenience to residents in the project area. The Contractor will be required to make special access provisions for any handicapped residents within the project area whose normal access would otherwise be impaired.

# 24TH STREET NORTH

## FROM E.L. HOOD TO W.L. PAYNE

### PROJ. NO. 472-83331 - OCA NO. 765675

## FROM E.L. PAYNE TO W.L. SALINA

### PROJ. NO. 472-83332 - OCA NO. 765676

## CITY OF WICHITA, KANSAS

### M. E. LINDEBAK P.E. - CITY ENGINEER

**INDEX OF SHEETS**

SHEET 1	-	TITLE SHEET
SHEET 2	-	TYPICAL 31" PAVEMENT DETAIL
SHEET 3	-	PAVING PLANS
SHEET 4	-	STANDARD DRIVE DETAILS
SHEETS 5-6	-	EARTHWORK SECTIONS

**LOCATION MAP**

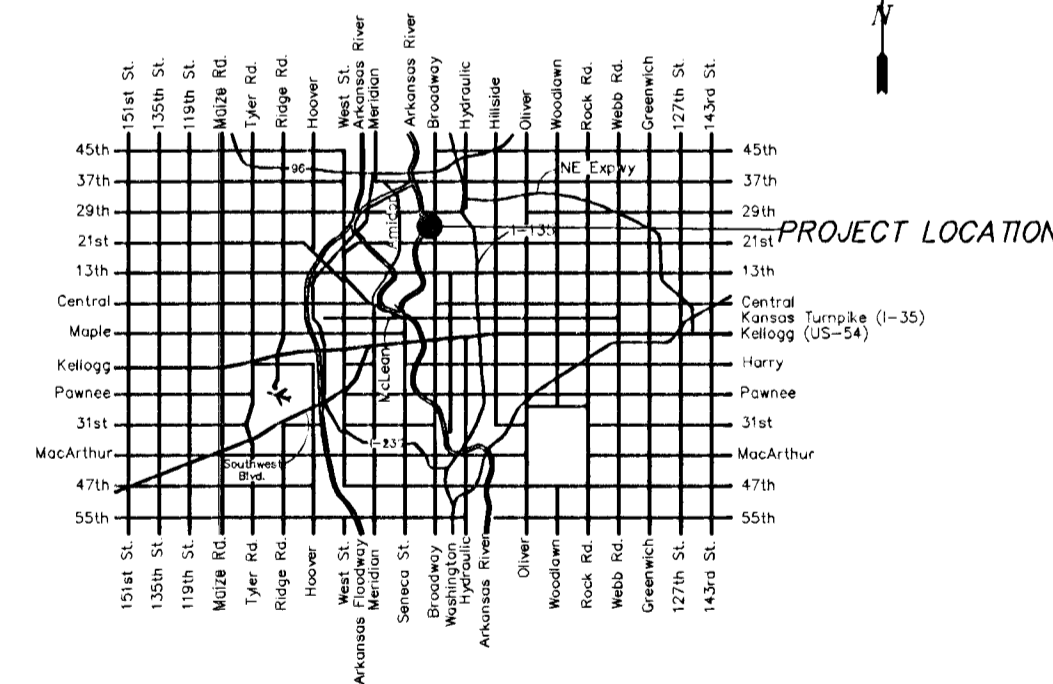

Scale: 1"=150'

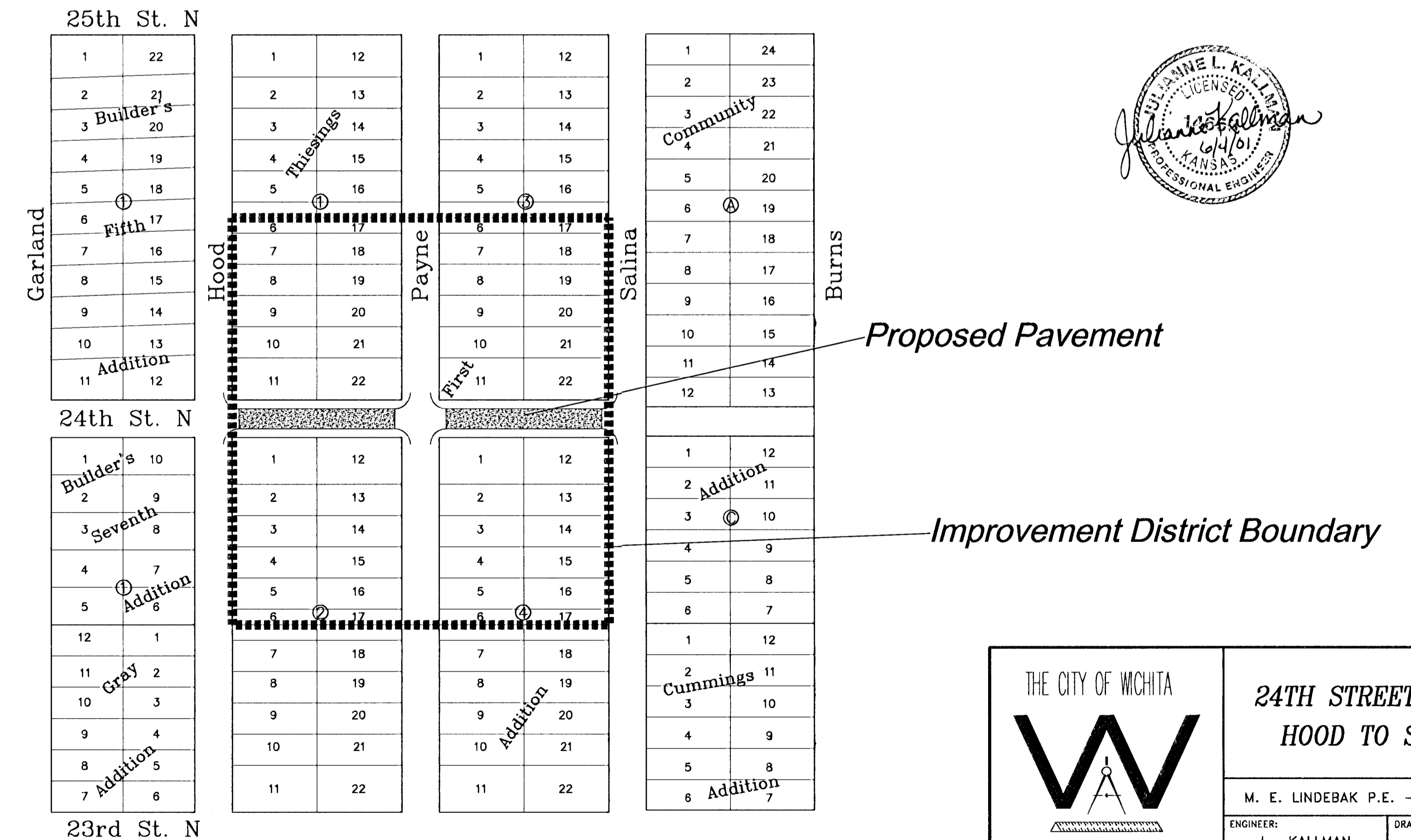

<p>THE CITY OF WICHITA</p>	<b>24TH STREET NORTH</b>	
	<b>HOOD TO SALINA</b>	
M. E. LINDEBAK P.E. - CITY ENGINEER		
ENGINEER:	J. KALLMAN	DRAWN BY:
PROJECT NUMBER:	472-83331/83332	OCA NUMBER:
CITY ENGINEER'S OFFICE	405 NORTH MAIN STREET	765675/765676
WICHITA, KANSAS 67202	(316) 268-4501	
(316) 268-4114 FAX		
DATE:	MAY 01	SHEET 1 OF 6