

Scale: 1" = 30' Horizontal

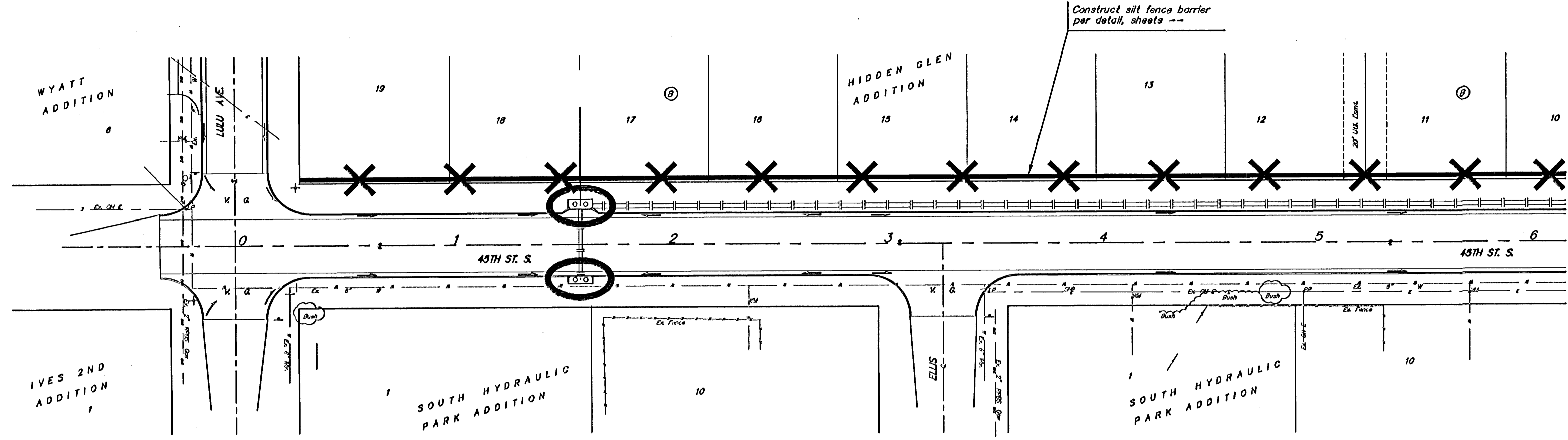

- NOTES:**
- Erosion Control Matting and/or Other Approved Bank Stabilization w/Seeding & Fertilizer Shall Be Installed at Engineered Channels or Sedimentation Basins Where the Designed Sideslopes Will be Greater Than 6:1. All Other Disturbed Areas Shall be Seeded, Fertilized, & Mulched As Follows:
 - All Street Right-of-Ways and developed lawns** shall be seeded and mulched as follows: (Permanent Seeding)
 - SEED -- Fescue K-31; 8#/1000 Sq. Ft.
 - FERTILIZER -- 12-24-12 Ratio at 350 Lbs./Ac.
 - MULCH -- 2 Tons Prairie Hay / Acre (Heavier along pond side slopes)
 - **DEVELOPED LAWNS -- Contractor shall re-seed each developed lawn with grass seed specific to that yard. Check with homeowner prior to seeding.
 - All other disturbed areas not in street R/W OR developed lawns are to be seeded as follows: (Temporary seeding)
 - SEED -- Rye grass (PLS)--5#/1000 Sq. Ft.
 - Permanent Seeding and Temporary Seeding shall both be including in bid item "Project Seeding".
 - Install 8' Wide Culex/Excelstor Blanket, or Approved Equal, on Prepared Surface Back of Curb or Edge of Asphalt. Edge of Blanket Will Be At Back of Curb or Edge of Asphalt. Install Per Manufactures Recommendation, Including Staples.

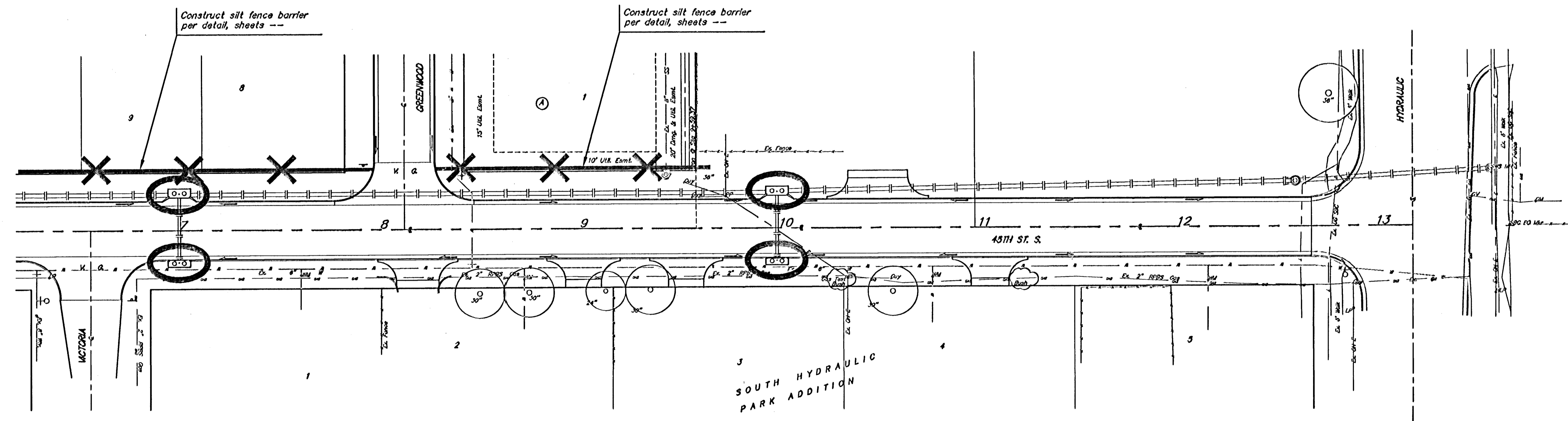

EROSION CONTROL PLAN LEGEND
(Installation Details Found in the SMP2 Plan)

○ - CURB INLET PROTECTION

✕ - SILT FENCING

NO SCALE

EROSION CONTROL MEASURE	UNITS	QUANTITY
SILT FENCE	L.F.	906
RIPRAP	S.Y.	**
DROP INLET BARRIER	EA.	**
CURB INLET BARRIER	EA.	6
Construction Entrance	EA.	**

QUANTITIES ARE FOR INFORMATION ONLY!
CONTRACTOR SHALL VERIFY QUANTITIES PER SPECIFIC ENGINEERING PLAN SHEET.

Baughman 45TH STREET SOUTH
Erosion Control Plan

Baughman Company, P.A. 315 Elm & Walnut, #80111 P.O. Box 277117 F316266149
ENGINEERING | SURVEYING | PLANNING | LANDSCAPE ARCHITECTURE

PROJECT NUMBER 472-83909	DESIGN MWS	DRAWN MWS
REVISIONS	APPROVED	DATE 03/05

SCALE
Noted
SHEET
17 OF 25

Hidden Glen\45th_plana\ecplan 04-09-E057