

FHWA REG. NO.	STATE	PROJECT NO.	YEAR	SHEET NUMBER	TOTAL SHEETS
7	KANSAS		2002	C2	3

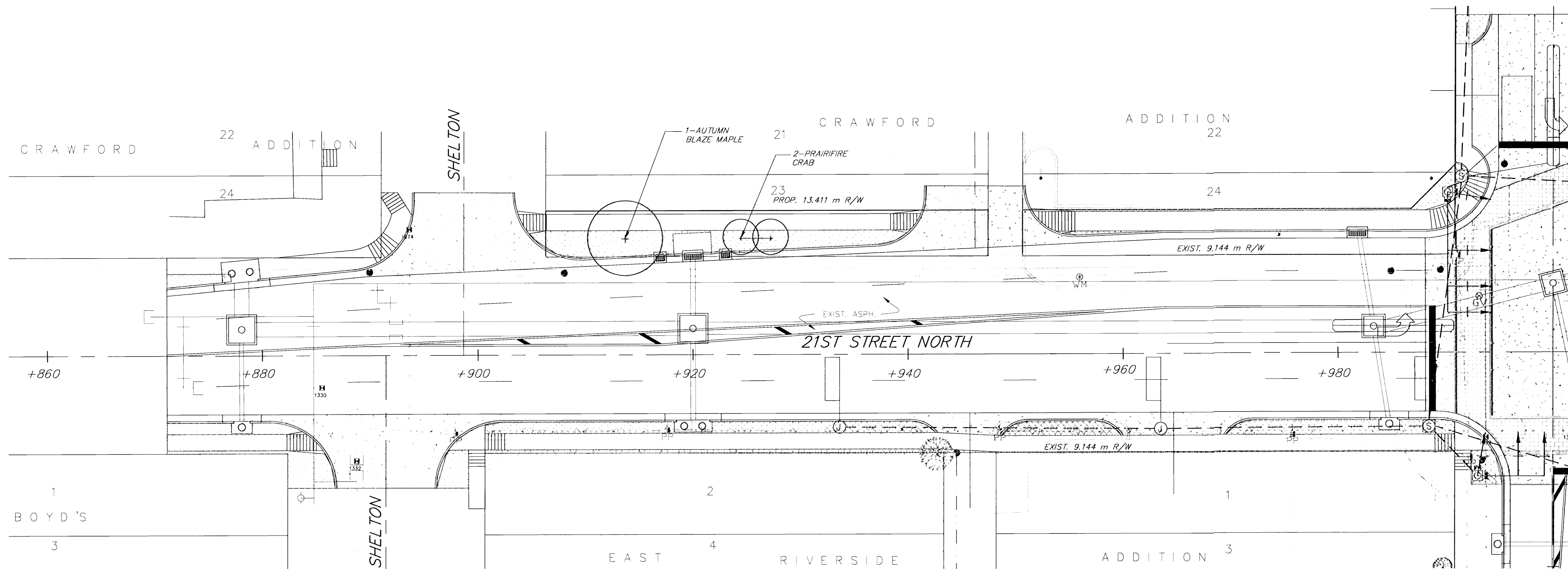

SPECIFICATIONS

SITE PREPARATION AND EARTHWORK

- Contractor shall locate all utilities before commencing work. Contractor shall be responsible for the repair of any damage to utilities resulting from construction operations. Any utilities shown on plans are for reference only and may or may not depict the actual location of services.
- Topsoil shall be a friable loam with good structure. Soluble salts shall not exceed 500 ppm and organic matter shall be no less than 1.5% by weight. PH shall range between 6.0 and 7.0.
- Landscape Contractor shall have topsoil and on site soils tested by a certified testing laboratory and obtain recommendations for soil amendment type(s) and quantities. Submit copy of this report to the architect for their records. Recommendations shall be specific to the plant materials specified on the drawings.
- General contractor shall place 4" of topsoil in all turf areas within the limits of construction.
- All rough grading shall be the general contractors responsibility. Landscape contractor shall be responsible for finish grade.

PLANTING PREPARATION

- Backfill: For tree ball excavations to be clean natural topsoil mixed with amendments at the ratios specified by a certified soil analysis.
- When clay soil is encountered in the establishment of the lawn or the installation of plant material it shall be improved in accordance with standard trade practice. Landscape contractor shall take measures to insure adequate drainage.

PLANTING PREPARATION

- All plant material shall be well-formed and developed in good condition, healthy and disease-free, and be typical of the species. Plants shall comply in all applicable respects with acceptable standards as set forth in the American Association of Nurseryman's "American Standard of Nursery Stock". Height of plant materials shall be measured from existing soil line at top of rootball to top of tree.
- All plant materials shall be protected from the drying action of the sun and wind after being dug, while being transported, and while awaiting planting. Balls of plants which cannot be planted immediately shall be protected from drying action by covering them with moist mulch. Periodically, apply water to mulch-covered balls to keep moist. If planting should occur during growing season, apply anti-desiccant to leaves before transport to reduce likelihood of windburn. Reapply anti-desiccant after planting to reduce transpiration.
- All trees locations are approximate, adjust as necessary to avoid conflicts.
- All tree and shrub plant holes are to have a soil mix consisting of 60% excavated soil and 40% organic acidified soil conditioner or upon approval of the Engineer, existing soil may be used.

RELATED ITEMS

- Mulch: Use shredded cedar bark mulch in all tree and shrub planting locations or, upon approval of the Engineer, hardwood mulch may be used. Landscape contractor shall supply architect with a sample of mulch for approval prior to starting construction. Size of material to range from 1"-2" only.
- Place 3" of mulch in all tree and shrub planting locations.

MAINTENANCE AND CLEAN-UP

- The contractor shall provide all water, watering devices and labor needed to irrigate plant materials until provisional acceptance of the project. The contractor shall supply enough water to maintain the plants healthy condition.
- Remove all rubbish, equipment and material and leave the area in a neat, clean condition each day. Maintain paved areas utilized for hauling equipment and materials by others trades in a clean and unobstructed condition at all times.
- Remove soil or debris that accumulated during or as a result of planting operations each day.
- Fertilize all plants with 10-20-10 commercial slow-release fertilizer as directed by instructions of fertilizer.
- Reestablish turf in areas disturbed by grading or utility trenching in the R.O.W.
- Contractor to remove stakes, guys, and all dead wood on trees one year after provisional acceptance.

GUARANTEE

- Provide a one (1) year guarantee for plant materials from time of provisional acceptance.

LEGEND

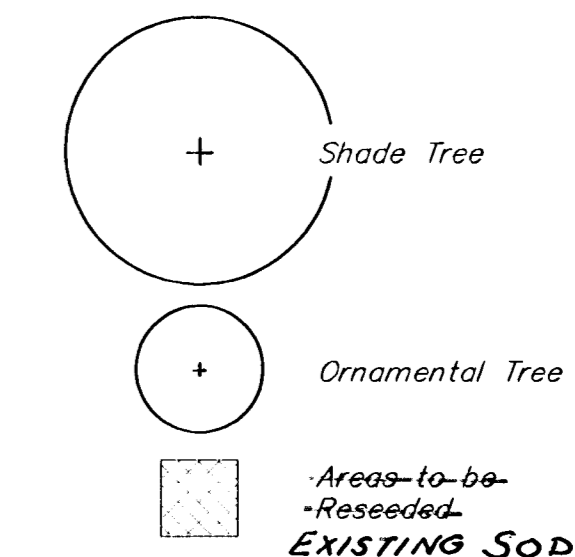

1:200

	PROJECT NUMBER 472-83184	AM. NO. 93147	21ST AND ARKANSAS LANDSCAPE PLAN CITY OF WICHITA	SHEET C2		
	DESIGN bh	DRAWN bh		FILE Lscope1	DATE 1-30-02	SCALE 1:200