

BENCH MARKS:
 City Disc - 34.3' E. & 3.3' N. of
 S.W. Corner of N.W. 1/4, Sec. 25,
 T-27-S, R-2-W.
 Elev. = 156.63 City Datum

City Disc - 135TH St. W. & Maple,
 30' N. & 15' E. @ Both.
 Elev. = 150.20 City Datum

P.V.I.
 Elev. = 174.50
 70' V.C.

SCALE: 1" = 20'
 • = Iron

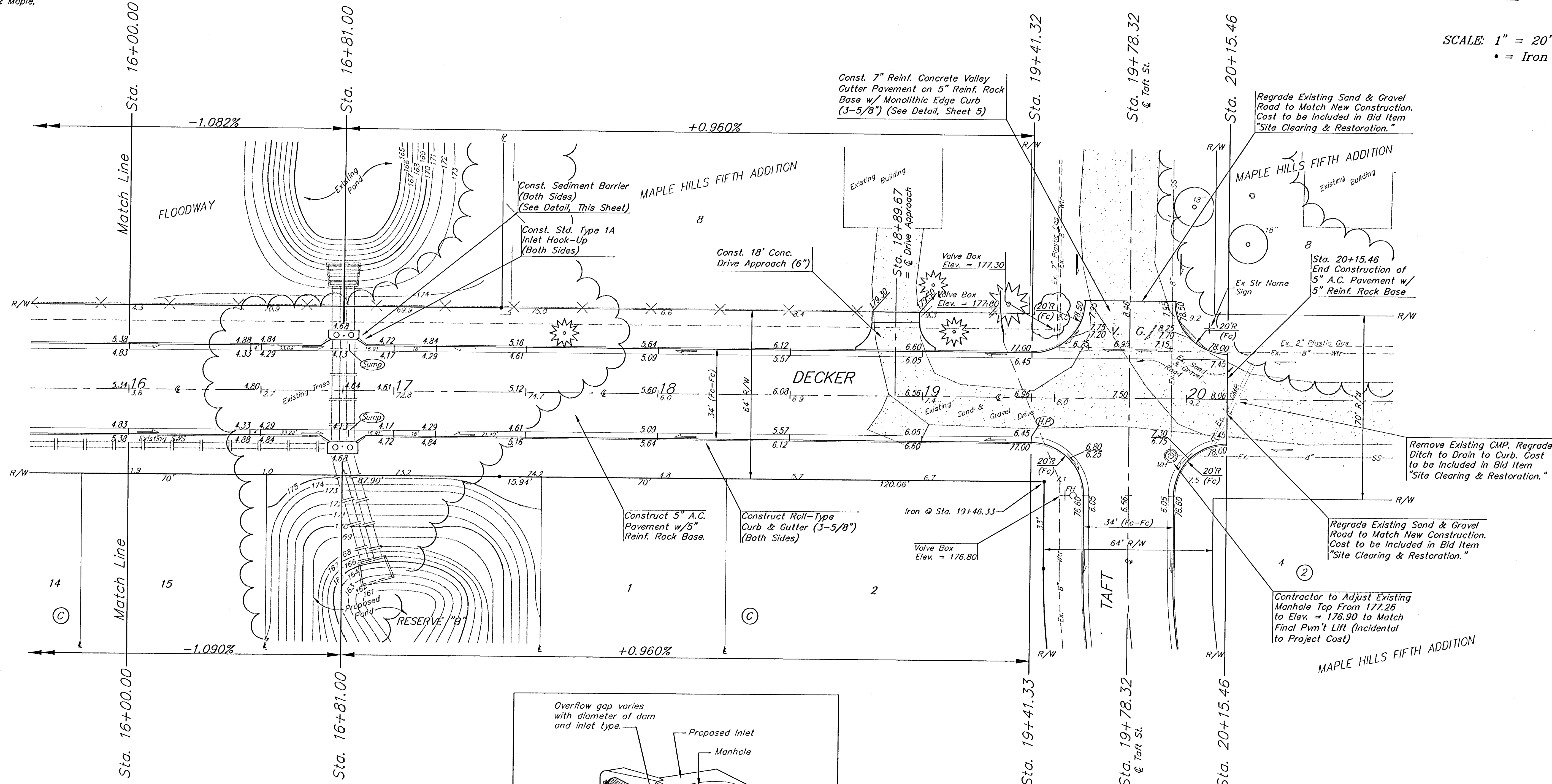

P.V.I.
 Elev. = 174.50
 70' V.C.

AUBURN HILLS 12TH ADDITION

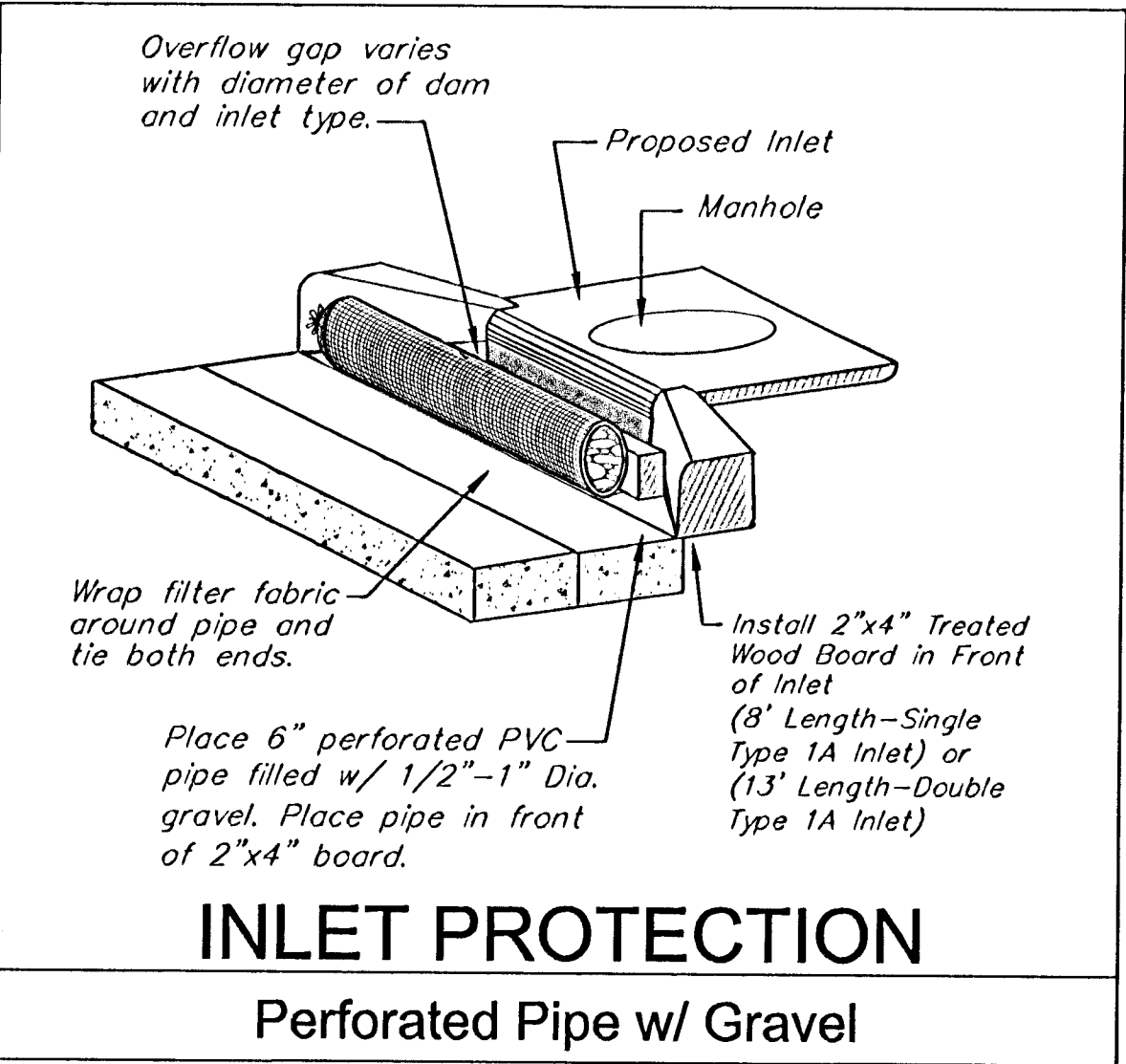

Remove Existing Trees Only
 as Necessary For Construction.
 Cost to be Included in Bid Item
 "Site Clearing & Restoration"

AUBURN HILLS ADDITION - PHASE I
DECKER STREET
 STA. 18+00.00 TO STA. 19+41.48

BAUGHMAN COMPANY P.A.
 ENGINEERING, SURVEYING, & PLANNING
 318-262-7271 • 315 ELLIS • WICHITA, KANSAS 67211

PROJECT NUMBER
472-93290

DESIGN: DMV DRAWN: JAK APPROVED: [Signature] DATE: 3-14-01 SCALE: NOTED SHEET: **8** OF **30**