

**BENCH MARKS:**  
 City Disc - 34.3' E. & 3.3' N. of  
 S.W. Corner of N.W. 1/4, Sec. 25,  
 T-27-S, R-2-W.  
 Elev. = 156.63 City Datum

City Disc - 135TH St. W. & Maple,  
 30' N. & 15' E. of Both.  
 Elev. = 150.20 City Datum

**AUBURN HILLS 12TH ADDITION**

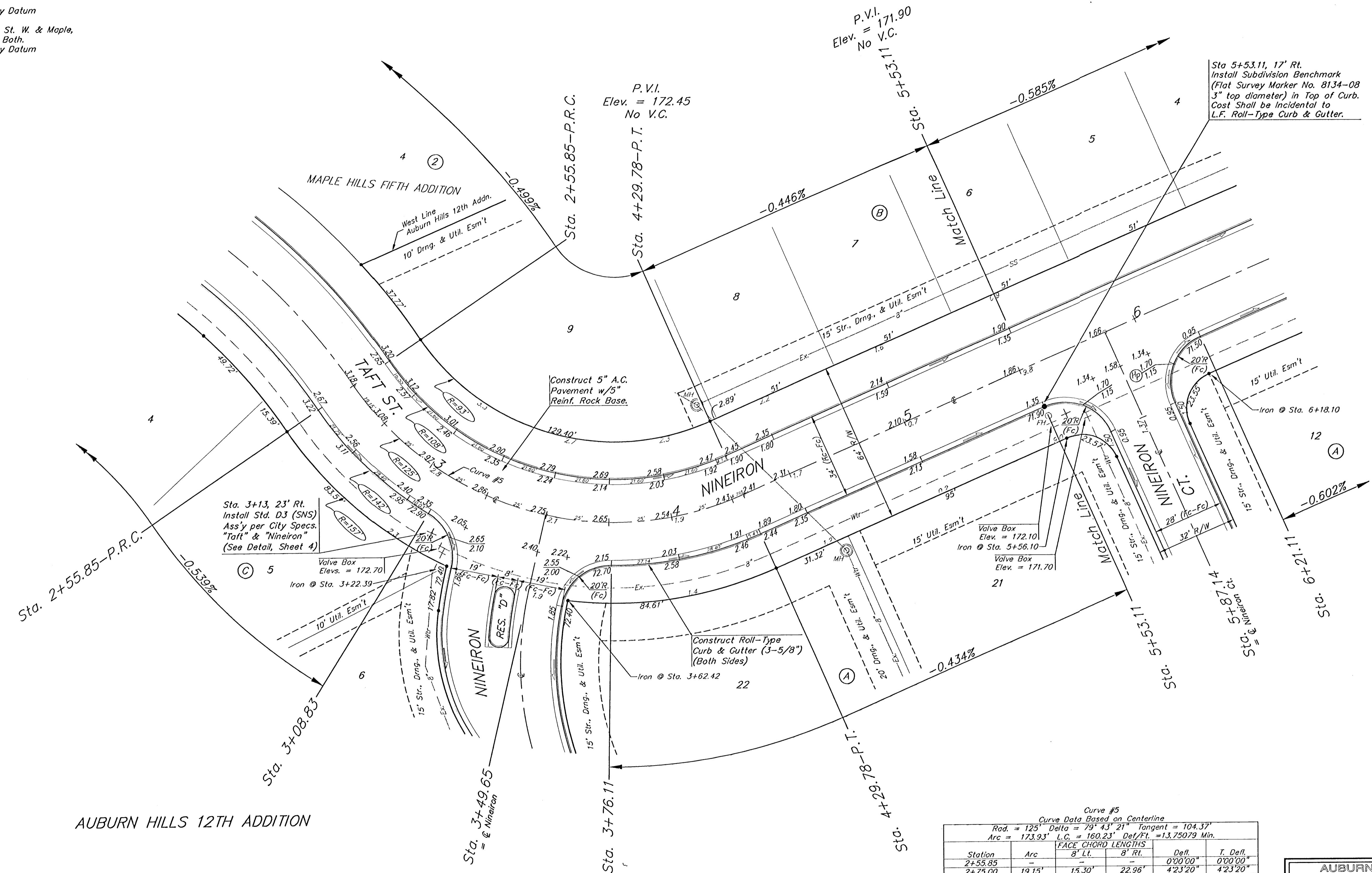
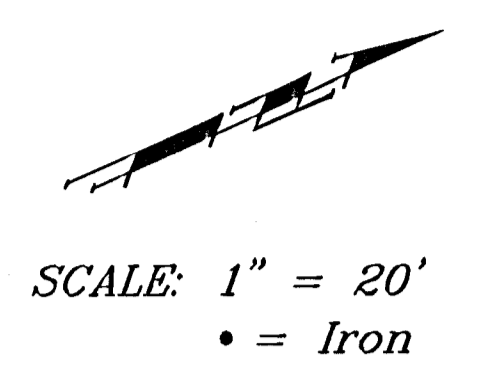

**AUBURN HILLS 12TH ADDITION**

Curve #5  
 Curve Data Based on Centerline  
 Rad. = 125' Delta = 79° 43' 21" Tangent = 104.37'  
 Arc = 173.93' L.C. = 160.23' Del/Ft. = 13.75079 Min.

Station	Arc	FACE CHORD LENGTHS		T. Del.	T. Del.
		8' Lt.	8' Rt.		
2+55.85	-	-	-	0'00"00"	0'00"00"
2+75.00	19.15'	15.30'	22.96'	4'23'20"	4'23'20"
3+00.00	25.00'	19.97'	29.95'	5'43'46"	10'07'06"
3+08.83	8.83'	7.06'	10.59'	2'01'25"	12'08'31"
3+25.00	16.17'	12.93'	19.39'	3'42'21"	15'50'52"
3+50.00	25.00'	19.97'	29.95'	5'43'46"	21'34'39"
3+75.00	25.00'	19.97'	29.95'	5'43'46"	27'18'24"
3+76.11	1.11'	0.89'	1.33'	0'15'16"	27'33'40"
4+00.00	23.89'	19.08'	28.62'	5'28'31"	33'02'11"
4+25.00	25.00'	19.97'	29.95'	5'43'46"	38'45'52"
4+29.78	4.78'	3.82'	5.74'	1'05'44"	39'51'41"

AUBURN HILLS ADDITION - PHASE I  
**NINEIRON**  
 STA. 2+55.85 TO STA. 4+29.78

**BAUGHMAN COMPANY P.A.**  
 ENGINEERING, SURVEYING, & PLANNING  
 315-262-7271 • 315 ELLIS • WICHITA, KANSAS 67211

PROJECT NUMBER: 472-83290  
 SHEET: 10 OF 30  
 DESIGN: DMV DRAWN: JAK APPROVED: DATE: 3-14-01 SCALE: NOTED