

BENCH MARKS:
 City Disc - 34.3' E. & 3.3' N. of
 S.W. Corner of N.W. 1/4, Sec. 25,
 T-27-S, R-2-W.
 Elev. = 156.63 City Datum

City Disc - 135TH St. W. & Maple,
 30' N. & 15' E. @ Both.
 Elev. = 150.20 City Datum

SCALE: 1" = 20'
 • = Iron

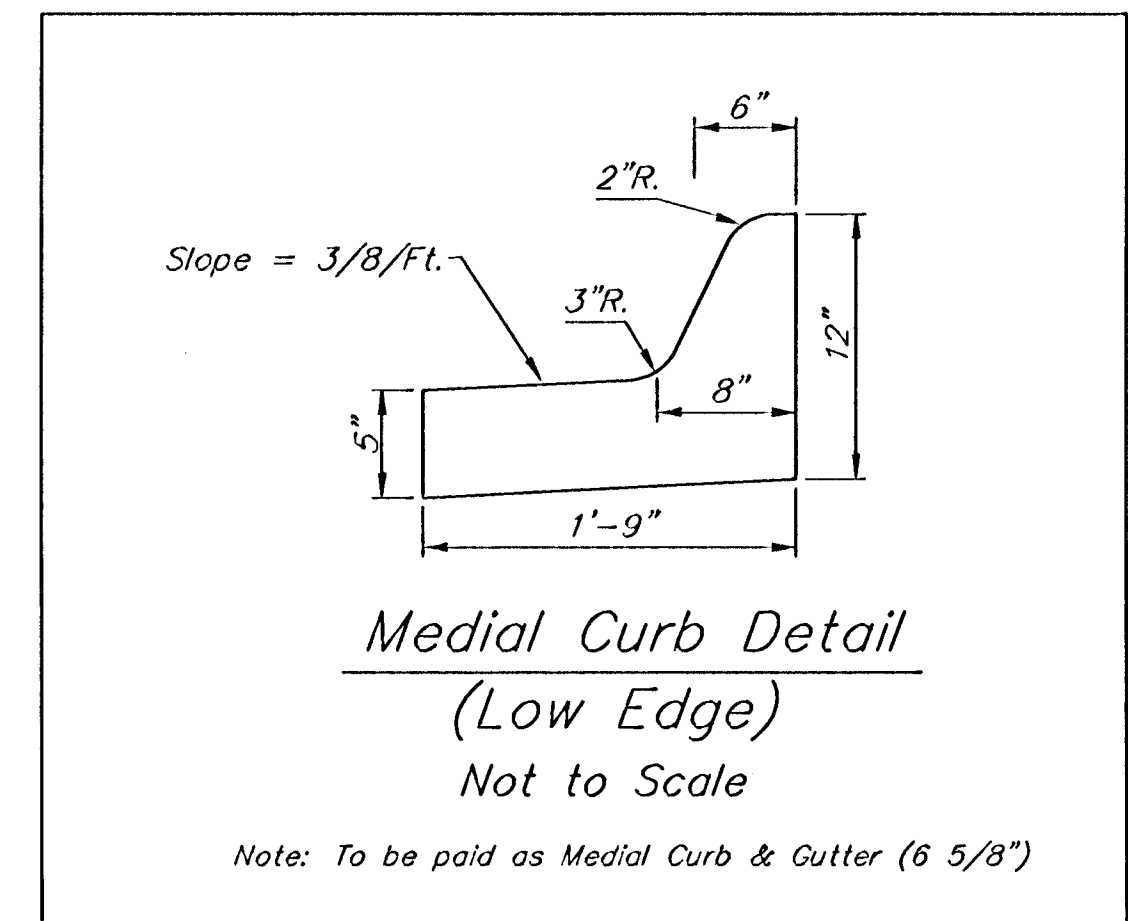
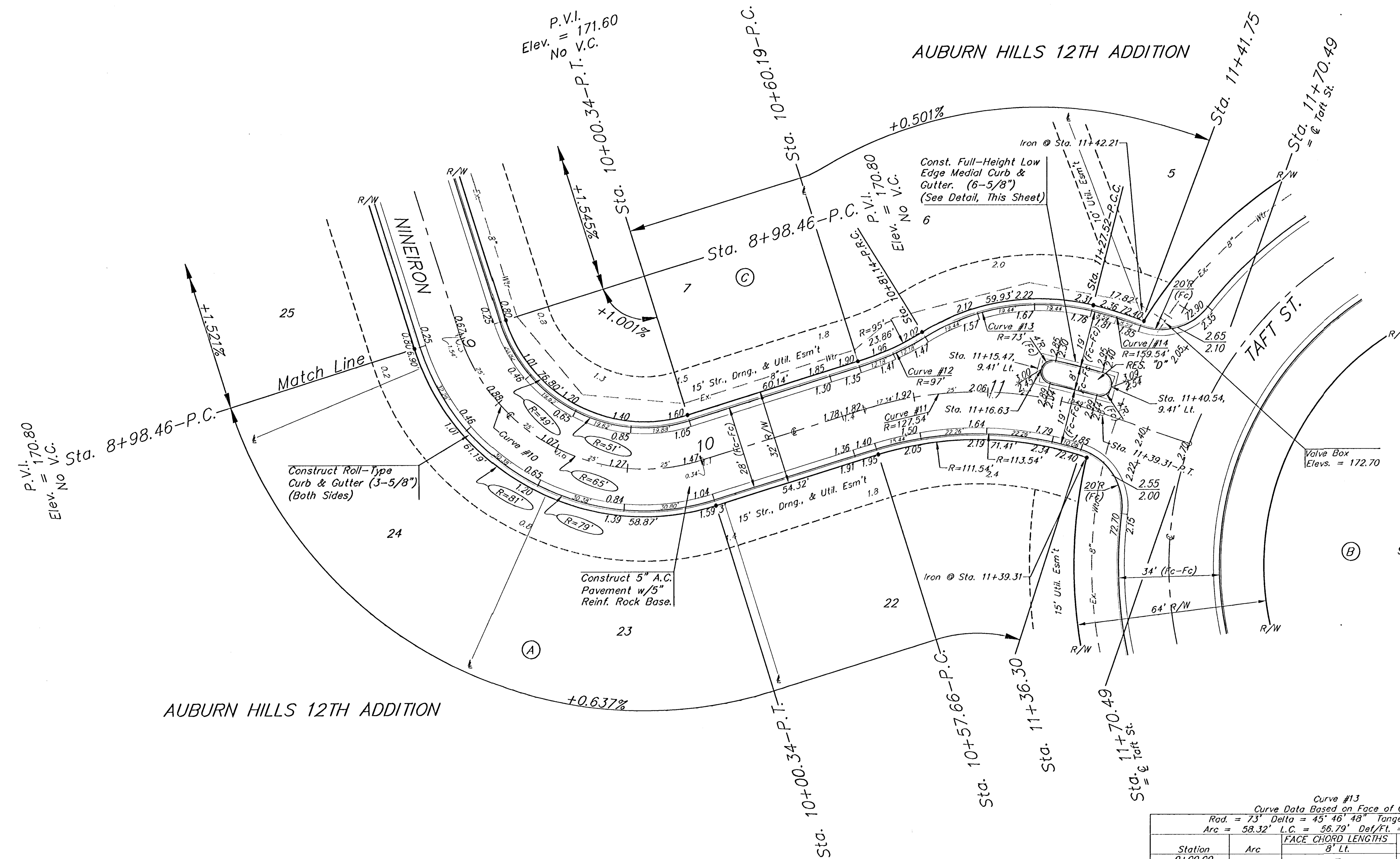

Curve #10
 Curve Data Based on Centerline
 Rad. = 65' Delta = 89° 43' 02" Tangent = 64.77'
 Arc = 101.87' L.C. = 91.76' Def/Ft. = 26.44563 Min.

Station	Arc	FACE CHORD LENGTHS		Defl.	T. Defl.
		8' Lt.	8' Rt.		
8+98.46	-	-	-	0'00"00"	0'00"00"
9+25.00	26.54'	17.44'	35.28'	11'41"52"	11'41"52"
9+50.00	25.00'	16.44'	33.26'	11'01"08"	22'43"00"
9+75.00	25.00'	16.44'	33.26'	11'01"09"	33'44"09"
10+00.33	25.33'	16.65'	33.69'	11'09"52"	44'54"01"

Curve #11
 Curve Data Based on Centerline
 Rad. = 113.54' Delta = 36° 40' 52" Tangent = 37.64'
 Arc = 78.65' L.C. = 71.45' Def/Ft. = 13.99152 Min.

Station	Arc	FACE CHORD LENGTHS		Defl.	T. Defl.
		8' Lt.	8' Rt.		
10+57.65	-	-	-	0'00"00"	0'00"00"
10+75.00	17.35'	19.13'	12.92'	4'02"45"	4'02"45"
11+00.00	25.00'	27.53'	18.60'	5'49"47"	9'52"32"
11+25.00	25.00'	27.53'	18.60'	5'49"47"	15'42"20"
11+36.30	11.30'	12.46'	8.42'	2'38"06"	18'20"26"
11+39.31	3.01'	3.32'	2.24'	0'42"07"	19'02"33"

Curve #12
 Curve Data Based on Face of Curb
 Rad. = 97' Delta = 14° 23' 29" Tangent = 12.25'
 Arc = 24.36' L.C. = 24.30' Def/Ft. = 17.72339 Min.

Station	Arc	FACE CHORD LENGTHS		Defl.	T. Defl.
		8' Lt.	8' Rt.		
10+60.19	-	-	-	0'00"00"	0'00"00"
10+71.02	12.18'	11.17'	11.17'	3'35"52"	3'35"52"
10+81.14	12.18'	11.17'	11.17'	3'35"53"	7'11"45"

Curve #13
 Curve Data Based on Face of Curb
 Rad. = 73' Delta = 45° 46' 48" Tangent = 30.82'
 Arc = 58.32' L.C. = 56.79' Def/Ft. = 23.54938 Min.

Station	Arc	FACE CHORD LENGTHS		Defl.	T. Defl.
		8' Lt.	8' Rt.		
0+00.00	-	-	-	0'00"00"	0'00"00"
0+19.44	19.44'	21.51'	21.51'	7'37"48"	7'37"48"
0+38.88	19.44'	21.51'	21.51'	7'37"48"	15'15"36"
0+58.32	19.44'	21.51'	21.51'	7'37"48"	22'53"24"

Curve #14
 Curve Data Based on Centerline
 Rad. = 159.54' Delta = 6° 10' 09" Tangent = 8.60'
 Arc = 17.18' L.C. = 17.17' Def/Ft. = 10.77270 Min.

Station	Arc	FACE CHORD LENGTHS		Defl.	T. Defl.
		8' Lt.	8' Rt.		
0+00.00	-	-	-	0'00"00"	0'00"00"
0+08.59	8.59'	9.02'	9.02'	1'32"32"	1'32"32"
0+17.18	8.59'	9.02'	9.02'	1'32"33"	3'05"05"

Roll type curb & gutter to be constructed on the pavement on this sheet. Top of curb elevation are given for full height curb.

AUBURN HILLS ADDITION - PHASE I
NINEIRON
 STA. 8+98.48 TO STA. 11+70.49

BAUGHMAN COMPANY P.A.
 ENGINEERING, SURVEYING, & PLANNING
 318-262-7271 • 315 ELLIS • WICHITA, KANSAS 67211

PROJECT NUMBER: 472-83290

DESIGN: DMV DRAWN: JAK APPROVED: DATE: 3-14-01 SCALE: NOTED

SHEET 16 OF 30