

BENCHMARK:  
 BM #1: "□" Cut in middle of  
 N headwall of RCBC on 21st  
 St. North. 1004.3' W & 22.1'  
 N of SE Cor., SE1/4, Sec. 2,  
 T-27-S, R-2-E.  
 Elev. = 173.23 City Datum

BM #2: "□" Cut at the SE  
 corner of the intersection of  
 Castle Rock & Castle Rock Ct.,  
 Krug North Addition.  
 Elev. = 183.50 City Datum

P.V.I. Elev. = 183.51 No V.C.  
 P.V.I. Elev. = 183.76 88' V.C.

Scale: 1" = 20'  
 • = Iron

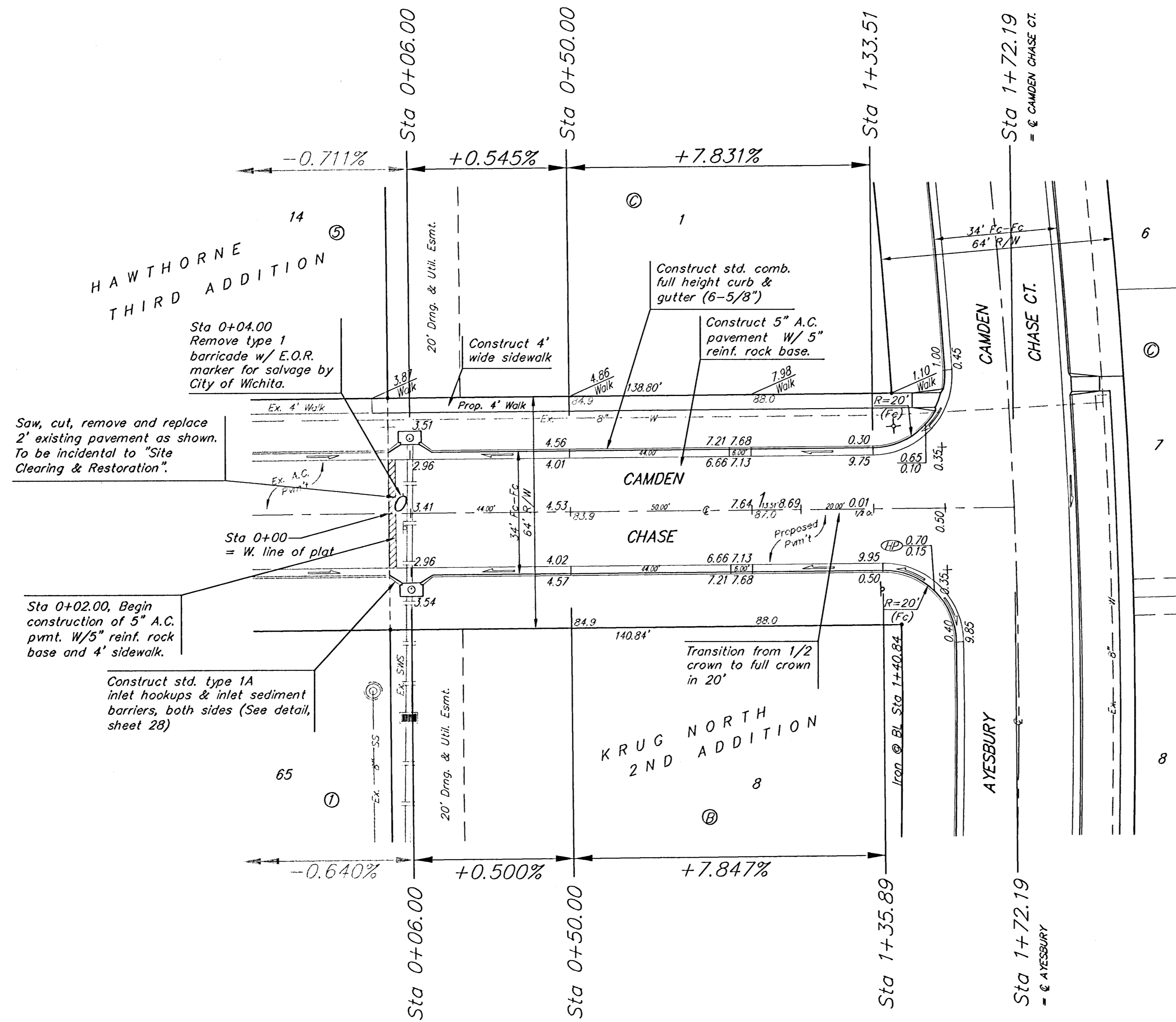

Subdivision Bench Marks		
Street & Station	Location Description	Elevation
Castle Rock 10+03.83, 17.25' Rt.	Adjacent to Fire Hydrant at N. End of N.E. Curb Return of Castle Rock & Camden Chase.	
Burning Tree 4+06.00, 17.25' Lt.	Adjacent to Fire Hydrant between Lots 21-22, Block A, Krug North Addition.	
Ayesbury 3+00.66, 17.25' Lt.	Adjacent to Fire Hydrant between Lots 8-9, Block C, Krug North 2nd Addition.	
Ayesbury Cir. 6+05.67, 14.25' Lt.	Adjacent to Fire Hydrant between Lots 35-36, Block A, Krug North 2nd Addition.	

P.V.I. Elev. = 183.54 No V.C.  
 P.V.I. Elev. = 183.76 88' V.C.

	KRUG NORTH 2ND/KRUG NORTH ADD. - PH. II <b>CAMDEN CHASE</b> STA 0+06.00 TO STA 1+72.19
	Baughman Company, P.A. 315 E. 15th St. Wichita, KS 67211 F 316-263-7111 F 316-263-0149 ENGINEERING   SURVEYING   PLANNING   LANDSCAPE ARCHITECTURE
PROJECT NUMBER 472-83974	DESIGN DRAWN TMS
REVISIONS:	APPROVED DATE 09/05
	SCALE Noted SHEET <b>13 OF 44</b>
KrugNorth2nd\Phase1\Set8 05-04-E231	