

TRACT 15 (PIN 00579550)
 PARCEL 087-041-02-0-22-01-001.00
 OWNER DANIEL A. LUKE AND MEGAN J. LUKE
 ADDRESS 14841 W 125TH ST N, SEDGWICK KS 67135
 LEGAL LOT 1, BLOCK A DEER RUN ESTATES ADD.
 DOC.#/FLM-PG: 29575294

TRACT 14 (PIN 00259196)
 PARCEL 087-041-02-0-21-00-002.00
 OWNER TERENCE F. UNRUH AND JEANETTE D. UNRUH
 ADDRESS 14611 W 125TH ST N, SEDGWICK KS 67135
 LEGAL PART OF NW/4 OF SEC. 2-T25S-R2W
 FILM-1792 PAGE-0005

✕ DENOTES PIPE TO BE ABANDONED

M27 & M28 SPUR LINE

UNLESS NOTED OTHERWISE, ELEVATIONS SHOWN ARE TOP OF WATER SUPPLY PIPE

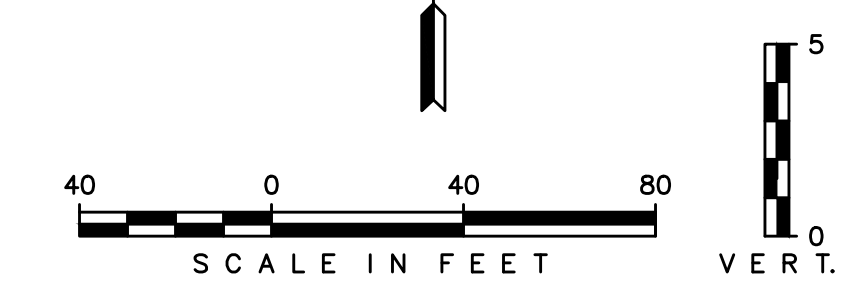
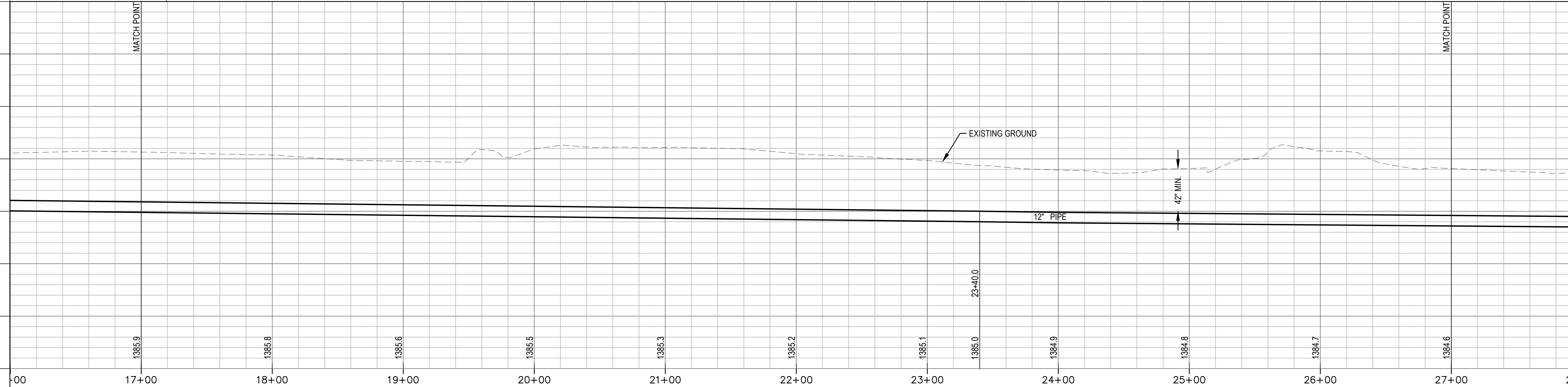

REVISIONS:

Environment & Infrastructure Solutions, Inc.
 245 N. WACO AVENUE, SUITE 110
 WICHITA, KANSAS 67202
 PHONE: 316-448-2711
 FAX: 316-448-2711



M27 & M28 SPURLINE(2)

EQUUS WELLFIELD SPURLINE REPLACEMENT
 GARY JANZEN, P.E. - CITY ENGINEER
 CITY OF WICHITA

DESIGNED BY: EJB
 DRAWN BY: JAN
 CHECKED BY: ---
 DATE: MAY 24, 2022

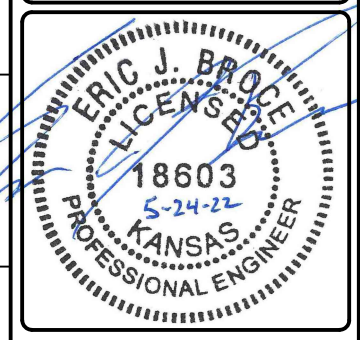

PROJECT NO.
639020

SHEET NO.
07
OF 35

Last saved by: alex.mckean - Plotted By: Mckean, Alex Plot Date/Time: 5/24/2022 1:25 PM
 File: L:\8275000373 Wichita Spurline\05 CAD\Sheets\Bid Package 3\M27-2.dwg