

✕ DENOTES PIPE TO BE ABANDONED

M27 & M28 SPUR LINE

UNLESS NOTED OTHERWISE, ELEVATIONS SHOWN ARE TOP OF WATER SUPPLY PIPE

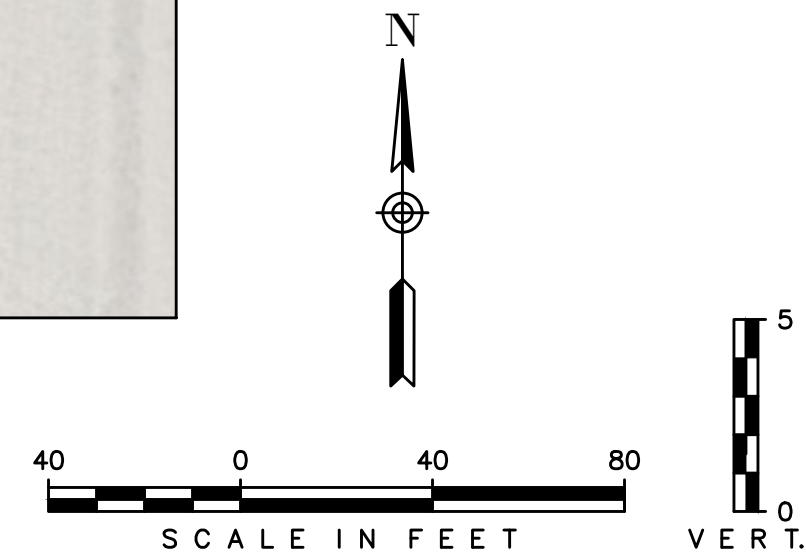
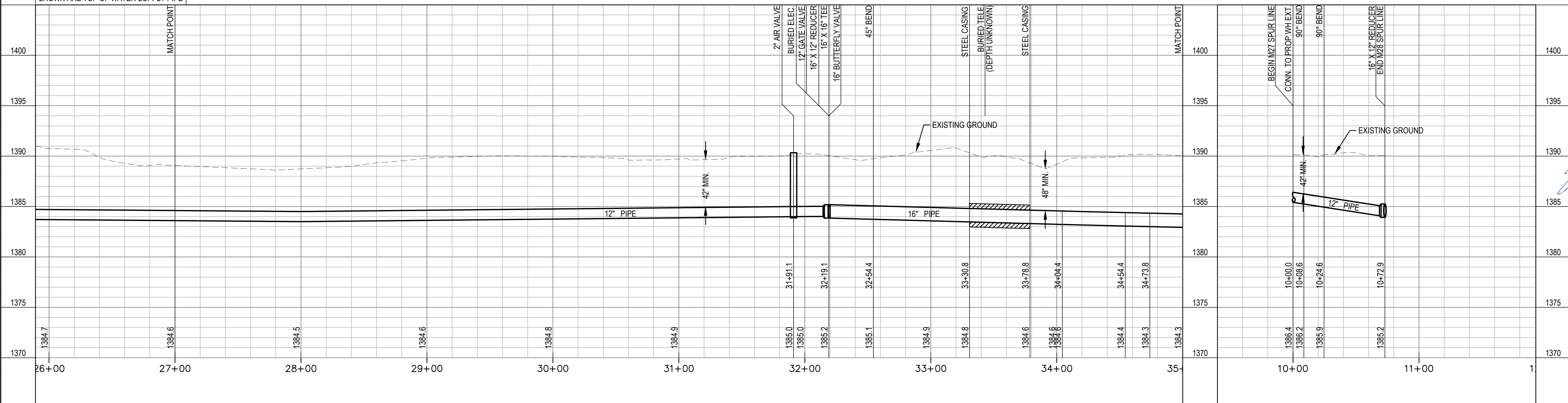

Environment & Infrastructure Solutions, Inc.
 245 N. WACO AVENUE, SUITE 110
 WICHITA, KANSAS 67202
 PHONE: 316-448-2711
 FAX: 316-448-2711



M27 & M28 SPURLINE(3)
 EQUUS WELLFIELD SPURLINE REPLACEMENT
 GARY JANZEN, P.E. - CITY ENGINEER
 CITY OF WICHITA

DESIGNED BY: EJB
 DRAWN BY: JAN
 CHECKED BY: ---
 DATE: MAY 24, 2022

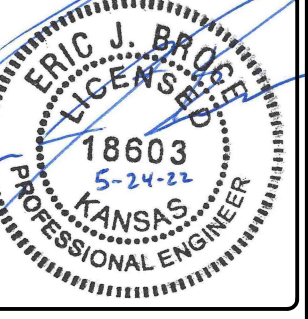

PROJECT NO.
639020

SHEET NO.
08
OF 35

REVISIONS: