

BENCHMARKS:
BM-1#:
 SQUARE CUT ON TOP OF CURB 118.3± N.
 6.4± W. OF SE. COR., LOT 7, BLOCK 2,
 TURTLE RUN 3RD ADDITION.
 ELEV. = 1390.32 NAVD88

BM-2#:
 SQUARE CUT ON TOP OF CURB 118.4± N.
 OF SE. COR., LOT 6, BLOCK 2, TURTLE
 RUN 2ND ADDITION.
 ELEV. = 1391.04 NAVD88

Construct 65' Deep Building Pad on All Lots except Lots 9-12
 and 21-24, Block F. Construct 50' Deep Building Pad on Lots
 9-12 and 21-24, Block F. Construct mass grading surface to top
 of dirt as shown. Add a 10" layer of LVC material as
 recommended on Page 6 of the Geotechnical Report. Contractor
 shall import 15,708 C.Y. of LVC at a (PI 10-20) for building pads.

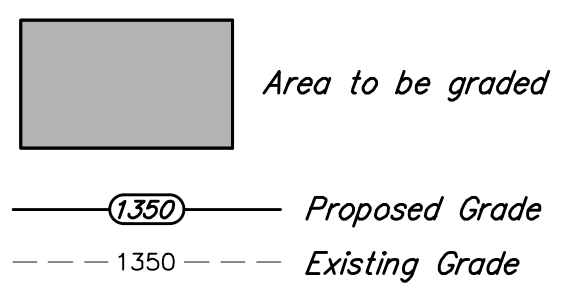
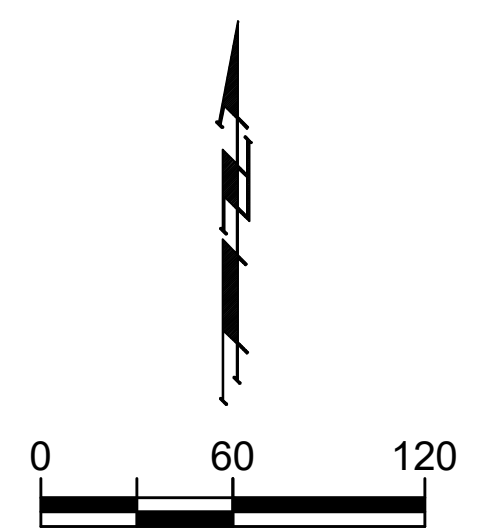

⊗ - Compaction Testin Location

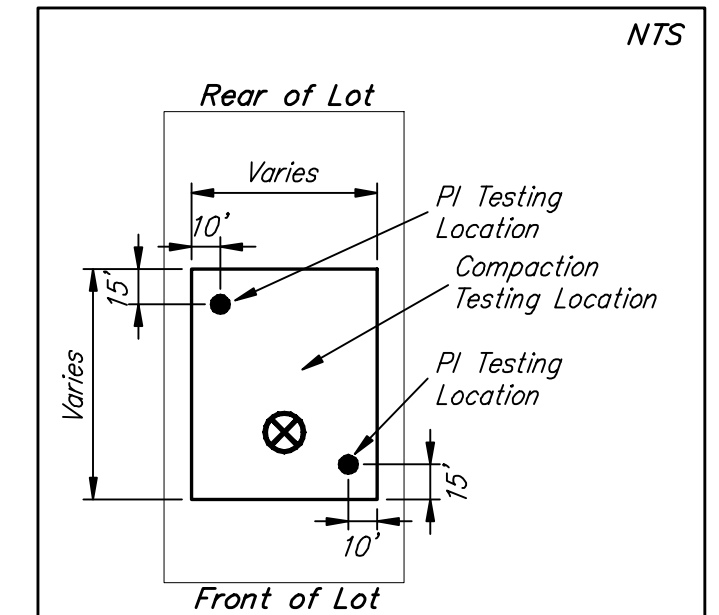

BUILDING PAD DETAIL
 Note: Construct 10" layer of LVC
 material as recommended on page
 6 of the Geotechnical Report.

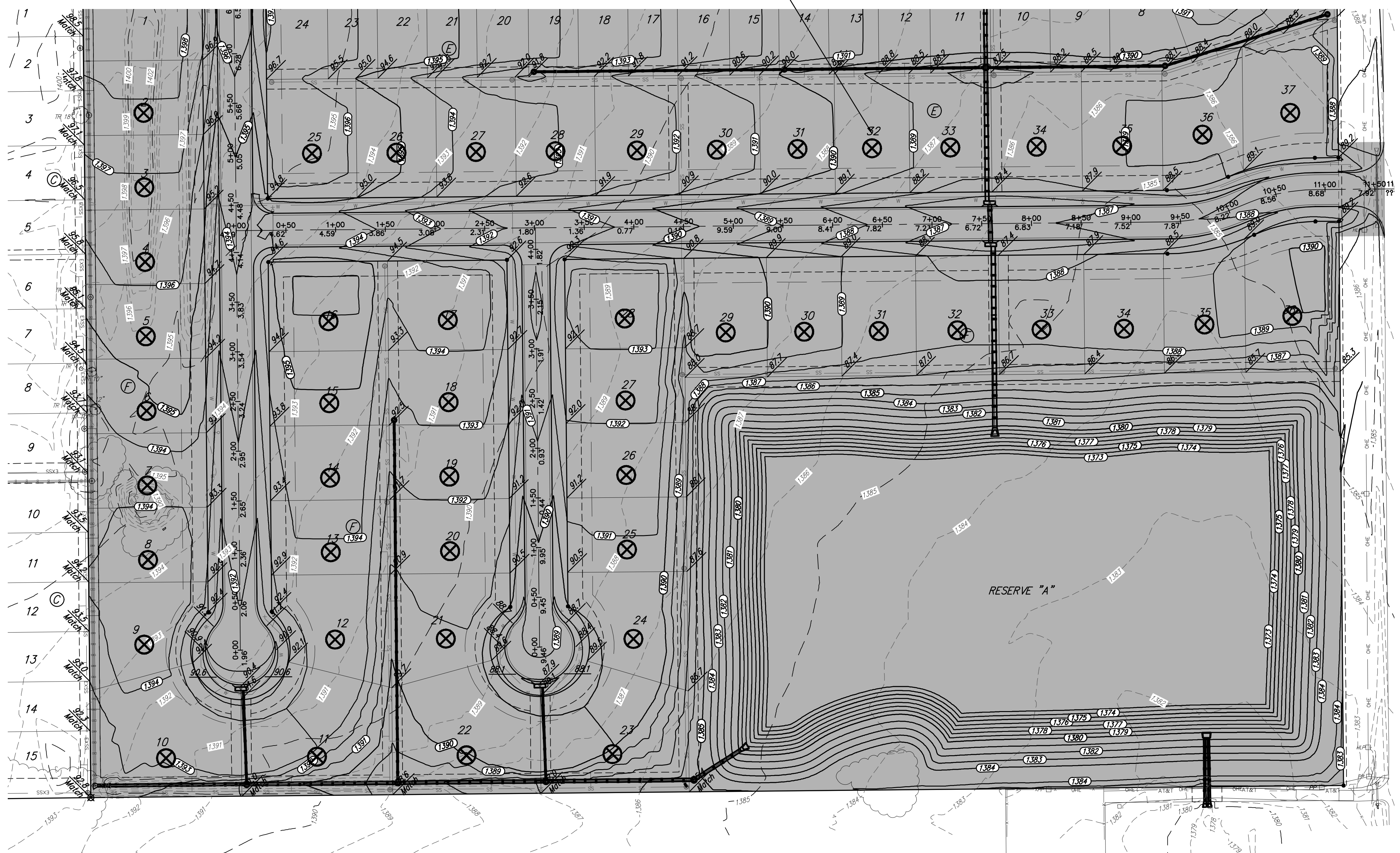

The Contractor shall be responsible to collect soil samples from two locations within each lot. The soil samples are to come from the diagonal corners of the building pads as shown on this sheet. The samples shall be collected at a depth of 18" below the pad elevation listed on this sheet. Each soil sample shall be approximately 8 oz. to 12 oz. in weight and sealed in a zip-lock plastic bag. The soil samples shall be used for Atterberg Limits testing (ASTM D4318, "liquid Limit, Plastic Limit, and Plasticity Index of Soils") to determine the PI (Plasticity Index) of the sample. The Contractor shall deliver the soil samples to a licensed soils testing laboratory for Atterberg Limits testing. The test results shall be delivered to the Project Engineer as the tests are completed. The Contractor shall be responsible for all costs associated with collecting soil, refilling the test holes, labeling the soil samples, transporting the soil, costs of testing, and delivering the test results. All costs associated with the Atterberg Limits testing are to be included in the bid item, "Testing". There are 123 lots (1 building pad per lot) to be tested at two locations for a total of 246 tests.

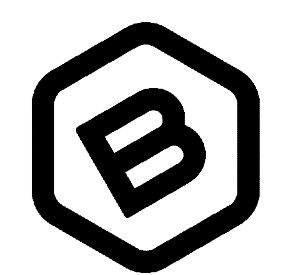

**BAUGHMAN
 COMPANY**

315 Ellis St.
 Wichita, KS 67211
 316-262-7271
 BaughmanCo.com

TOWNE PARC 10TH
 ADDITION

**MASS
 GRADING/
 EROSION
 CONTROL**
 STORM WATER DRAIN
 IMPROVEMENTS

PROJECT NUMBER:
 468-2023-085536

DESIGN: NBW DRAWN: JLD

DATE: June 22, 2023

SHEET OF
20R 37

Adjusted Surface From Bottom of LVC to Top of LVC

File: E:\Projects\Towne Parc 10th Addition_22-01-P743\Engineering\PHASE 1\SWD_22-11-E332\SW5-SWD.dwg