

**BENCHMARK:**  
 City of Wichita benchmark at the SE corner of intersection of 135th Street West and 13th Street North.  
 Elev. = 167.83 (City Datum)

Brass Benchmark Disc  
 Adjacent to Fire Hydrant at E. End of E. Curb Return of Ponderosa & Ponderosa Ct.  
 Elev. = 170.96 (City Datum)

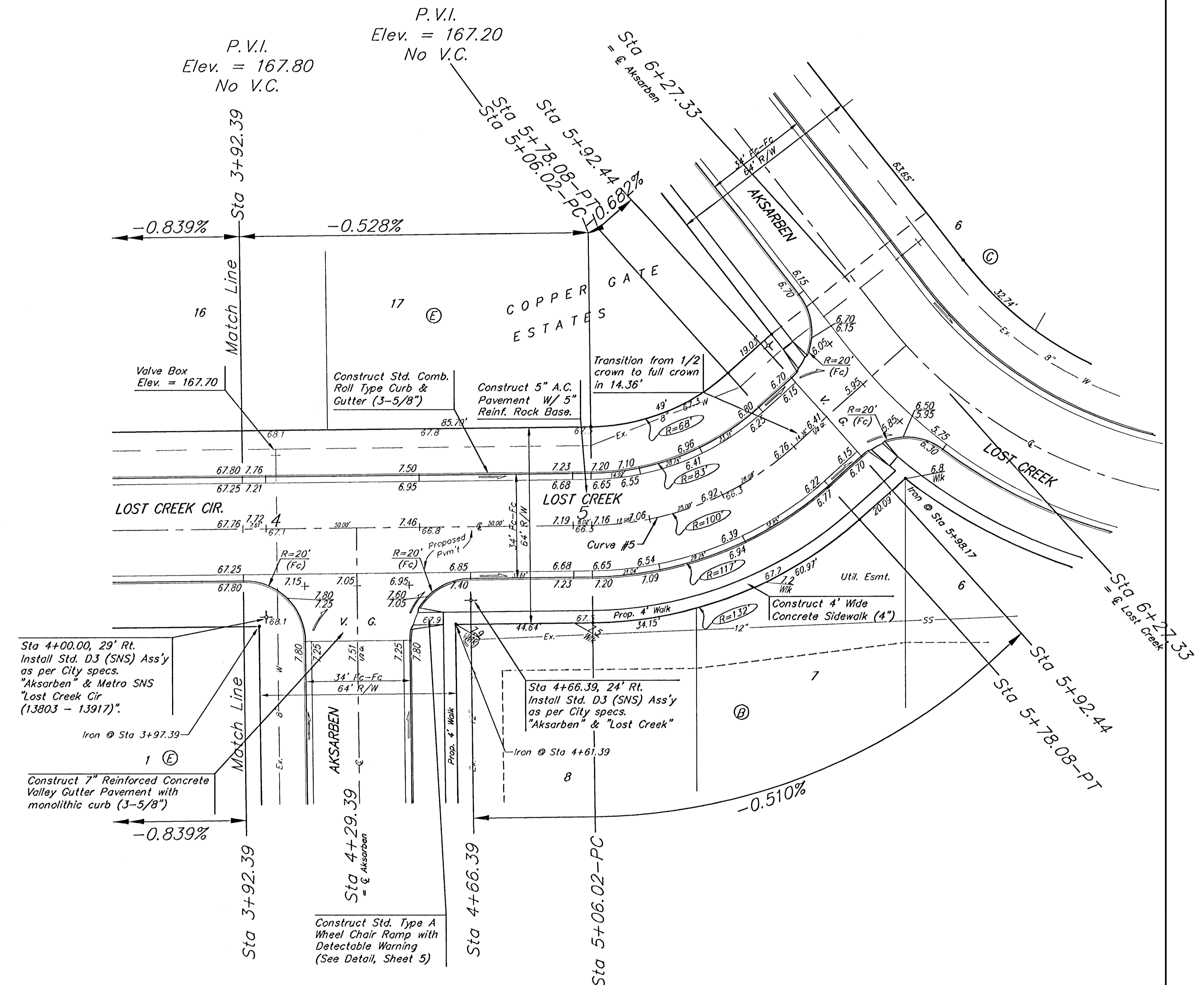
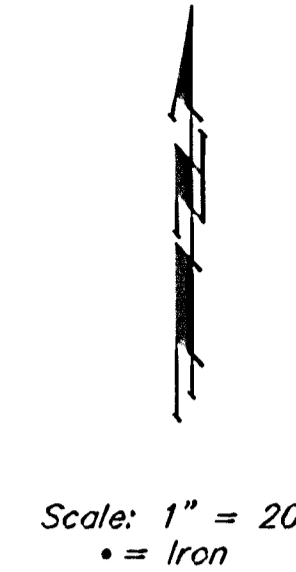

Sta 4+00.00, 29' Rt.  
 Install Std. D3 (SNS) Assy as per City specs. "Aksarben" & Metro SNS "Lost Creek Cir (13803 - 13917)".

Sta 4+66.39, 24' Rt.  
 Install Std. D3 (SNS) Assy as per City specs. "Aksarben" & "Lost Creek"

Curve #5  
 Curve Data Based on Centerline  
 Rad. = 100', Delta = 41° 17' 06", Tangent = 37.67'  
 Arc = 72.06', L.C. = 70.51', Del/Ft. = 17.18776 Min.

Station	Arc	FACE CHORD LENGTHS		Del.	T. Del.
		B' Lt.	B' Rt.		
5+06.02	-	-	-	0'00'00"	0'00'00"
5+25.00	18.98'	14.21'	23.69'	5'26'13"	5'26'13"
5+50.00	25.00'	18.70'	31.17'	7'09'42"	12'35'55"
5+75.00	25.00'	18.70'	31.17'	7'09'42"	19'43'57"
5+78.08	3.08'	2.31'	3.85'	0'52'56"	20'38'53"

**NOTE:** ROLL TYPE CURB & GUTTER TO BE CONSTRUCTED ON THE PAVEMENT SHOWN ON THIS SHEET. TOP OF CURB ELEVATIONS ARE GIVEN FOR FULL HEIGHT CURB.

<b>Baughman</b>		Copper Gate Estates - Phase III	
		<b>LOST CREEK CIR.</b>	
		STA 4+66.39 TO STA 6+27.33	
Baughman Company, P.A. 315 Ellis St. Wichita, KS 67211 P 316-262-2111 F 316-262-0149			
ENGINEERING   SURVEYING   PLANNING   LANDSCAPE ARCHITECTURE			
PROJECT NUMBER 472-83671	DESIGN TMS	DRAWN TMS	DATE 4/13/05
REVISIONS:	APPROVED		
	SCALE Noted		
	SHEET <b>13 OF 30</b>		
CopperGatePhase3\Sub8.dwg		0406E956	