

FHWA REG. NO.	STATE	PROJECT NO.	YEAR	SHEET NO.	SHEETS
7	KANSAS	87N 0064-01	1997	27	130

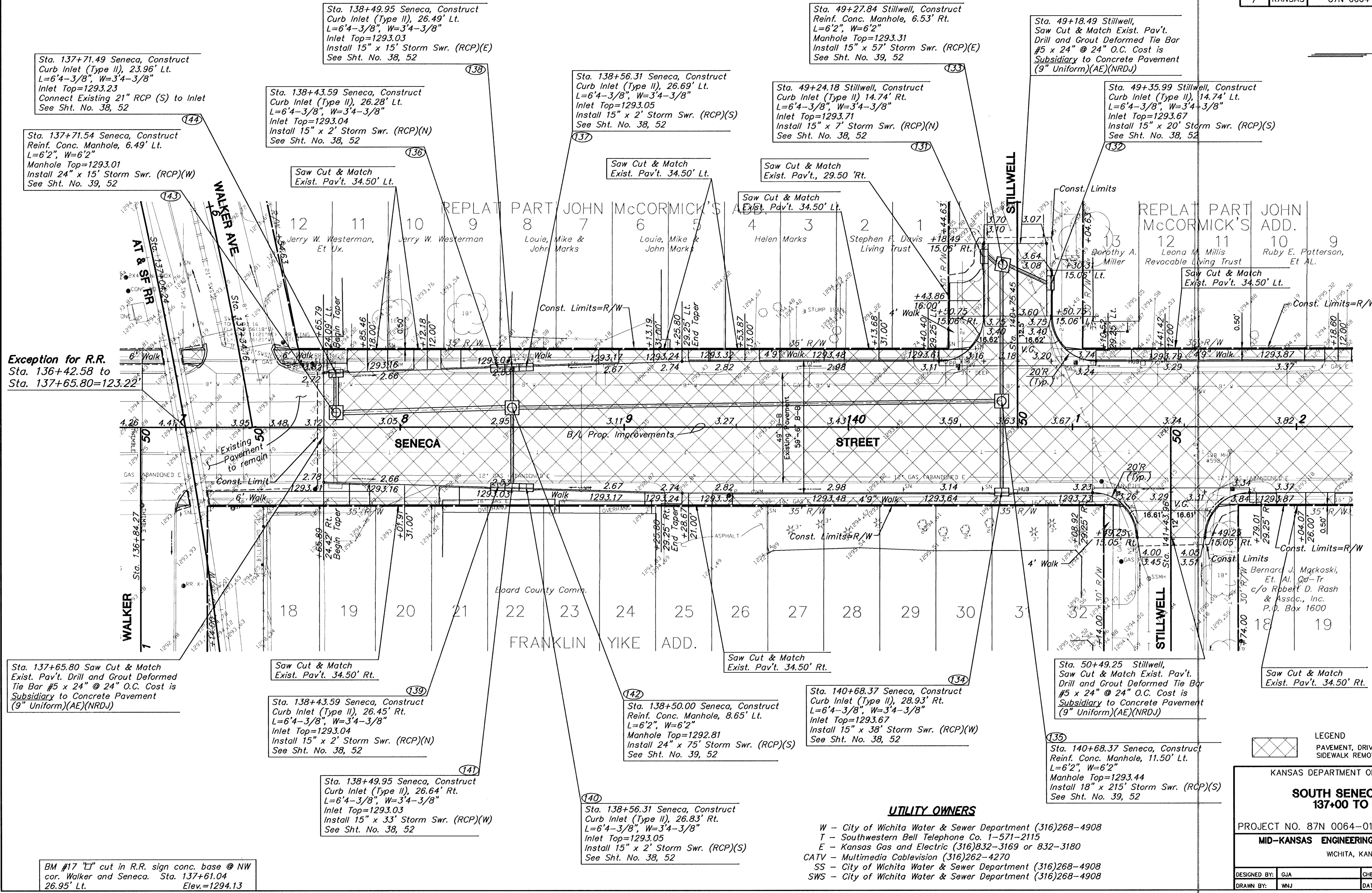

Exception for R.R.
Sta. 136+42.58 to
Sta. 137+65.80=123.22'

Sta. 137+65.80 Saw Cut & Match
Exist. Pav't. Drill and Grout Deformed
Tie Bar #5 x 24" @ 24" O.C. Cost is
Subsidiary to Concrete Pavement
(9" Uniform)(AE)(NRDJ)

Sta. 138+43.59 Seneca, Construct
Curb Inlet (Type II), 26.45' Rt.
L=6'4-3/8", W=3'4-3/8"
Inlet Top=1293.04
Install 15" x 2' Storm Swr. (RCP)(N)
See Sht. No. 38, 52

Sta. 138+49.95 Seneca, Construct
Curb Inlet (Type II), 26.64' Rt.
L=6'4-3/8", W=3'4-3/8"
Inlet Top=1293.03
Install 15" x 33' Storm Swr. (RCP)(W)
See Sht. No. 38, 52

Sta. 138+50.00 Seneca, Construct
Reinf. Conc. Manhole, 8.65' Lt.
L=6'2", W=6'2"
Manhole Top=1292.81
Install 24" x 75' Storm Swr. (RCP)(S)
See Sht. No. 39, 52

Sta. 140+68.37 Seneca, Construct
Curb Inlet (Type II), 28.93' Rt.
L=6'4-3/8", W=3'4-3/8"
Inlet Top=1293.67
Install 15" x 38' Storm Swr. (RCP)(W)
See Sht. No. 38, 52

UTILITY OWNERS

- W - City of Wichita Water & Sewer Department (316)268-4908
- T - Southwestern Bell Telephone Co. 1-571-2115
- E - Kansas Gas and Electric (316)832-3169 or 832-3180
- CATV - Multimedia Cablevision (316)262-4270
- SS - City of Wichita Water & Sewer Department (316)268-4908
- SWS - City of Wichita Water & Sewer Department (316)268-4908

LEGEND
PAVEMENT, DRIVEWAY AND/OR
SIDEWALK REMOVAL.

KANSAS DEPARTMENT OF TRANSPORTATION

**SOUTH SENECA STREET
137+00 TO 142+00**

PROJECT NO. 87N 0064-01 SEDGWICK CO.

MID-KANSAS ENGINEERING CONSULTANTS, INC.
WICHITA, KANSAS

DESIGNED BY: GJA	CHECKED BY: GJA
DRAWN BY: WNJ	DATE: 12/94 SHEET 27 OF 130

H:\CIVIL\SENECA\840065\PAVE\84006527.FCT May 30 11:13:26 1997

84006527