

Subdivision Bench Marks

No.	Street and Station	From CL	Description	Elevation
2	Stafford, Sta. 5+87.29	17.0' Rt.	N.E. End of Curb Return Intersection of Stafford and Stafford Ct. (E)	

Curve 2  
Curve Data Based on Cantarline  
Rad = 83.12' Delta = 90°00'00" Tangent = 83.12'  
Arc = 130.24' L.C. = 117.55' Def/Ft. = 20.73096 Min.

Station	Arc	FACE CHORD LENGTHS		Defl.	T. Defl.
		B LL	B RL		
4+57.49	-	-	-	0°00'00"	0°00'00"
4+75.00	17.51'	12.25'	22.79'	6°02'50"	6°02'50"
5+00.00	25.00'	17.46'	32.48'	8°38'16"	14°41'16"
5+25.00	25.00'	17.46'	32.48'	8°38'16"	23°19'33"
5+50.00	25.00'	17.46'	32.48'	8°38'16"	31°57'49"
5+75.00	25.00'	17.46'	32.48'	8°38'16"	40°36'05"
6+00.00	25.00'	17.46'	32.48'	8°38'16"	49°14'22"
6+14.13	14.13'	9.89'	18.40'	4°52'56"	54°07'18"



SCALE 1" = 20'  
IRON = •

NOTE: Back of sidewalk and R/W shall be 0.4' above curb from 6+75 to 8+00

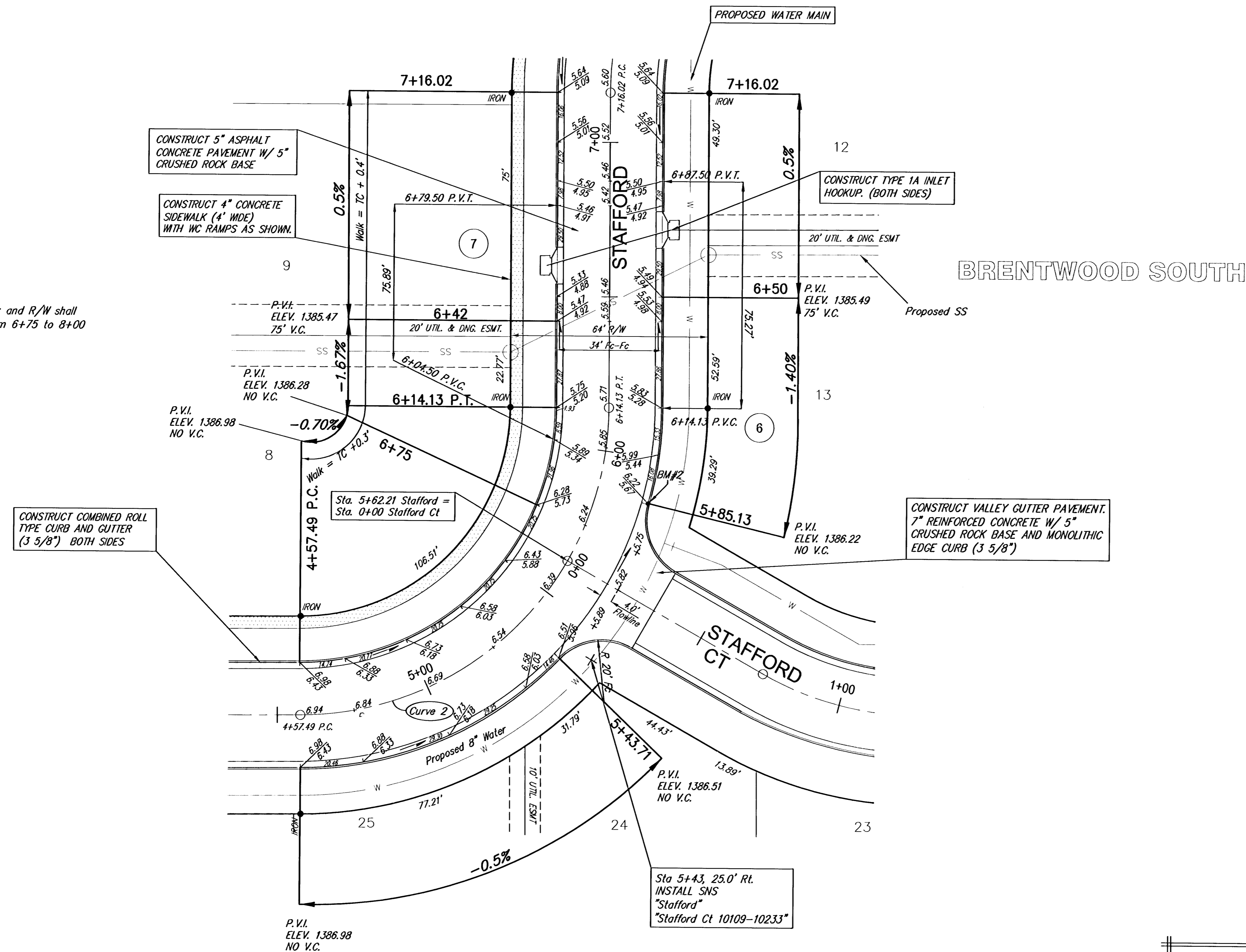

CONSTRUCT COMBINED ROLL TYPE CURB AND GUTTER (3 5/8") BOTH SIDES

CONSTRUCT 5" ASPHALT CONCRETE PAVEMENT W/ 5" CRUSHED ROCK BASE

CONSTRUCT 4" CONCRETE SIDEWALK (4' WIDE) WITH WC RAMPS AS SHOWN.

CONSTRUCT VALLEY GUTTER PAVEMENT, 7" REINFORCED CONCRETE W/ 5" CRUSHED ROCK BASE AND MONOLITHIC EDGE CURB (3 5/8")

Sta 5+43, 25.0' Rt. INSTALL SMS "Stafford" "Stafford Ct 10109-10233"

NOTE: ROLL TYPE CURB AND GUTTER TO BE CONSTRUCTED ALONG PAVEMENT DEPICTED ON THIS SHEET

Brentwood South Addition, Paving Improvements  
Kinkaid Circle  
WICHITA, KANSAS

	Ruggles & Bohm, P.A. Engineering, Surveying, Land Planning		DESIGN KWL
	924 North Main Wichita, Kansas 67203 www.rbkansas.com		(316) 284-8008 (316) 284-4621 fax E-mail: info@rbkansas.com
DRAWING FILE paving {Stafford (2)}	PROJECT NUMBER 472-84270	DATE Sept. 13, 2005	DRAWN RLS REVIEW UTILITY SHEET 6 OF 30