

Curve 5
Curve Data Based on Centerline
Rad. = 100' Delta = 90°00'00" Tangent = 100.00'
Arc = 52.36' L.C. = 141.42' Del/FL = 51.56608 Min.

Station	Arc	FACE CHORD LENGTHS		
		8 Lt.	8 Rt.	T. Del.
0+73.21	-	-	-	0'00"00"
0+75.00	1.79'	6.71'	4.03'	1'32"18"
1+00.00	25.00'	91.57'	54.94'	2'29"09"
1+25.56	25.56'	93.52'	56.11'	2'58"02"

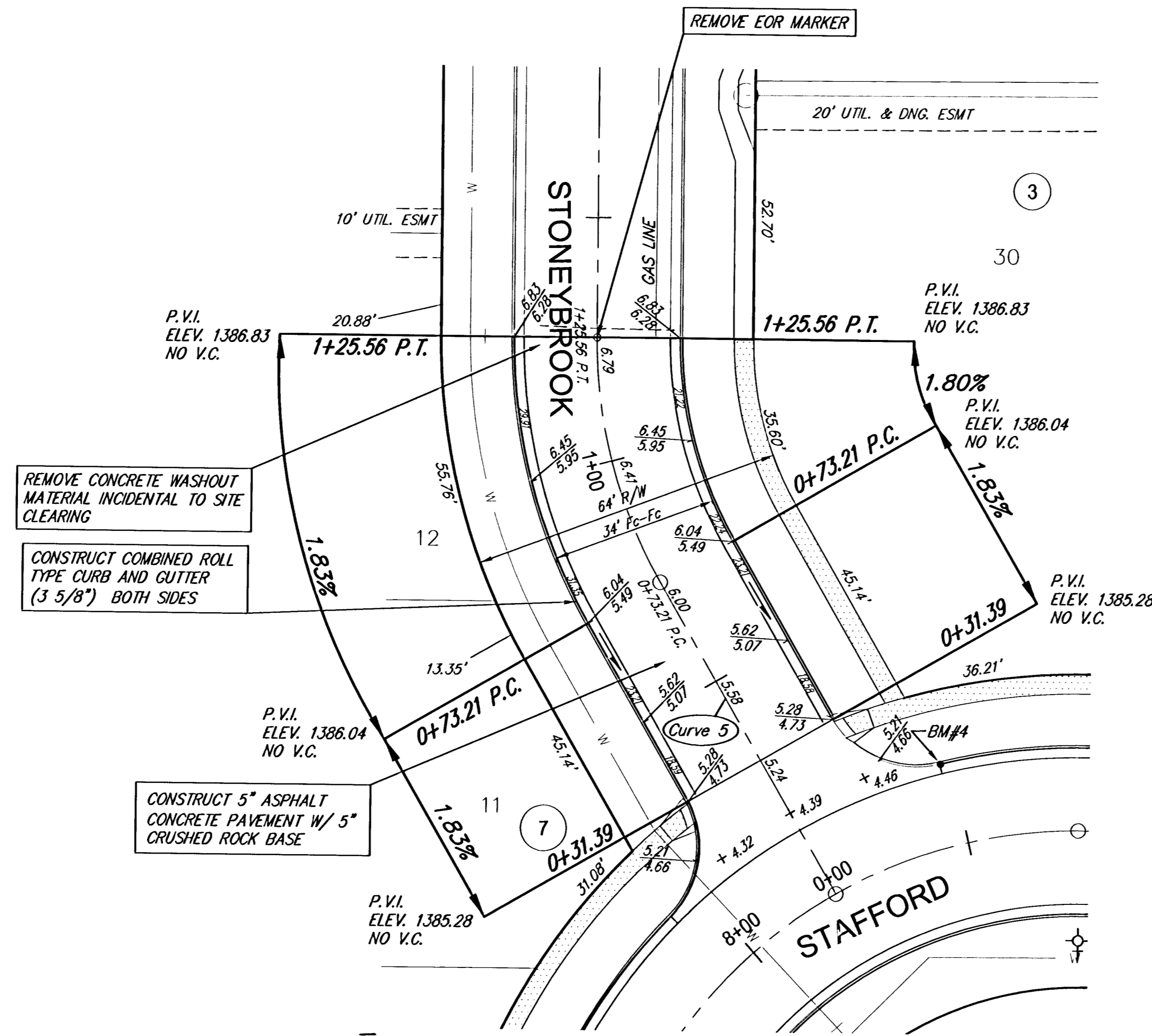

BRENTWOOD SOUTH



SCALE 1" = 20'
IRON = •

NOTE: ROLL TYPE CURB AND GUTTER TO BE CONSTRUCTED ALONG PAVEMENT DEPICTED ON THIS SHEET

**Brentwood South Addition, Paving Improvements
Stoneybrook Court (East)
WICHITA, KANSAS**

Ruggles & Bohm, P.A.
Engineering, Surveying, Land Planning

924 North Main (316) 264-8008
Wichita, Kansas 67203 (316) 264-4621 fax
www.rbkansas.com E-mail: info@rbkansas.com

 <small>RUGGLES & BOHM WICHITA, KANSAS</small>	DESIGN	KWL	SHEET 10 OF 30
	DRAWN	RLS	
REVIEW			
UTILITY			
DRAWING FILE	PROJECT NUMBER	DATE	
paving [Stoneybrook]	472-84270	Sept. 13, 2005	