

Benchmarks:

BM #1: Small RR spike in 2nd PP north of K-42 Highway, west side of Maize
Elev. = 143.61 (City Datum)

BM #2: Small RR spike in PP east of East 1/4 Corner (G)
Elev. = 147.00 (City Datum)

BM #3: "□" Top Headwall southeast corner K-42 Highway and Maize (County BM with City Datum)
Elev. = 144.04 (City Datum)

Existing 8" San. Sewer

Existing Ditch to be filled in only after SWS Line 1 & SWS Line 1A are complete.



Scale: 1" = 60'

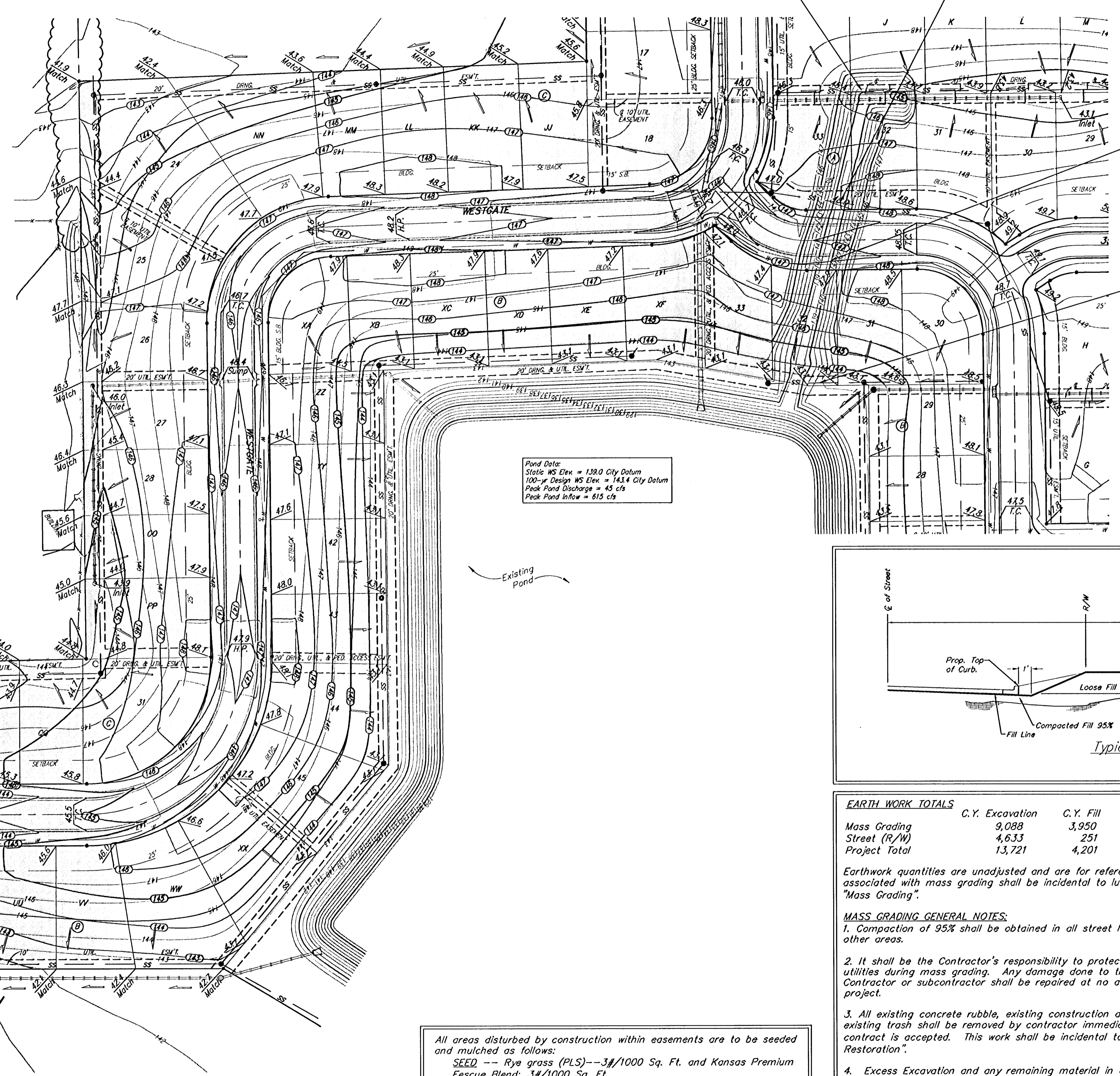

Contractor to grade along existing K-42 Drive. Cut small V-Ditch (6"-12" deep) along northerly edge of asphalt.

Pond Data:
State WS Elev = 139.0 City Datum
100-yr Design WS Elev = 143.4 City Datum
Peak Pond Discharge = 45 cfs
Peak Pond Inflow = 615 cfs

Existing pond

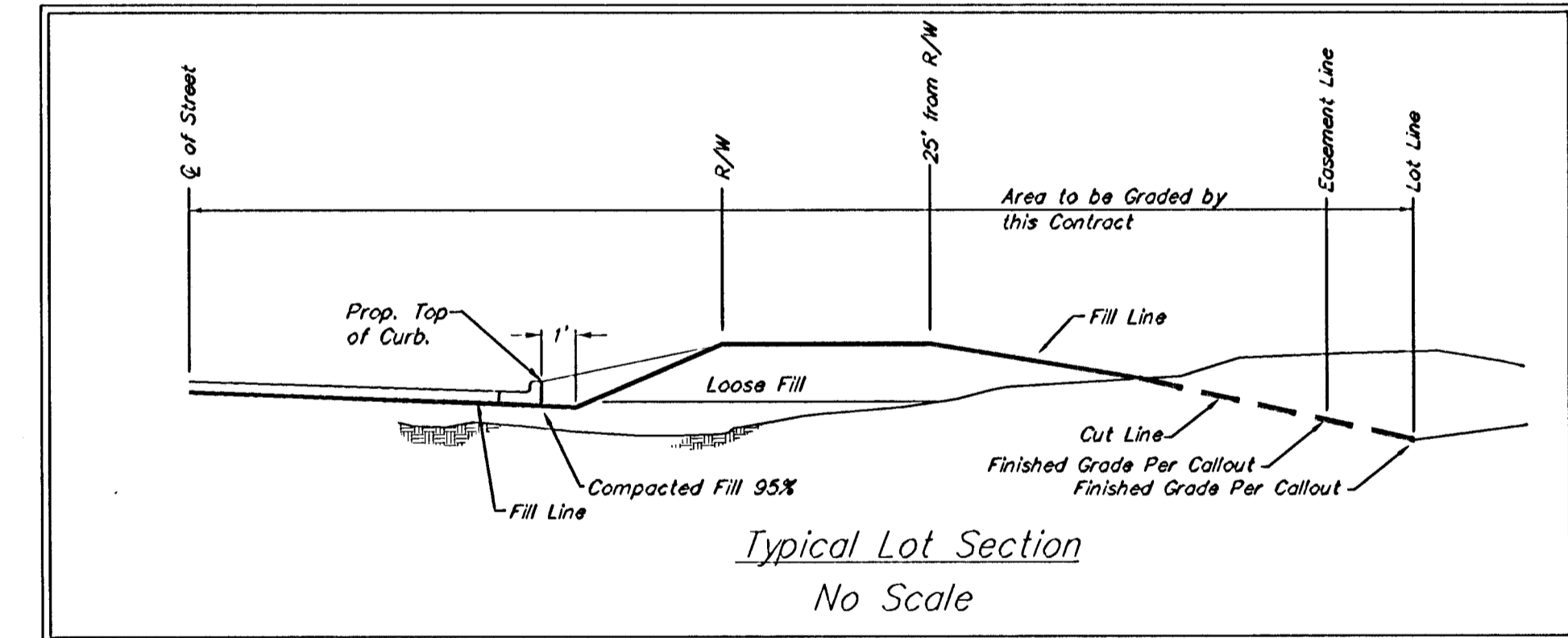

EARTH WORK TOTALS

	C.Y. Excavation	C.Y. Fill	C.Y. Compacted Fill
Mass Grading	9,088	3,950	N/A
Street (R/W)	4,633	251	690
Project Total	13,721	4,201	690

Earthwork quantities are unadjusted and are for reference only. All cost associated with mass grading shall be incidental to lump sum bid item "Mass Grading".

- MASS GRADING GENERAL NOTES:**
1. Compaction of 95% shall be obtained in all street R/Ws, 90% in all other areas.
 2. It shall be the Contractor's responsibility to protect any existing utilities during mass grading. Any damage done to these systems by Contractor or subcontractor shall be repaired at no additional cost to the project.
 3. All existing concrete rubble, existing construction debris, and all other existing trash shall be removed by contractor immediately after the Restoration is accepted. This work shall be incidental to "Site Clearing & Restoration".
 4. Excess Excavation and any remaining material in existing stockpile shall remain on site and be spread evenly on lots outside of street R/Ws and back lot easements.

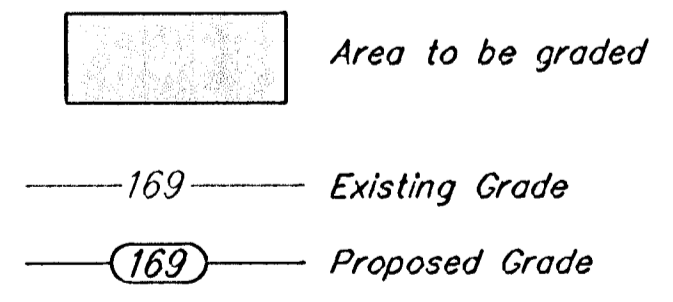

All areas disturbed by construction within easements are to be seeded and mulched as follows:
SEED -- Rye grass (PLS)--3#/1000 Sq. Ft. and Kansas Premium Fescue Blend; 3#/1000 Sq. Ft.
FERTILIZER -- 10-20-10 Ratio or 12-24-12 Ratio at 350 Lbs./Ac.
MULCH -- 2 Tons Prairie Hay / Acre

Harvest Ridge Addition - Phase II

Mass Grading

Baughman

Baughman Company, P.A. 315 Ellis St., Waltham, MA 02154 F31532-2111 F31532-2110
ENGINEERING | SURVEYING | PLANNING | LANDSCAPE ARCHITECTURE

PROJECT NUMBER 472-83805	DESIGN MWS/JAK	DRAWN JAK
REVISIONS:	APPROVED MWS	DATE 4/12/06

SCALE
1" = 60'
SHEET
17 OF 34

Harvest Ridge\Phase II\mass grade.dwg