

PLANTING PLAN FOR
**29TH. STREET NORTH FROM
 ROCK ROAD TO WEBB ROAD**

FEDERAL AID PROJECT
 WICHITA, SEDGWICK COUNTY KANSAS
 POPULATION 329,211

**CITY OF WICHITA PROJECT NO. 472-83519
 CITY OF WICHITA O.C.A. NO. 706841**

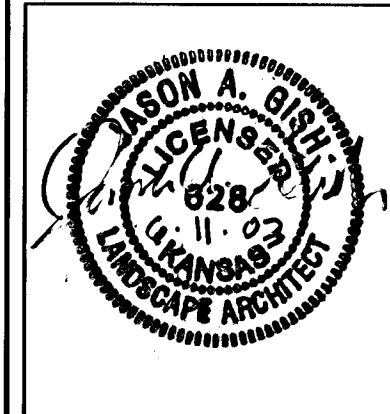

**29TH ST.
 ROCK RD. TO WEBB RD.**

TITLE PAGE

DATE	JUNE 2003
REVISED	

DESIGN BY	BJH
DRAWN BY	BJH
CHECKED BY	JAG

SHEET NUMBER
1 of 14

GENERAL NOTES:

- CONTRACTOR SHOULD MAKE THEMSELVES FAMILIAR WITH THE PLANS, SUPPLEMENTAL SPECIFICATIONS, AND ALL NOTES BEFORE BIDDING THIS PROJECT. C.O.W. SPECIFICATIONS SHALL APPLY. THE SUPPLEMENTAL SPECIFICATIONS, NOTES, & DETAILS IN THESE PLANS SHALL TAKE PRECEDENCE OVER C.O.W. SPECIFICATIONS WHEN IN CONFLICT.
- THE LANDSCAPE CONTRACTOR IS TO VERIFY THE LOCATION OF ALL UNDERGROUND UTILITIES (INCLUDING THOSE INDICATED ON THE PLAN) PRIOR TO INSTALLATION OF PLANT MATERIAL. UTILITIES CAN BE FLAGGED BY CALLING 687-2470.
- ON THIS STREET PROJECT, NEW SOD MAY ALREADY BE IN PLACE WHERE TREE PLANTINGS ARE DIRECTED. IF DAMAGE OCCURS THE CONTRACTOR SHALL REGRADE AND REPLACE WITH LIKE SOD TO THE LANDSCAPE ARCHITECT'S SATISFACTION (REPAIR ALL DAMAGED AREAS TO ORIGINAL CONDITION).
- PLANTING DATES FOR PLANT MATERIAL SHALL BE DURING THE MONTHS BETWEEN OCTOBER 1st AND MAY 15th. PLANTING SHALL ONLY BE CONDUCTED WHEN THE GROUND IS NOT FROZEN, SNOW COVERED, OR IN AN OTHERWISE UNSUITABLE CONDITION FOR PLANTING. DEVIATION FROM THE ABOVE PLANTING DATES WILL ONLY BE PERMITTED WITH APPROVAL FROM THE LANDSCAPE ARCHITECT.
- THE PLANTING SOIL MIXTURE FOR ALL TREE PLANTINGS SHALL BE SOIL EXCAVATED FROM THE HOLE.
- ROOT STIMULATOR SHALL BE APPLIED TO ALL PLANT MATERIALS WITH THE EXCEPTION OF LAWN AREAS. TREES: "MYCOR TREE SAVER TRANSPLANT" MANUFACTURED BY PLANT HEALTH CARE INC. SHRUBS AND PERENNIAL PLANTING BEDS: "MYCOR 4-7-4 PLANT SAVER" MANUFACTURED BY PLANT HEALTH CARE, INC. 440 WILLIAMSPORT, PITTSBURGH, PA 15238 (800) 421-9051. APPLY AS PER THE MANUFACTURERS RECOMMENDATIONS.
- ALL TREE SAUCERS AND PLANTING BEDS ARE TO BE MULCHED WITH A MINIMUM OF 3" FINE SHREDDED DARK HARDWOOD MULCH OR CYPRESS MULCH. MULCH SHALL BE APPROVED BY LANDSCAPE ARCHITECT. SUBMIT SAMPLE IN LARGE SEALABLE PLASTIC BAG TO OFFICE OF THE L.A. WHERE PLANTING BEDS MAY BE ADJACENT TO WALKS AND CURBS THE SOIL LEVEL SHALL BE 3" LOWER TO ALLOW FOR MULCH LAYER.
- MULCH, STAKES, GUY WIRE, ROOT STIMULATOR, ETC. SHALL BE SUBSIDIARY TO INDIVIDUAL PLANTS.
- THE CONTRACTOR SHALL FLAG/STAKE PROPOSED PLANT LOCATIONS & BEDS AND GAIN APPROVAL OF LOCATIONS FROM LANDSCAPE ARCHITECT PRIOR TO BRINGING PLANTS TO THE SITE. THE CONTRACTOR SHALL USE A MEASURING TAPE TO ACCURATELY MARK PLANT LOCATIONS IN THE FIELD. ALL PLANT MATERIAL IS SUBJECT TO APPROVAL OF THE LANDSCAPE ARCHITECT BEFORE, DURING AND AFTER INSTALLATION. ALL PLANTS MUST BE HEALTHY, VIGOROUS MATERIAL, FREE OF PEST AND DISEASES. ALL PLANTS MUST BE BALLED AND BURLAPPED (B-B) AS INDICATED IN THE PLANT LIST. ALL TREES SHALL BE STRAIGHT TRUNKED, OR OF TYPICAL FORM TO THE SPECIES, FULL HEADED AND MEET THE REQUIREMENTS AS SPECIFIED. MULCH, STAKE, AND WATER IN ALL PLANTS PLANTED BEFORE ENDING WORK FOR THE DAY.

- ANY PLANT WHICH DIES, TURNS BROWN OR DEFOLIATES (PRIOR TO TOTAL ACCEPTANCE OF THE WORK) SHALL BE PROMPTLY REMOVED FROM THE SITE AND REPLACED WITH MATERIAL OF THE SAME SPECIES, QUANTITY, SIZE AND MEETING ALL THE PLANT LIST SPECIFICATIONS.
- STANDARDS SET FORTH IN 'AMERICAN STANDARDS FOR NURSERY STOCK' REPRESENT GUIDELINE SPECIFICATIONS AND CONSTITUTE THE MINIMUM QUALITY OF REQUIREMENTS OF THE PLANT MATERIAL FOR THIS PROJECT. SEE DETAIL SHEET 14 FOR SPECIFIC REQUIREMENTS.
- LABEL EACH TREE WITH A SECURELY ATTACHED, WATERPROOF TAG BEARING LEGIBLE DESIGNATION OF BOTH BOTANICAL AND COMMON NAME. DO NOT REMOVE UNTIL AFTER WALK THROUGH WITH CITY OF WICHITA REPRESENTATIVE.
- STAKES AND GUYING SHALL BE REMOVED BY THE CONTRACTOR AT THE END OF ONE FULL GROWING SEASON, OR AS DIRECTED.
- ANY TOPSOIL NEEDED TO CORRECT SOIL LEVELS IN PLANTING ISLANDS OR SUMP AREAS IN LAWNS SHALL BE FERTILE NATURAL TOPSOIL, TYPICAL OF THE LOCALITY, OBTAINED FROM WELL DRAINED AREAS. STOCKPILED TOPSOIL MAY BE USED. IT SHALL BE WITHOUT ADMIXTURE OF SUBSOIL OR SLAG AND SHALL BE FREE OF STONES, LUMPS, STICKS, PLANTS OR THEIR ROOTS, TOXIC SUBSTANCES OR OTHER EXTRANEOUS MATTER THAT MAY BE HARMFUL TO PLANT GROWTH OR WOULD INTERFERE WITH FUTURE MAINTENANCE. TOPSOIL pH RANGE SHALL BE 5.5 TO 7.0. TOPSOIL SHALL BE APPROVED BY THE LANDSCAPE ARCHITECT PRIOR TO PLACEMENT.
- SUBSTITUTION OF PLANT SPECIES TYPES FOR THOSE LISTED IN THE PLANT LIST IS NOT PERMISSIBLE UNLESS APPROVED BY MKEC (684-9600). ANY SPECIES SUBSTITUTION WHICH HAS NOT BEEN APPROVED SHALL BE REMOVED IMMEDIATELY AND REPLACED WITH THE CORRECT PLANT.
- DAMAGE TO ANY EXISTING IRRIGATION SYSTEMS SHALL BE REPAIRED WITH IDENTICAL REPLACEMENT PARTS TO THE SATISFACTION OF THE LANDSCAPE ARCHITECT.
- CONTRACTOR SHALL EMPLOY FULL TIME SUPERINTENDENT ON SITE WHILE WORK IS IN PROGRESS.

GENERAL IRRIGATION NOTES:

- THE CONTRACTOR SHALL PROVIDE AN AUTOMATIC IRRIGATION SYSTEM WITHIN THE (4) INTERNAL MEDIAN ISLANDS ON THIS PROJECT. REFER TO UNDERGROUND SPRINKLER SPECIFICATION SECTION 02810 FOR DETAILED INFORMATION REGARDING THE IRRIGATION SYSTEM REQUIREMENTS.
- ADDITIONAL BORING REQUIRED SHALL BE SUBSIDIARY TO THE 'IRRIGATION SYSTEM' BID ITEM. WATER METER INSTALLATION/MATERIAL FEES, MATERIALS COST, BACKFLOW DEVICES, COVERS, & ALL MISCELLANEOUS PARTS NECESSARY FOR A FULLY FUNCTIONING IRRIGATION SYSTEM SHALL BE SUBSIDIARY TO THE 'IRRIGATION SYSTEM' BID ITEM.

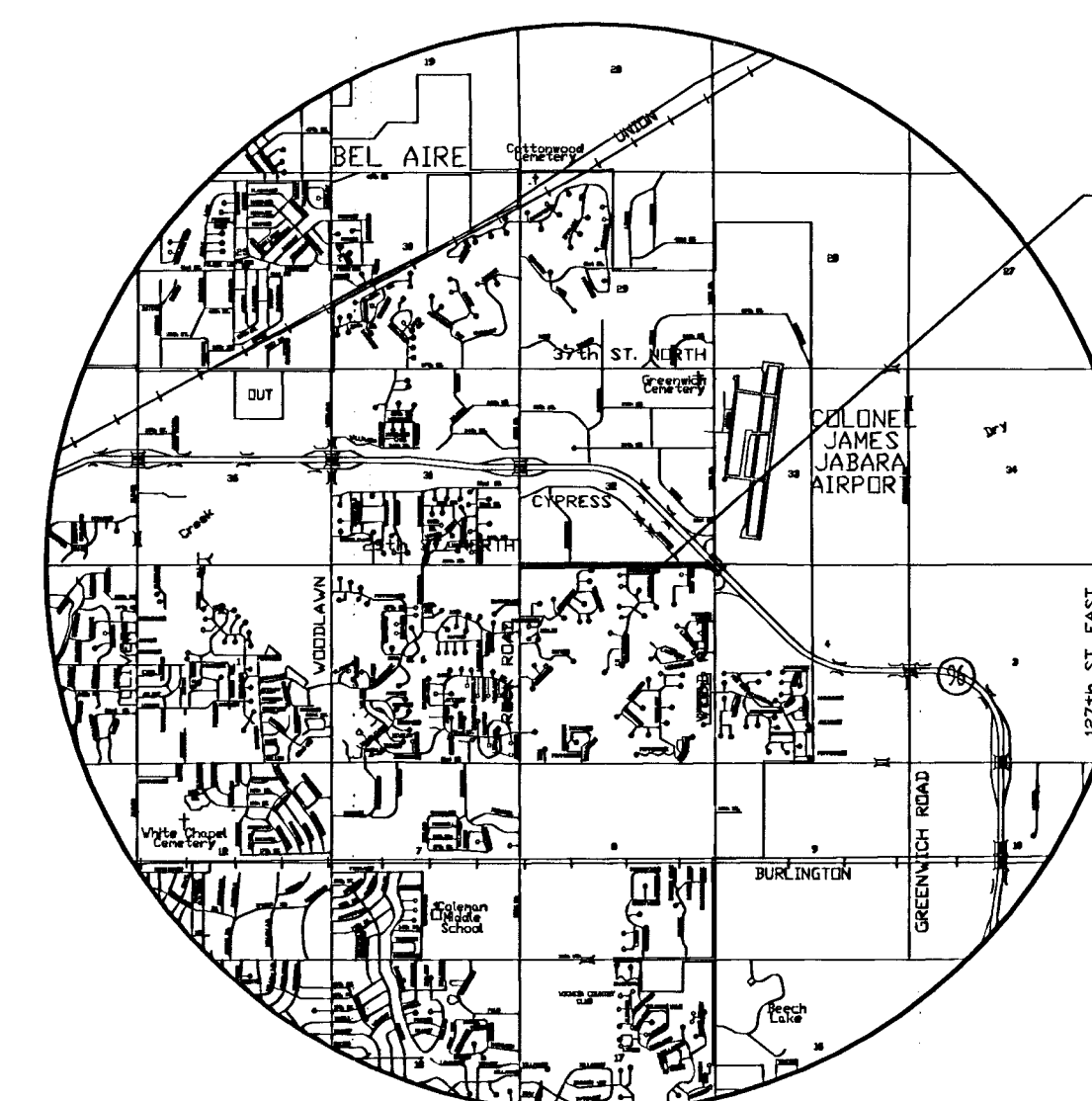

LOCATION MAP

INDEX TO DRAWINGS

SHEET NO.	DESCRIPTION
1	TITLE SHEET
2-13	PLANTING PLANS
14	PLANTING DETAILS & PLANT LIST

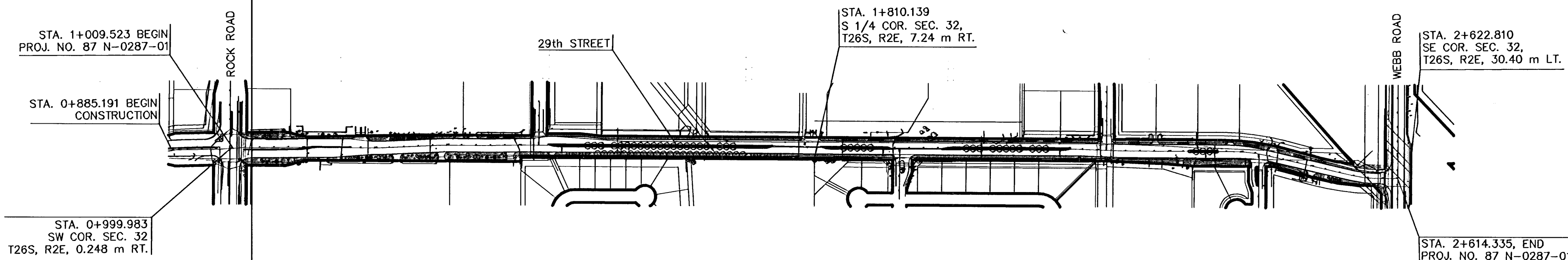

NORTH
SCALE 1 : 4000
(METRIC UNITS)

H:\CIVIL\01058\DWG\Landscape\01058.TTL