

Existing trees which are in direct conflict with proposed new construction shall be removed by the Contractor **ONLY** with approval of the Developer or Engineer. Trees not in direct conflict with proposed new construction shall remain and be protected from damage. Cost shall be included in bid item "Site Clearing"

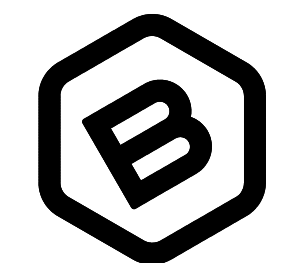
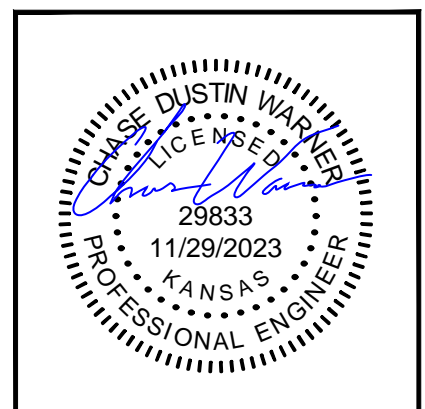
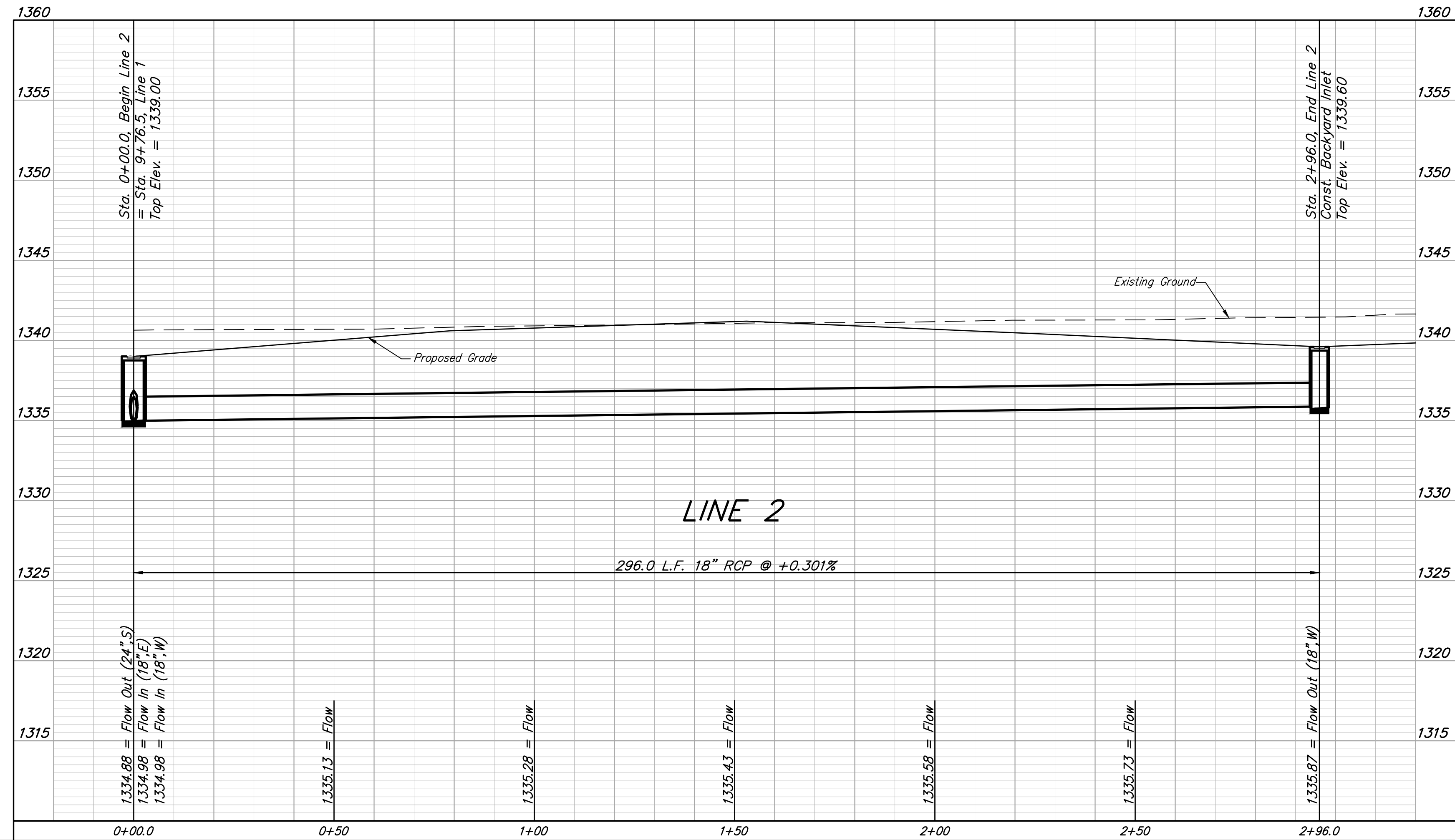

**BAUGHMAN
COMPANY**

315 Ellis St.
Wichita, KS 67211
316-262-7271
BaughmanCo.com

SKYWAY WEST
6TH ADDITION

LINE 2

STORMWATER DRAIN
IMPROVEMENTS

PROJECT NUMBER:
458-2023-085537

DESIGN: CDW DRAWN: CDW

DATE: August 14, 2023

SHEET **06** OF **27**