

BENCHMARKS:

BM #1: C.O.W. disc at SW corner of intersection.
30.00'± S. of CL of 13th St. N.
35.00'± W. of CL of 135th St. W.
Elev. = 168.25 City Datum

BM #2: Small RR spike in 4th HLP
W. of 135th St. W. on south side of 13th St. N. (N. face of HLP).
Elev. = 179.24 City Datum

BM #3: RR spike in Power Pole.
1321.65 W. of 135th St. W.
30' N. of 13th St. N.
Elev. = 178.45 City Datum

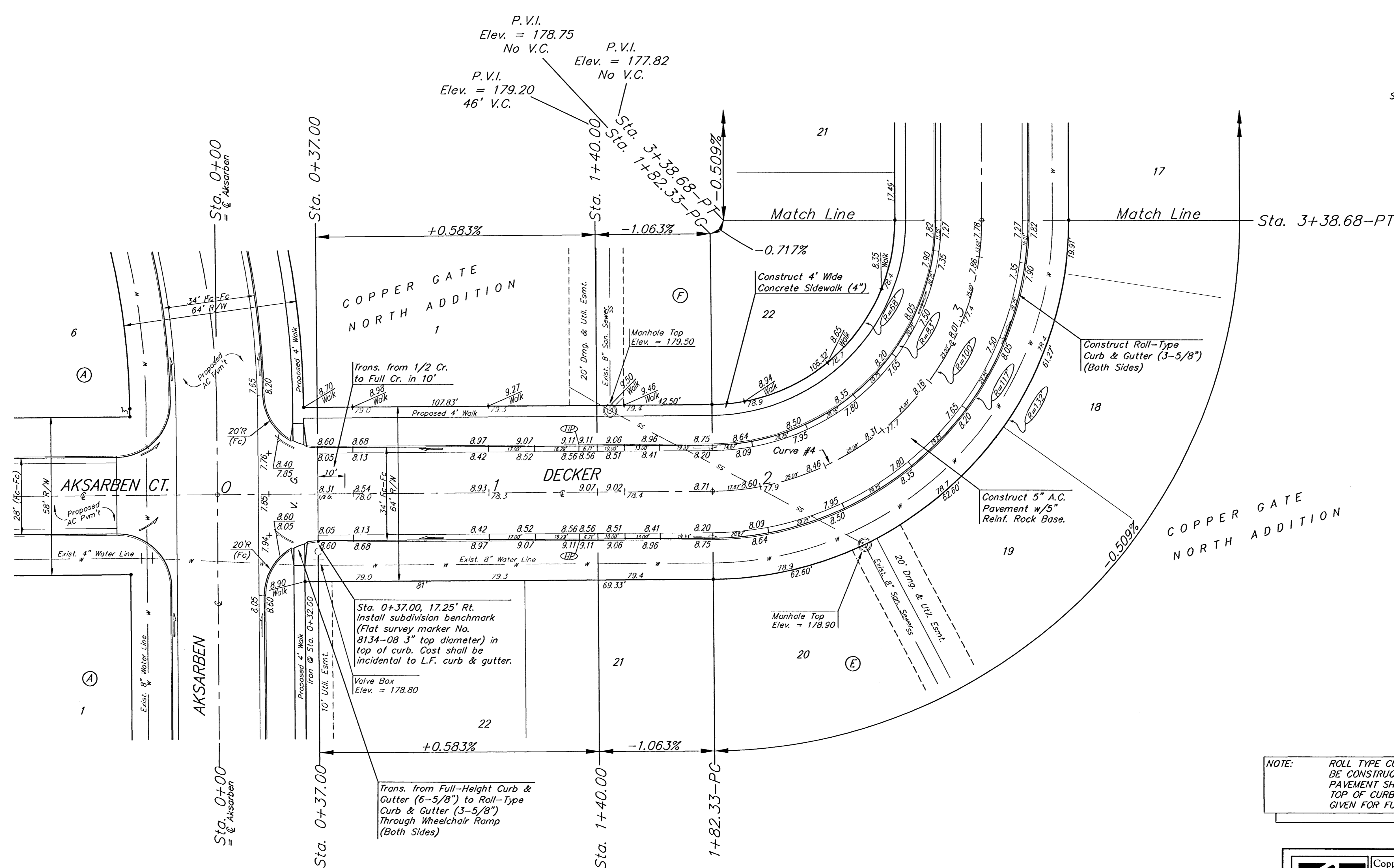
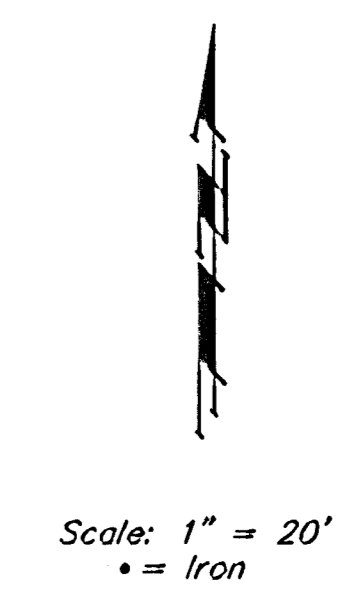

Trans. from Full-Height Curb & Gutter (6-5/8") to Roll-Type Curb & Gutter (3-5/8") Through Wheelchair Ramp (Both Sides)

NOTE: ROLL TYPE CURB & GUTTER TO BE CONSTRUCTED ON THE PAVEMENT SHOWN ON THIS SHEET. TOP OF CURB ELEVATIONS ARE GIVEN FOR FULL HEIGHT CURB.

Curve #4
Curve Data Based on Centerline
Rad. = 100' Delta = 89° 34' 55" Tangent = 99.27'
Arc = 156.35' L.C. = 140.90' Def/Pl. = 17.18873 Min.

Station	Arc	FACE CHORD LENGTHS		Defl.	T. Defl.
		8' Lt.	8' Rt.		
1+82.33	-	-	-	0'00"00"	0'00"00"
2+00.00	17.67'	13.24'	22.06'	5'03"43"	5'03"43"
2+25.00	25.00'	18.70'	31.17'	7'09"44"	7'13"27"
2+50.00	25.00'	18.70'	31.17'	7'09"43"	19'23"10"
2+75.00	25.00'	18.70'	31.17'	7'09"43"	26'32"53"
3+00.00	25.00'	18.70'	31.17'	7'09"43"	33'42"56"
3+25.00	25.00'	18.70'	31.17'	7'09"43"	40'52"19"
3+38.68	13.68'	10.25'	17.09'	3'55"09"	44'47"28"

Baughman Copper Gate North Addition - Phase I
STA. 0+00 TO STA. 3+38.68

Baughman Company, P.A. 315 Ellis St. Wehles, KS 67211 F 316-262-7211 F 316-262-4149
ENGINEERING | SURVEYING | PLANNING | LANDSCAPE ARCHITECTURE

PROJECT NUMBER: 472-84104
DESIGN: TMS/JAK
DRAWN: TMS/JAK
APPROVED: DATE: 10/05/05

REVISIONS:

SCALE: Noted
SHEET: 9 OF 28

Copper Gate North/Phase I/Std 05-02-E162