

BENCHMARK:
 BM #1: C.O.W. disc in curb adjacent to fire hydrant near SE corner of Lot 18, Block B, Southern Ridge 2nd Addition. Elev. = 144.10 (City Datum)

BM #2: C.O.W. disc 44.0' S & 49.8' W of intersection of Pawnee & Maize Road. 12.0' E of fence and 65.0' SW of section corner. Elev. = 132.12 (City Datum)

Scale: 1" = 20'
 • = Iron

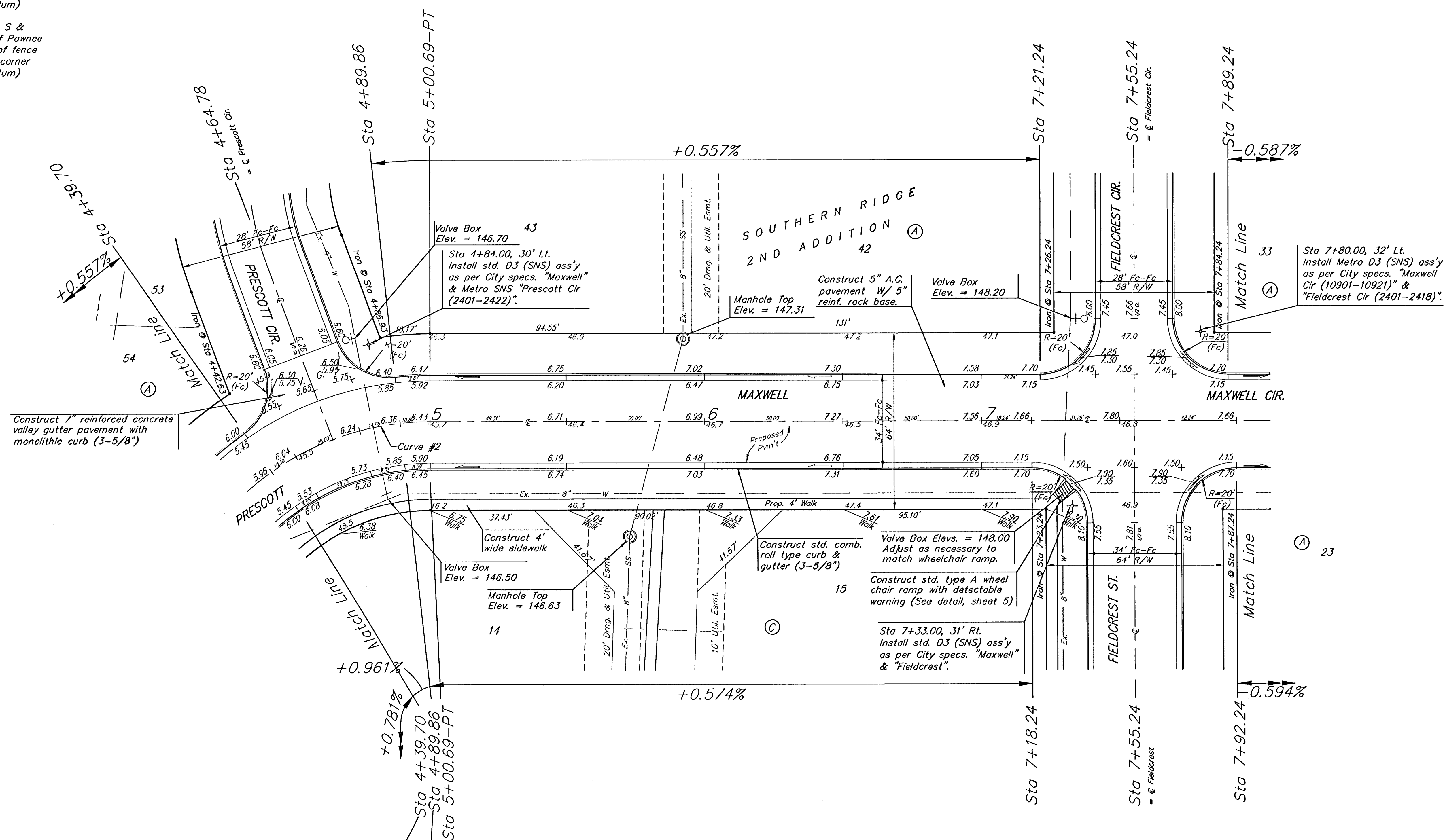

Construct 7" reinforced concrete valley gutter pavement with monolithic curb (3-5/8")

Valve Box 43
 Elev. = 146.70
 Sta 4+84.00, 30' Lt.
 Install std. D3 (SNS) ass'y as per City specs. "Maxwell" & Metro SNS "Prescott Cir (2401-2422)".

Manhole Top Elev. = 147.31
 Construct 5" A.C. pavement W/ 5" reinf. rock base.

Valve Box Elev. = 148.20

Sta 7+80.00, 32' Lt.
 Install Metro D3 (SNS) ass'y as per City specs. "Maxwell Cir (10901-10921)" & "Fieldcrest Cir (2401-2418)".

Valve Box Elev. = 146.50
 Manhole Top Elev. = 146.63

Construct std. comb. roll type curb & gutter (3-5/8")

Valve Box Elev. = 148.00
 Adjust as necessary to match wheelchair ramp.

Construct std. type A wheelchair ramp with detectable warning (See detail, sheet 5)

Sta 7+33.00, 31' Rt.
 Install std. D3 (SNS) ass'y as per City specs. "Maxwell" & "Fieldcrest".

P.V.I.
 Elev. = 146.00
 No V.C.

P.V.I.
 Elev. = 146.40
 No V.C.

Subdivision Bench Marks

Street & Station	Location Description	Elevation
Prescott 1+58.31, 17.25' Rt.	Adjacent to Fire Hydrant at N. End of N.E. Curb Return of Prescott & Prescott Cir. (Lots 1-10, Block C)	
Fieldcrest Cir. 0+37.00, 14.25' Rt.	Adjacent to Fire Hydrant at N. End of W. Curb Return of Maxwell and Fieldcrest Cir.	
Prescott Cir. 0+32.71, 14.25' Rt. (Lots 43-53, Block A)	Adjacent to Fire Hydrant at N. End of E. Curb Return of Maxwell & Prescott Cir. (Lots 43-53, Block A)	

NOTE: ROLL TYPE CURB & GUTTER TO BE CONSTRUCTED ON THE PAVEMENT SHOWN ON THIS SHEET. TOP OF CURB ELEVATIONS ARE GIVEN FOR FULL HEIGHT CURB.

Baughman SOUTHERN RIDGE 2ND ADD. - PH II
MAXWELL
 STA 4+39.70 TO STA 7+92.24

PROJECT NUMBER: 47284098
 DESIGN: AEO
 DRAWN: TMS
 APPROVED: [Signature]
 DATE: 10/05

SCALE: Noted
 SHEET: 7 OF 29

SouthernRidge2nd\Phase1\Sr2 05-09-E350