

**BENCHMARKS:**

BM #1: C.O.W. Disc top of Curb adjacent to FH between Lot's 10 & 11, Block C.  
Elevation = 93.70 City Datum

BM #2: City of Wichita Disc adjacent to FH on NE Corner of Leonine & Angel.  
Elevation = 92.29 City Datum



Scale: 1" = 20' Horizontal  
1" = 5' Vertical  
• = Iron

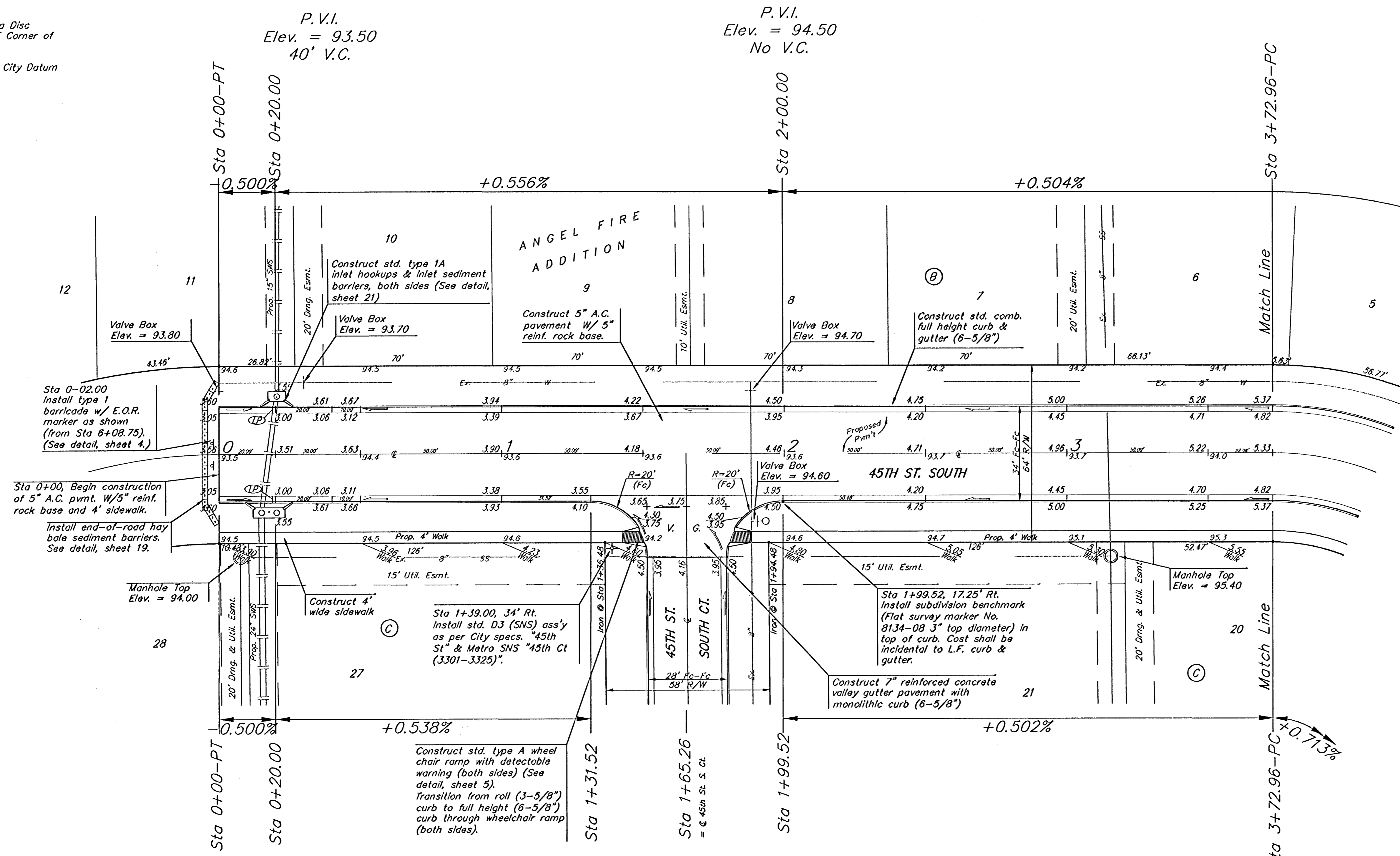

P.V.I.  
Elev. = 93.50  
40' V.C.

P.V.I.  
Elev. = 94.50  
No V.C.

P.V.I.  
Elev. = 93.50  
40' V.C.

P.V.I.  
Elev. = 95.37  
No V.C.

Subdivision Bench Marks		
Street & Station	Location Description	Elevation
45th St. South 1+99.52, 17.25' Rt.	Adjacent to Fire Hydrant at E. End of E. Curb Return of 45th St. South & 45th St. South Ct.	

	ANGEL FIRE ADDITION - PHASE IV
	<b>45TH ST. SOUTH</b>
STA 0+00 TO STA 3+72.96	
Baughman Company, P.A. 315 Elm St. Wichita, KS 67201 F316362711 F316362719	
ENGINEERING   SURVEYING   PLANNING   LANDSCAPE ARCHITECTURE	
PROJECT NUMBER 472-84126	DESIGN TMS
REVISIONS:	APPROVED DATE 02/05
	SCALE Noted
	SHEET <b>6 OF 24</b>
AngelFire/Sr1	04-07-09/68