

Benchmarks:

135th St. W. & Central
City of Wichita Benchmark
DISC - NE Cor. Intersection,
32.6' N. & 24.5' E. of C. both
39.5' NE of Iron at Sec. Cor.
Elev. = 159.50 (City Datum)

Brass disc in curb - east side
of Aksarben adjacent to fire
hydrant 5± South of SW Cor.
Lot 8, Block A, Highland
Springs 3rd Addition.
Elev. = 170.00 (City Datum)

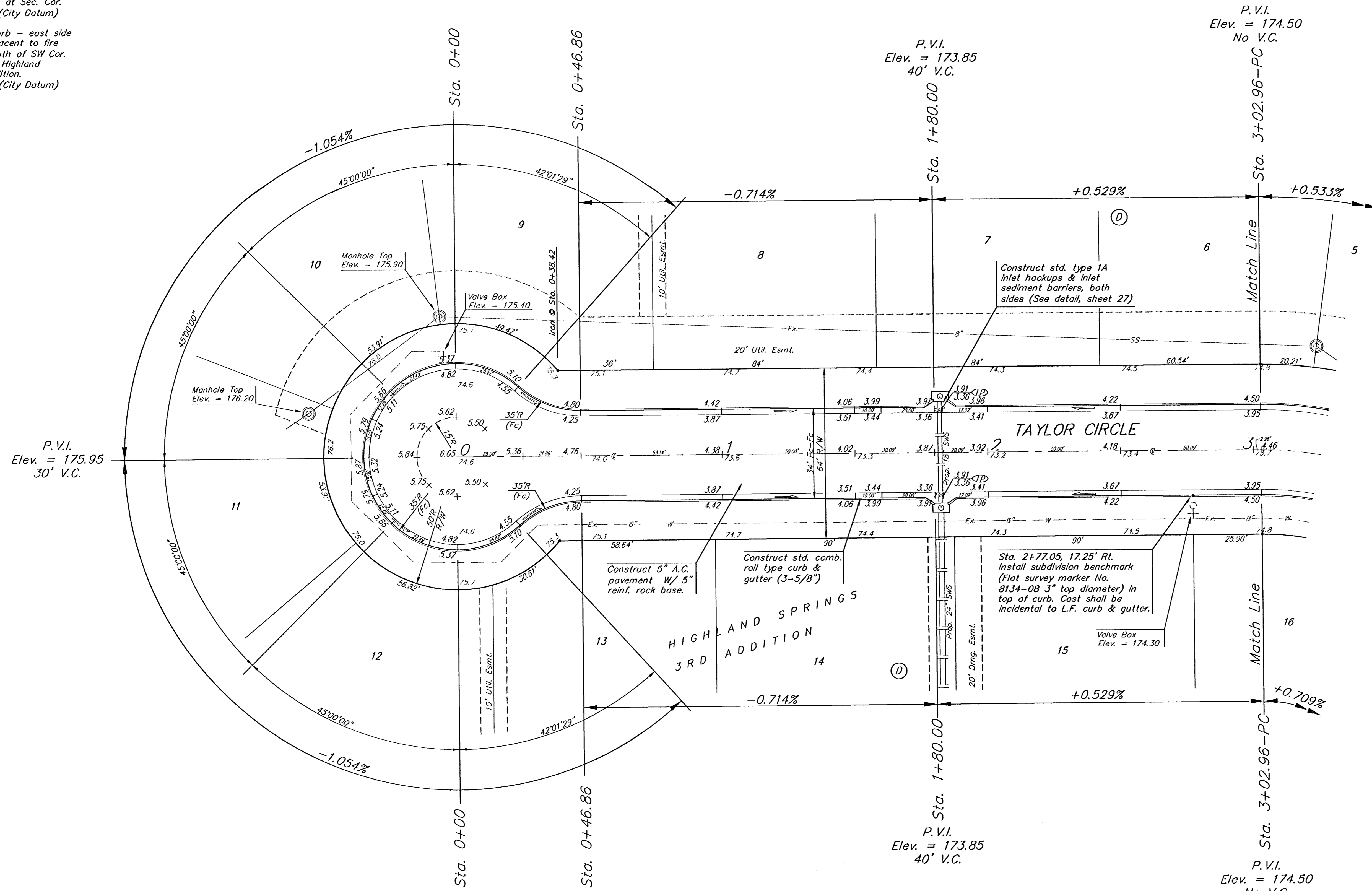
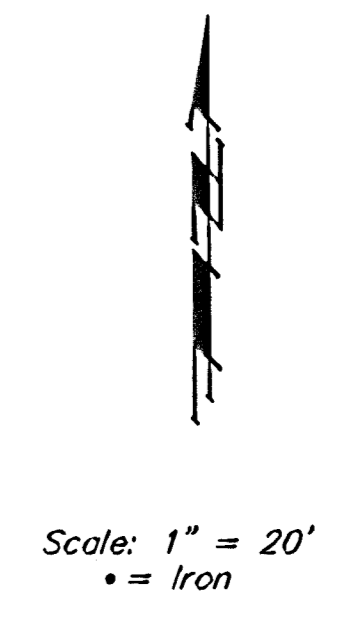

NOTE: ROLL TYPE CURB & GUTTER TO BE CONSTRUCTED ON THE PAVEMENT SHOWN ON THIS SHEET. TOP OF CURB ELEVATIONS ARE GIVEN FOR FULL HEIGHT CURB.

	Highland Springs 3rd Addition - Phase II	
	TAYLOR CIRCLE STA 0+00 TO STA 3+02.96	
Baughman Company, P.A. 315 E. 15th St. Wichita, KS 67211 P:316-261-7211 F:316-261-1199 ENGINEERING SURVEYING PLANNING LANDSCAPE ARCHITECTURE		
PROJECT NUMBER 47283779	DESIGN NBW	DRAWN TMS/JAK
REVISIONS:	APPROVED	DATE 4/21/05
	SCALE Noted	SHEET
	11 OF 39	
Highland Springs 3rd Phase 2/Sheet 4.dwg		0406E927