

**Benchmarks:**

135th St. W. & Central  
City of Wichita Benchmark  
DISC - NE Cor. Intersection,  
32.6' N. & 24.5' E. of C both.  
39.5' NE of Iron at Sec. Cor.  
Elev. = 159.50 (City Datum)

Brass disc in curb - east side  
of Aksorben adjacent to fire  
hydrant 5± South of SW Cor.  
Lot 8, Block A, Highland  
Springs 3rd Addition.  
Elev. = 170.00 (City Datum)

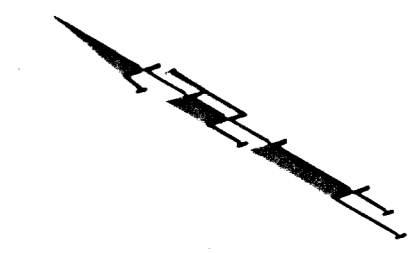

Scale: 1" = 20'  
• = Iron

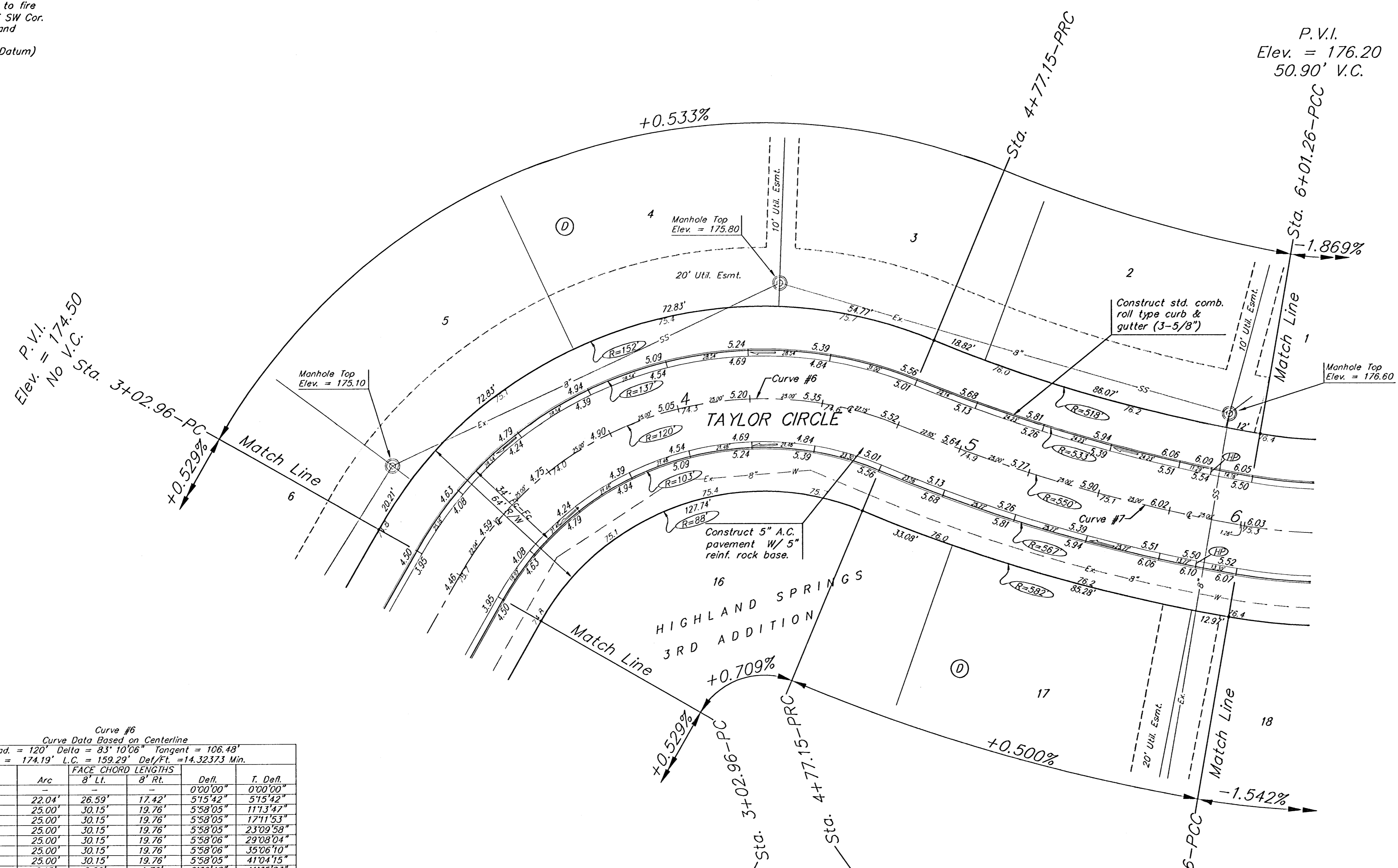

P.V.I.  
Elev. = 174.50  
No V.C.  
Sta. 3+02.96-PC

P.V.I.  
Elev. = 176.20  
50.90' V.C.  
Sta. 6+01.26-PCC

P.V.I.  
Elev. = 174.50  
No V.C.

P.V.I.  
Elev. = 175.56  
No V.C.

P.V.I.  
Elev. = 176.20  
52.10' V.C.

NOTE: ROLL TYPE CURB & GUTTER TO BE CONSTRUCTED ON THE PAVEMENT SHOWN ON THIS SHEET. TOP OF CURB ELEVATIONS ARE GIVEN FOR FULL HEIGHT CURB.

Curve #6  
Curve Data Based on Centerline  
Rad. = 120' Delta = 83° 10' 06" Tangent = 106.48'  
Arc = 174.19' L.C. = 159.29' Del/Ft. = 14.32373 Min.

Station	Arc	FACE CHORD LENGTHS		Defl.	T. Defl.
		8' Lt.	8' Rt.		
3+02.96	-	-	-	0°00'00"	0°00'00"
3+25.00	22.04'	26.59'	17.42'	5°15'42"	5°15'42"
3+50.00	25.00'	30.15'	19.76'	5°58'05"	11°13'47"
3+75.00	25.00'	30.15'	19.76'	5°58'05"	17°11'53"
4+00.00	25.00'	30.15'	19.76'	5°58'05"	23°09'58"
4+25.00	25.00'	30.15'	19.76'	5°58'06"	29°08'04"
4+50.00	25.00'	30.15'	19.76'	5°58'06"	35°06'10"
4+77.00	25.00'	30.15'	19.76'	5°58'05"	41°04'15"
4+77.15	2.15'	2.60'	1.70'	0°30'48"	41°35'03"

Curve #7  
Curve Data Based on Centerline  
Rad. = 550' Delta = 12° 55' 45" Tangent = 62.32'  
Arc = 124.11' L.C. = 123.85' Del/Ft. = 3.12525 Min.

Station	Arc	FACE CHORD LENGTHS		Defl.	T. Defl.
		8' Lt.	8' Rt.		
4+77.15	-	-	-	0°00'00"	0°00'00"
5+00.00	22.85'	21.81'	23.89'	1°11'25"	1°11'25"
5+25.00	25.00'	23.86'	26.13'	1°18'09"	2°29'33"
5+50.00	25.00'	23.86'	26.13'	1°18'07"	3°47'40"
5+75.00	25.00'	23.86'	26.13'	1°18'09"	5°05'48"
6+01.26	26.26'	25.06'	27.45'	1°22'05"	6°27'53"

**Baughman** Highland Springs 3rd Addition - Phase II  
**TAYLOR CIRCLE**  
STA 3+02.96 TO STA 6+01.26

ENGINEERING | SURVEYING | PLANNING | LANDSCAPE ARCHITECTURE

PROJECT NUMBER: 472-83779  
DESIGN: NBW  
DRAWN: TMS/JAK  
APPROVED: [Signature]  
DATE: 4/20/05  
SCALE: Noted  
SHEET: 12 OF 39

Highland Springs 3rd Phase 2\Sta5.dwg 0406E927