

**Benchmarks:**  
 135th St. W. & Central  
 City of Wichita Benchmark  
 DISC - NE Cor. Intersection,  
 32.6' N. & 24.5' E. of C both.  
 39.5' NE of Iron at Sec. Cor.  
 Elev. = 159.50 (City Datum)

Brass disc in curb - east side  
 of Aksorben adjacent to fire  
 hydrant 5'± South of SW Cor.  
 Lot 8, Block A, Highland  
 Springs 3rd Addition.  
 Elev. = 170.00 (City Datum)

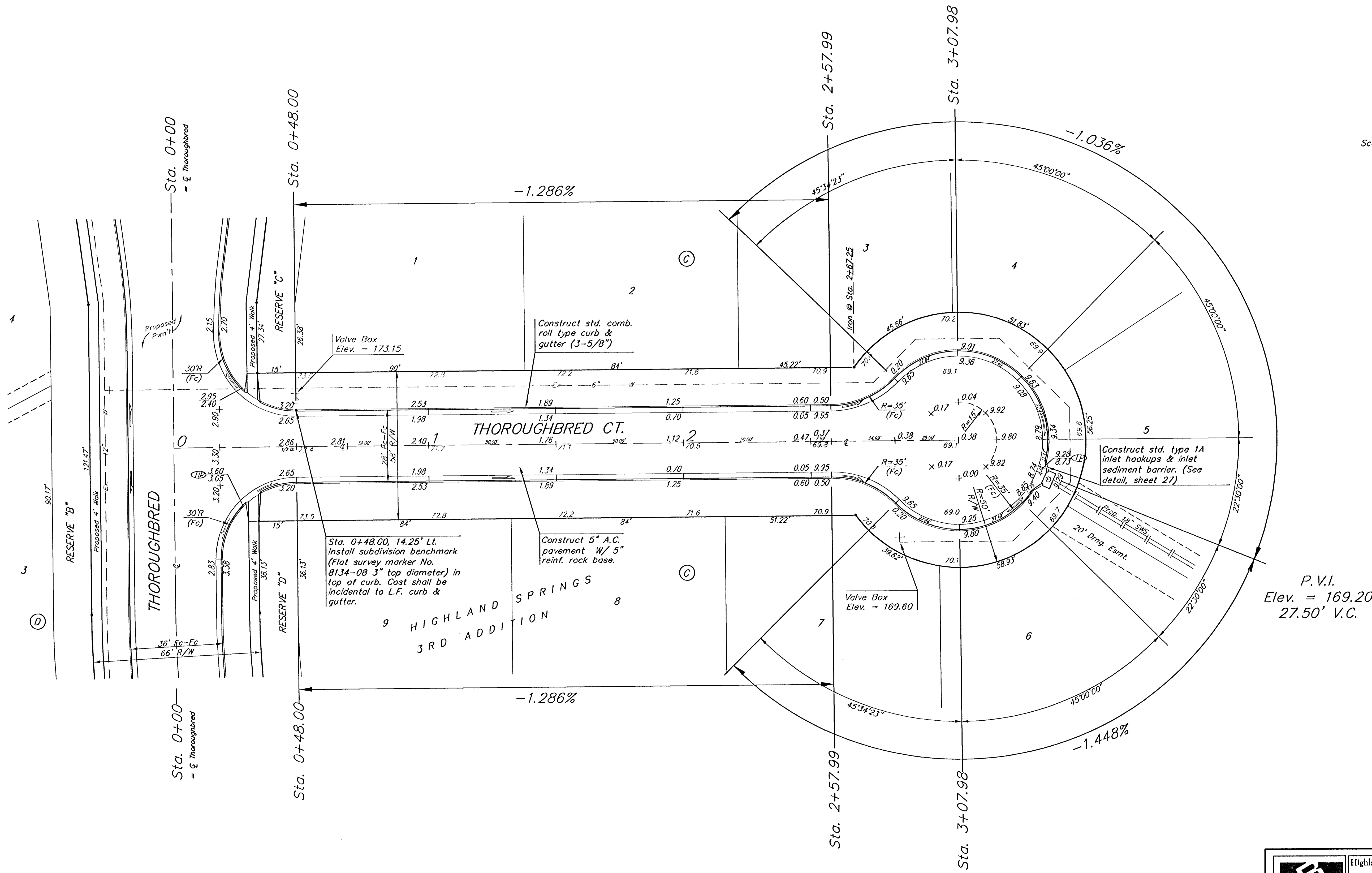
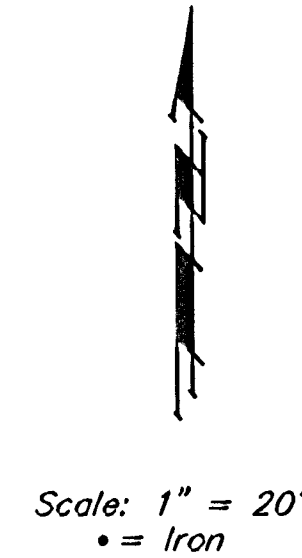

P.V.I.  
 Elev. = 169.20  
 27.50' V.C.

Subdivision Bench Marks

Street & Station	Location Description	Elevation
TAYLOR CIRCLE 2+77.05, 17.25' Rt.	Adjacent to Fire Hydrant near common lot corner of Lots 15-16, Block D.	
TAYLOR CIRCLE 8+46.04, 17.25' Rt.	Adjacent to Fire Hydrant at W End of SW Curb Return of Thoroughbred & Taylor Circle.	
TAYLOR CIRCLE 4+26.90, 17.25' Rt.	Adjacent to Fire Hydrant near common lot corner of Lots 23-24, Block C.	
THOROUGHNBRED CT. 0+48.00, 14.25' Lt.	Adjacent to Fire Hydrant at E. End of N. Curb Return of Thoroughbred & Thoroughbred Ct.	

**NOTE:** ROLL TYPE CURB & GUTTER TO BE CONSTRUCTED ON THE PAVEMENT SHOWN ON THIS SHEET. TOP OF CURB ELEVATIONS ARE GIVEN FOR FULL HEIGHT CURB.

	Highland Springs 3rd Addition - Phase II	
	<b>THOROUGHNBRED CT.</b>	
STA 0+00 TO STA 3+07.98		
Baughman Company, P.A. 315 Ellis St. Wichita, KS 67211 F 3163437111 F 3163430149		
ENGINEERING   SURVEYING   PLANNING   LANDSCAPE ARCHITECTURE		
PROJECT NUMBER 472-83179	DESIGN NBW	DRAWN TMS/JAK
REVISIONS:	APPROVED	DATE 4/20/05
	SCALE Noted	SHEET
		<b>16 OF 39</b>
Highland Springs 3rd Addition Phase 2\Str9.dwg		04-06-E927