

**REEDS COVE ADDITION**

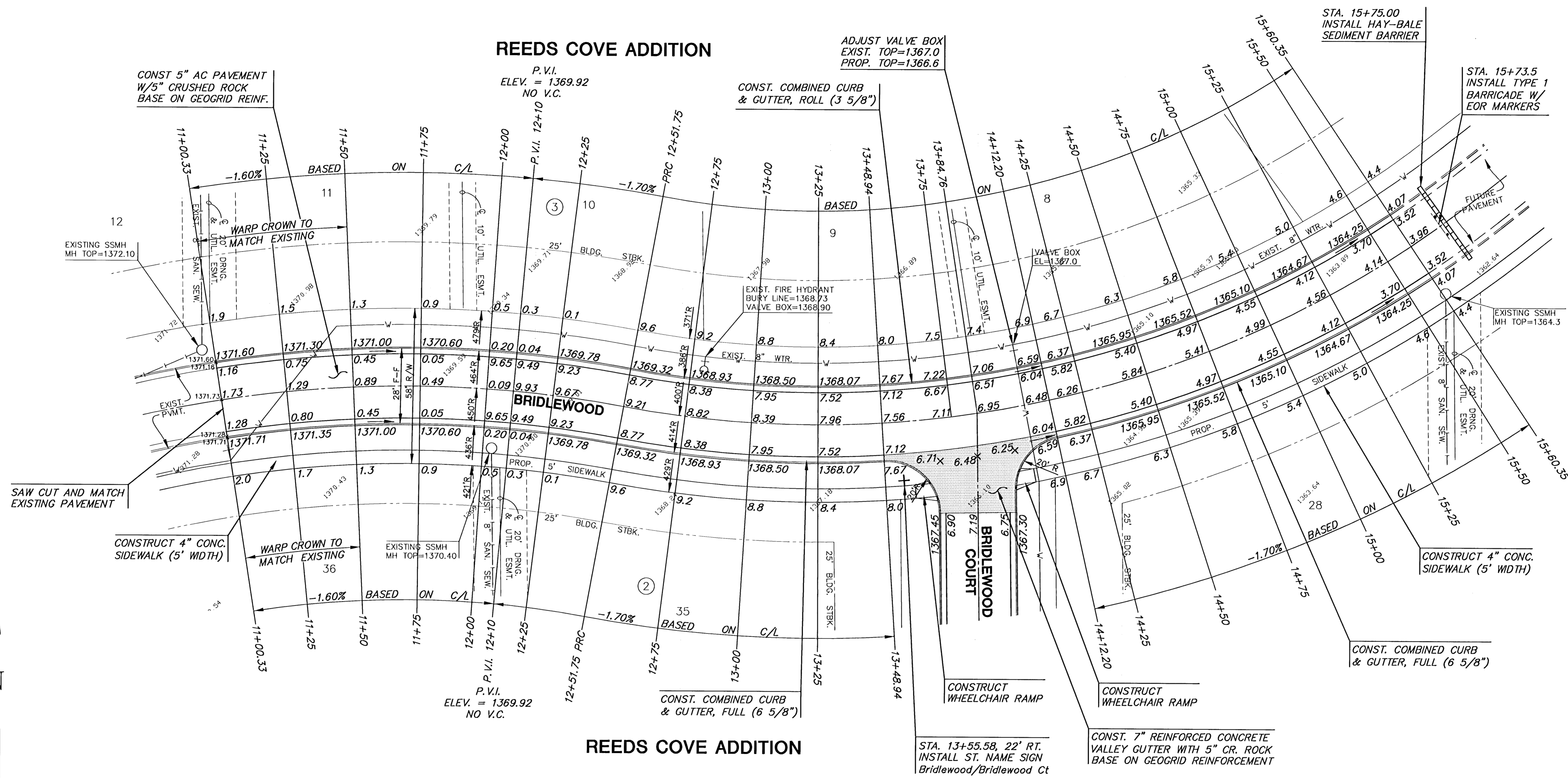

**REEDS COVE ADDITION**

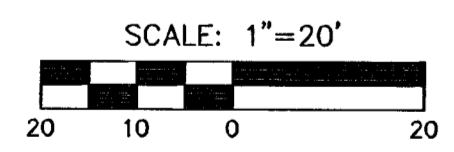

CURVE TABLE						
$\Delta = 44'12.16"$ R = 400.00' T = 162.44' L = 308.61' LC = 301.01'						
CURVE DATA BASED ON CENTERLINE $\Delta / 2 = 22'06.08"$						
STATION	ARC	8'Off LtCb	8'Off RtCb	DEFLECTION	TOTAL DEFLECTION	
12+51.75	-	-	-	00'00.00"	00'00.00"	
12+75.00	23.25'	21.97'	24.53'	01'39.55"	01'39.55"	
13+00.00	25.00'	23.62'	26.37'	01'47.26"	03'27.20"	
13+25.00	25.00'	23.62'	26.37'	01'47.26"	05'14.46"	
13+50.00	25.00'	23.62'	26.37'	01'47.26"	07'02.12"	
13+75.00	25.00'	23.62'	26.37'	01'47.26"	08'49.38"	
14+00.00	25.00'	23.62'	26.37'	01'47.26"	10'37.03"	
14+25.00	25.00'	23.62'	26.37'	01'47.26"	12'24.29"	
14+50.00	25.00'	23.62'	26.37'	01'47.26"	14'11.55"	
14+75.00	25.00'	23.62'	26.37'	01'47.26"	15'59.21"	
15+00.00	25.00'	23.62'	26.37'	01'47.26"	17'46.47"	
15+25.00	25.00'	23.62'	26.37'	01'47.26"	19'34.12"	
15+50.00	25.00'	23.62'	26.37'	01'47.26"	21'21.38"	
15+51.75	1.75'	1.84'	1.68'	00'08.41"	22'06.08"	

Def/Ft = 3.81972 Min. Def/Ft = 4.29718 Min.

CURVE TABLE						
$\Delta = 19'16.46"$ R = 450.00' T = 76.43' L = 151.42' LC = 150.71'						
CURVE DATA BASED ON CENTERLINE $\Delta / 2 = 09'38.23"$						
STATION	ARC	8'Off LtCb	8'Off RtCb	DEFLECTION	TOTAL DEFLECTION	
11+00.33	-	-	-	00'00.00"	00'00.00"	
11+25.00	24.67'	25.87'	23.46'	01'34.14"	01'34.14"	
11+50.00	25.00'	26.22'	23.77'	01'35.30"	03'09.44"	
11+75.00	25.00'	26.22'	23.77'	01'35.30"	04'45.13"	
12+00.00	25.00'	26.22'	23.77'	01'35.30"	06'20.43"	
12+25.00	25.00'	26.22'	23.77'	01'35.30"	07'56.12"	
12+50.00	25.00'	26.22'	23.77'	01'35.30"	09'31.42"	
12+51.75	1.75'	1.84'	1.68'	00'08.41"	09'38.23"	

NOTE:  
TOP OF CURB ELEVATIONS SHOWN  
ARE FOR FULL CURB. CONSTRUCT  
CURB & GUTTER AS NOTED.

**LEGEND**  
+ STREET SIGN & SIGN LOCATION  
(SEE SIGN ASSEMBLY TABLE  
FOR TYPE & STATION OF SIGN)

**REEDS COVE ADDITION - PHASE 3**  
PROJECT NAME

**BRIDLEWOOD PAVING**  
SHEET TITLE

DFL DESIGN BY: DMU DRAWN BY: GJA CHECKED BY:  
JUNE 2005 DATE: 02121 JOB NO. 8 / 19 SHEET OF

411 N. WEBB ROAD  
WICHITA, KS. 67206  
316 - 684 - 9600

H:\CIVIL\02121\DWG\PAV\PHASE\_3\02121\_E2.DWG