

BENCHMARK:
City Disc in T.C. Adj. to F.H.
38' South of intersection of
Onewood and Auburn Hills.
Elev. = 178.48 (City Datum)

"□" cut in south curb of
Onewood 272' west of C.L.
Auburn Hills.
Elev. = 179.73 (City Datum)

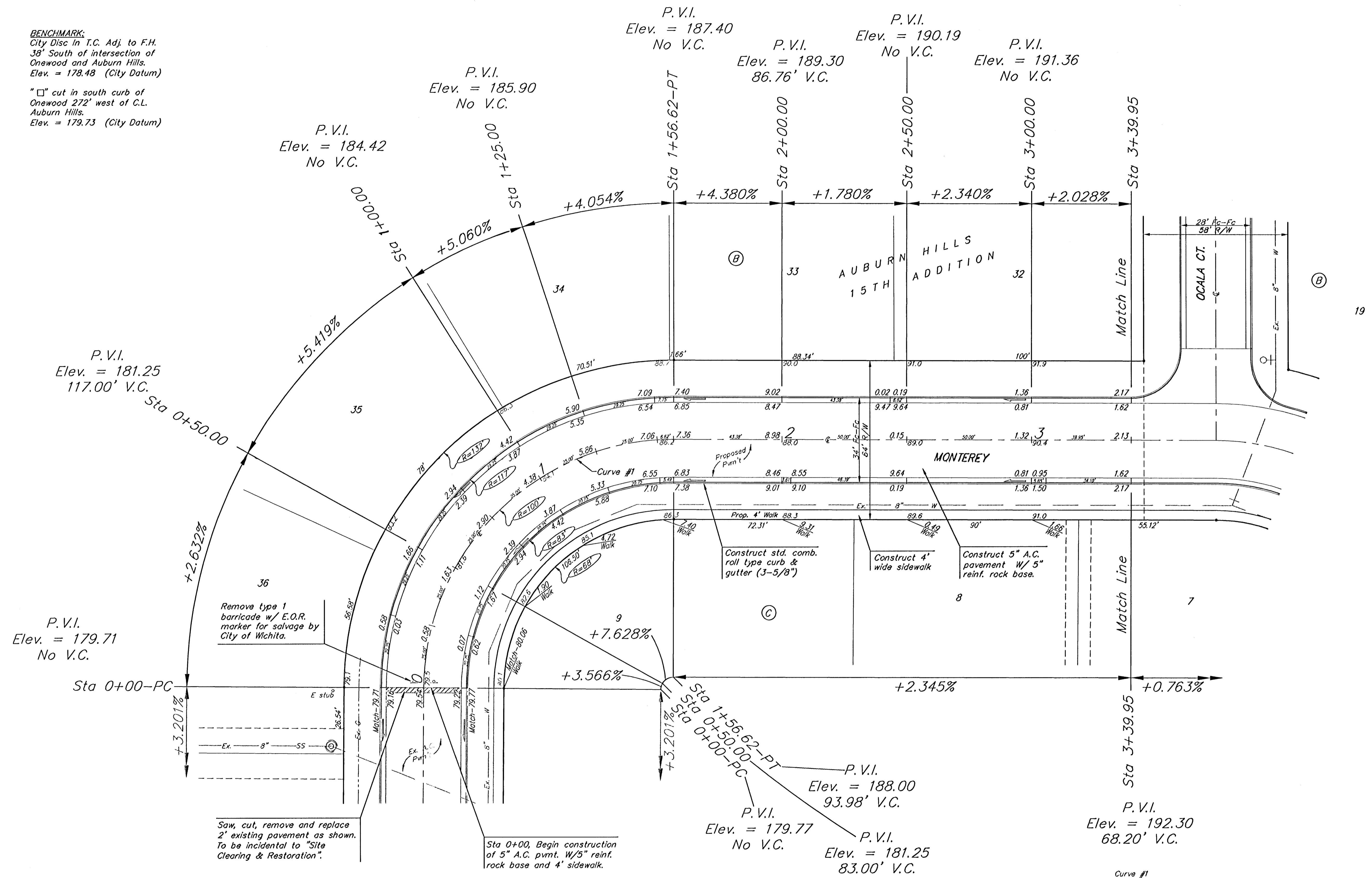
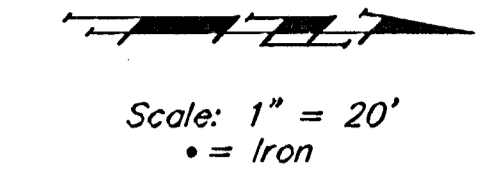

Curve #1
Curve Data Based on Centerline
Rad. = 100' Delta = 89° 44' 20" Tangent = 99.55'
Arc = 156.62' L.C. = 141.10' Def/Pl. = 17.18916 Min.

Station	Arc	FACE CHORD LENGTHS		Defl	T. Defl.
		8" Lt.	8" Rt.		
0+00.00	-	-	-	0°00'00"	0°00'00"
0+25.00	25.00'	31.17'	18.70'	7°09'44"	7°09'44"
0+50.00	25.00'	31.17'	18.70'	7°09'44"	14°19'27"
0+75.00	25.00'	31.17'	18.70'	7°09'44"	21°29'11"
1+00.00	25.00'	31.17'	18.70'	7°09'44"	28°38'55"
1+25.00	25.00'	31.17'	18.70'	7°09'44"	35°48'39"
1+50.00	25.00'	31.17'	18.70'	7°09'44"	42°58'22"
1+56.62	6.62'	8.27'	4.96'	1°33'47"	44°52'10"

Baughman AUBURN HILLS 15TH ADDITION - PHASE 2B
MONTEREY
STA 0+00 TO STA 3+43.83

Baughman Company, P.A. 315 Ellis St. Wichita, KS 67211 P 3162627111 F 3162620149
ENGINEERING | SURVEYING | PLANNING | LANDSCAPE ARCHITECTURE

PROJECT NUMBER: 472-24145 DESIGN: AEO DRAWN: TMS
REVISIONS: APPROVED: DATE: 06/05

SCALE: Noted SHEET: **6 OF 21**

Auburn15/Ph2R/Sct1 04-11-E099