

BENCHMARK:
 City Disc in T.C. Adj. to F.H.
 38' South of intersection of
 Onewood and Auburn Hills.
 Elev. = 178.48 (City Datum)

"□" cut in south curb of
 Onewood 272' west of C.L.
 Auburn Hills.
 Elev. = 179.73 (City Datum)

P.V.I.
 Elev. = 193.00
 80' V.C.

Scale: 1" = 20'
 • = Iron

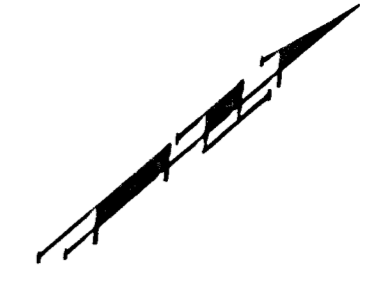

P.V.I.
 Elev. = 187.60
 No V.C.

P.V.I.
 Elev. = 187.14
 No V.C.

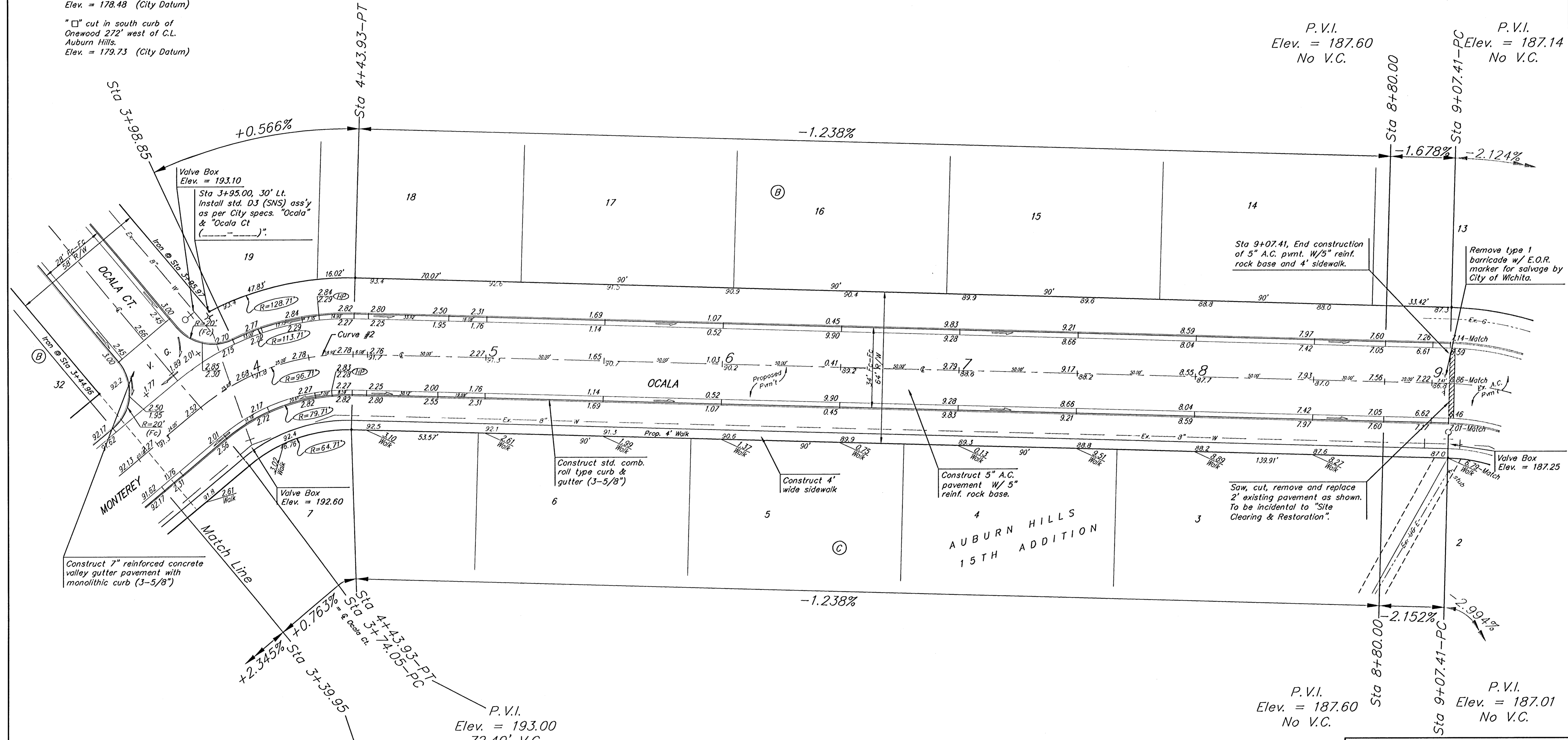

Sta 3+39.95
 Sta 4+43.93-PT
 Sta 3+74.05-PC
 P.V.I. Elev. = 193.00
 72.40' V.C.

Sta 3+98.85
 P.V.I. Elev. = 192.30
 68.20' V.C.

P.V.I.
 Elev. = 187.60
 No V.C.

P.V.I.
 Elev. = 187.01
 No V.C.

Curve #2
 Curve Data Based on Centerline
 Rad. = 96.71' Delta = 41° 24' 07" Tangent = 36.55'
 Arc = 69.88' L.C. = 68.37' Del/ft. = 17.77416 Min.

Station	Arc	FACE CHORD LENGTHS		Defl.	T. Defl.
		8' Lt.	8' Rt.		
3+74.05	-	-	-	0'00"00"	0'00"00"
3+98.85	24.80'	31.13'	18.34'	7'20"48"	7'20"48"
4+00.00	1.15'	1.45'	0.85'	0'20"26"	7'41"14"
4+25.00	25.00'	31.38'	18.49'	7'24"21"	15'05"35"
4+43.93	18.93'	23.79'	14.01'	5'36"28"	20'42"03"

Baughman AUBURN HILLS 15TH ADDITION - PHASE 2B
OCALA
 STA 3+43.83 TO STA 9+07.41

Baughman Company, P.A. 315 Ellis St. Wichita, KS 67211 P 3162627771 F 3162621149
 ENGINEERING | SURVEYING | PLANNING | LANDSCAPE ARCHITECTURE

PROJECT NUMBER	DESIGN AEG	DRAWN TMS
REVISIONS:	APPROVED	DATE 06/05
	SCALE Noted	SHEET

7 OF 21

Auburn15/Ph2B/Sr2 04-11-E099