

BENCHMARK:

City Disc In T.C. Adj. to F.H.
17.5' North of Monterey. At the
South West Corner of Lot 10
Block C Auburn Hills 15th
Addition.
Elev. = 177.39 (City Datum)

City Disc In T.C. Adj. to F.H.
27' North of Monterey. At the
Intersection of Monterey and
Auburn Hills.
Elev. = 179.40 (City Datum)

P.V.I.
Elev. = 189.00
No V.C.

P.V.I.
Elev. = 189.70
36.88' V.C.

*NOTE: Warp crown
shall conform to
approx. midpoint of
pvmt.

Sidewalk location will be field
adjusted to allow for saving trees.
Contractor shall include in bid
"hand-forming" methods to
construct sidewalk. Extra sidewalk
concrete may be required to
allow for added curves and bends to
avoid trees.

Scale: 1" = 20' Horizontal
1" = 5' Vertical
• = Iron

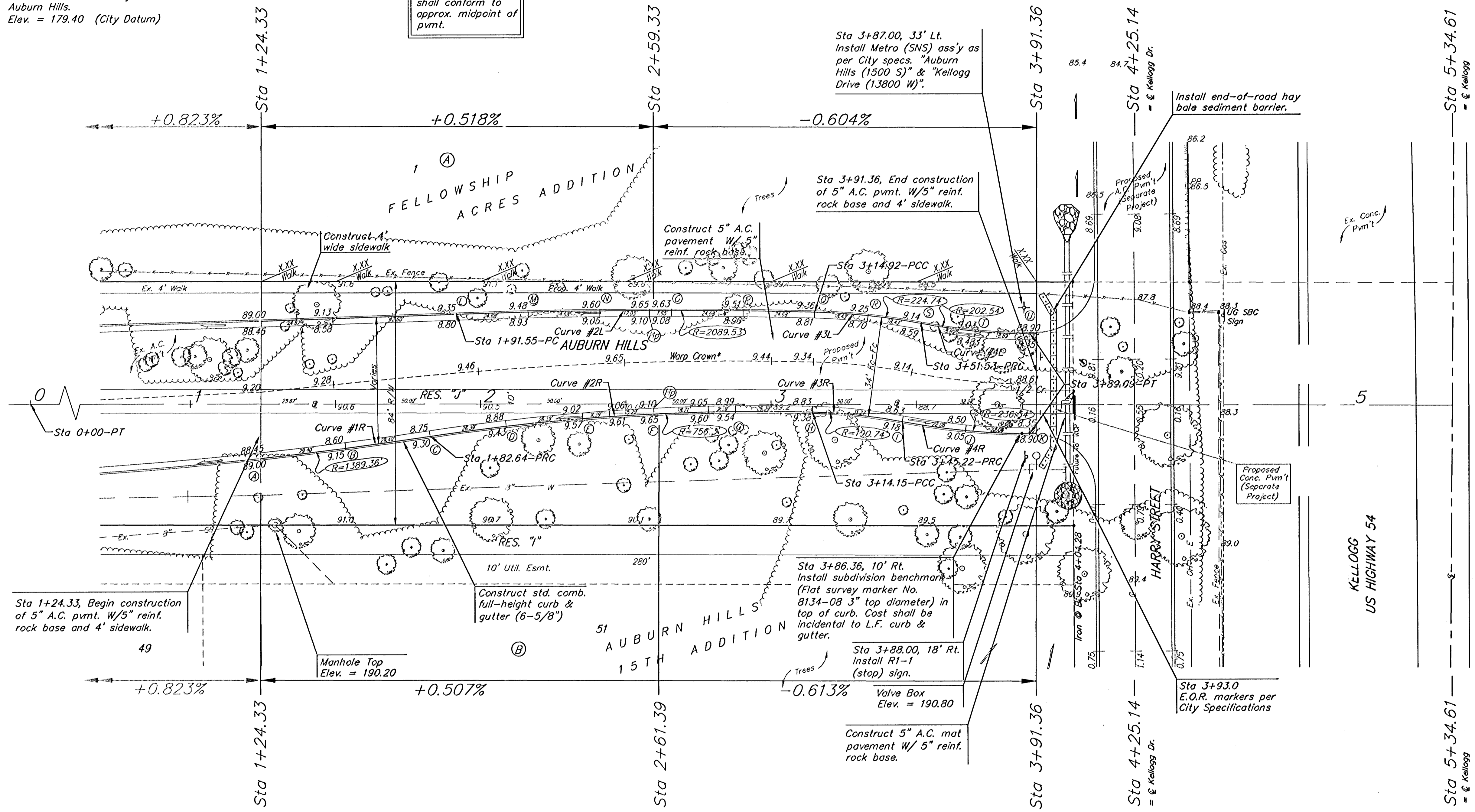

Curve #1R
Curve Data Based on Fc
Rad. = 1389.36' Delta = 2° 25' 32" Tangent = 29.41'
Arc = 58.8' L.C. = 58.81' Def/Ft. = 1.23753 Min.

Station	Arc	FACE CHORD LENGTHS	Def.	T. Def.
A	-	8' Rt.	0'00"00"	0'00"00"
B	29.40'	29.58'	0'36"23"	0'36"23"
C	29.40'	29.58'	0'36"23"	1'12"46"

Curve #2R
Curve Data Based on Fc
Rad. = 756.3' Delta = 9° 59' 49" Tangent = 66.15'
Arc = 131.95' L.C. = 131.79' Def/Ft. = 2.27289 Min.

Station	Arc	FACE CHORD LENGTHS	Def.	T. Def.
C	-	8' Rt.	0'00"00"	0'00"00"
D	26.39'	26.11'	0'59"59"	0'59"59"
E	26.39'	26.11'	0'59"59"	1'59"58"
F	24.68'	26.11'	0'56"06"	2'56"04"
G	28.10'	26.11'	1'03"52"	3'59"56"
H	26.39'	26.11'	0'59"59"	4'59"54"

Curve #2L
Curve Data Based on Fc
Rad. = 2089.53' Delta = 3° 23' 00" Tangent = 61.71'
Arc = 123.4' L.C. = 123.37' Def/Ft. = 0.82253 Min.

Station	Arc	FACE CHORD LENGTHS	Def.	T. Def.
L	-	8' Lt.	0'00"00"	0'00"00"
M	24.68'	24.77'	0'20"18"	0'20"18"
N	24.68'	24.77'	0'20"18"	0'40"36"
O	24.68'	24.77'	0'20"18"	1'00"54"
P	24.68'	24.77'	0'20"18"	1'21"12"
Q	24.68'	24.77'	0'20"18"	1'41"30"

Curve #3R
Curve Data Based on Fc
Rad. = 190.74' Delta = 9° 23' 40" Tangent = 15.67'
Arc = 31.27' L.C. = 31.24' Def/Ft. = 9.01290 Min.

Station	Arc	FACE CHORD LENGTHS	Def.	T. Def.
H	-	8' Rt.	0'00"00"	0'00"00"
I	31.27'	29.93'	4'41"50"	4'41"50"

Curve #3L
Curve Data Based on Fc
Rad. = 224.74' Delta = 9° 23' 40" Tangent = 18.47'
Arc = 36.86' L.C. = 36.81' Def/Ft. = 7.64605 Min.

Station	Arc	FACE CHORD LENGTHS	Def.	T. Def.
O	-	8' Lt.	0'00"00"	0'00"00"
P	18.43'	19.08'	2'20"55"	2'20"55"
S	18.43'	19.08'	2'20"55"	4'41"50"

Curve #4R
Curve Data Based on Fc
Rad. = 236.54' Delta = 10° 41' 13" Tangent = 22.12'
Arc = 44.12' L.C. = 44.06' Def/Ft. = 7.26673 Min.

Station	Arc	FACE CHORD LENGTHS	Def.	T. Def.
I	-	8' Rt.	0'00"00"	0'00"00"
J	22.06'	22.80'	2'40"18"	2'40"18"
K	22.06'	22.80'	2'40"18"	5'20"36"

Curve #4L
Curve Data Based on Fc
Rad. = 202.54' Delta = 10° 41' 13" Tangent = 18.94'
Arc = 37.78' L.C. = 37.72' Def/Ft. = 8.48619 Min.

Station	Arc	FACE CHORD LENGTHS	Def.	T. Def.
S	-	8' Lt.	0'00"00"	0'00"00"
T	18.89'	18.14'	2'40"18"	2'40"18"
U	18.89'	18.14'	2'40"18"	5'20"36"

P.V.I.
Elev. = 189.00
No V.C.

P.V.I.
Elev. = 189.70
34' V.C.

Remove trees only as necessary
for street construction and only
with permission of Developer or
Baughman Co. Cost of removal
to be incidental to lump sum
bid item "Site Clearing &
Restoration".

Subdivision Bench Marks

Street & Station	Location Description	Elevation
Auburn Hills 3+77.27, 27.25' Lt.	Adjacent to Fire Hydrant, 5' from end of curb & gutter at intersection of Auburn Hills & Kelllogg Drive.	

Baughman AUBURN HILLS
STA 1+24.33 TO STA 4+25.14

AUBURN HILLS 15TH ADDITION (LOT 51, BLOCK D)

Baughman Company, P.A. 315 5th St. W. Waukegan, IL 60087 P 316-262-7271 F 316-262-6149
ENGINEERING | SURVEYING | PLANNING | LANDSCAPE ARCHITECTURE

PROJECT NUMBER 472-841-46	DESIGN AEO	DRAWN TMS
REVISIONS	APPROVED	DATE 05/05
SCALE Noted		4 OF 11
SHEET		

Auburn15/CommS01 04-11-E102