

DSNR: JPS OPER: SVB SCALE: 1"=20' I:/2006/06471/PLAN/06471-Plan 99.00-105.00 LAST REV: 5-31-2007 BY: svb

Utility Owners

Cox Communications
 Engineering Dept.
 901 George Washington Blvd.
 Wichita, KS 67211
 Eva Moore 260-7204
 Fax 262-4353

Westar Energy
 1900 E. Central (3rd Floor)
 P.O. Box 208
 Wichita, KS 67214
 Randy Truitt Office 261-6512
 Randy Truitt Mobile 258-4234
 Fax 261-6423

AT&T
 Wichita Central Unit
 154 N. Broadway, Rm. 210
 Wichita, KS 67202
 Jason Edwards 268-2008
 Fax 268-3110

Kansas Gas Service
 1021 E. 26th St. N.
 Wichita, KS 67219
 Jim Coe 832-3126
 Fax 831-5670

Wichita Water & Sewer Department
 8th Floor - City Hall
 455 N. Main
 Wichita, KS 67202
 Bill Perkins or Paul Bryant 268-4555
 Fax 268-4514

Sta. 100+45 BEGIN
 PROJECT No. 472-84435

Sta. 94+24.51 Begin
 Sidewalk Construction Lt.
 Connect to Exist. Wheelchair Ramp

Sta. 100+40, 47' Rt.
 Adjust Water Valve Box from
 Elev. 1370.14 to Elev. 1370.88

Sta. 100+39.71, 53.19' Rt.
 Relocate Existing Fire Hydrant Assembly
 to Sta. 100+39.50, 55.42' Rt.
 Bury Line Elev. = 1369.52
 See Sh. No. 78

- SW Corner Sec. 15, T27S, R2E
1. Found Chiseled "*" in Concrete Pavement
 2. N 1,689,163.3934 E 1,686,392.8069
 3. E Sta. 93+67.27
 4. ± Center Intersection of Central & Greenwich
 5. Chiseled "*" on Top of Curb 77.41' NW
 6. Chiseled "*" on Top of Curb 80.78' SE
 7. Chiseled "*" on Top of Curb 51.69' SW
 8. Chiseled "*" on Top of Curb 53.73' NE

BM #7 - Set Chiseled "*" on top of curb, PT on S curb return at N entrance to Saturn of Wichita car dealership lot. 160' Rt. E Greenwich Rd. Sta. 98+29 Elev. 1370.725

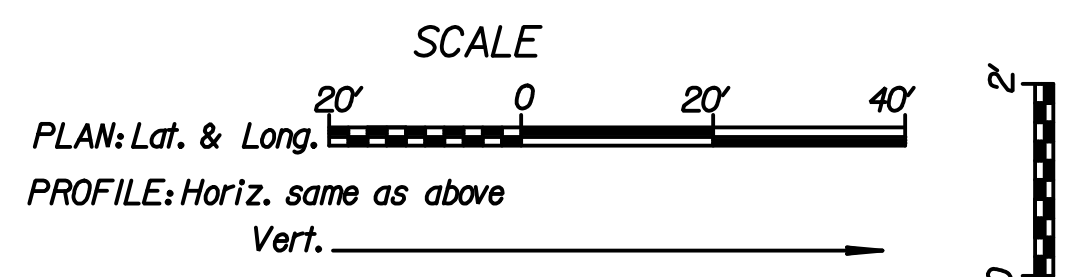

REMOVAL OF EXISTING STRUCTURES *

STATION	SIDE	ITEM
101+48	Rt.	Sign
101+91	Rt.	Sign
102+38	Rt.	Sign

* For Information Only

- UTILITIES**
- Cable TV Cox Communications
 - Gas Kansas Gas Service
 - Power Westar Energy
 - Sanitary Sewer Wichita Water & Sewer Dept.
 - Telephone AT&T
 - Water Wichita Water & Sewer Dept.

- LEGEND**
- Pavement Removal
 - * 6' Transition from Combined Curb & Gutter (Type III) to no curb.

BM #6 - Set Chiseled "*" centered on top of curb inlet face in the SW corner of Holy Cross Lutheran Church & School parking lot. (120' Rt. E Greenwich Rd. Sta. 104+46) Elev. 1365.40

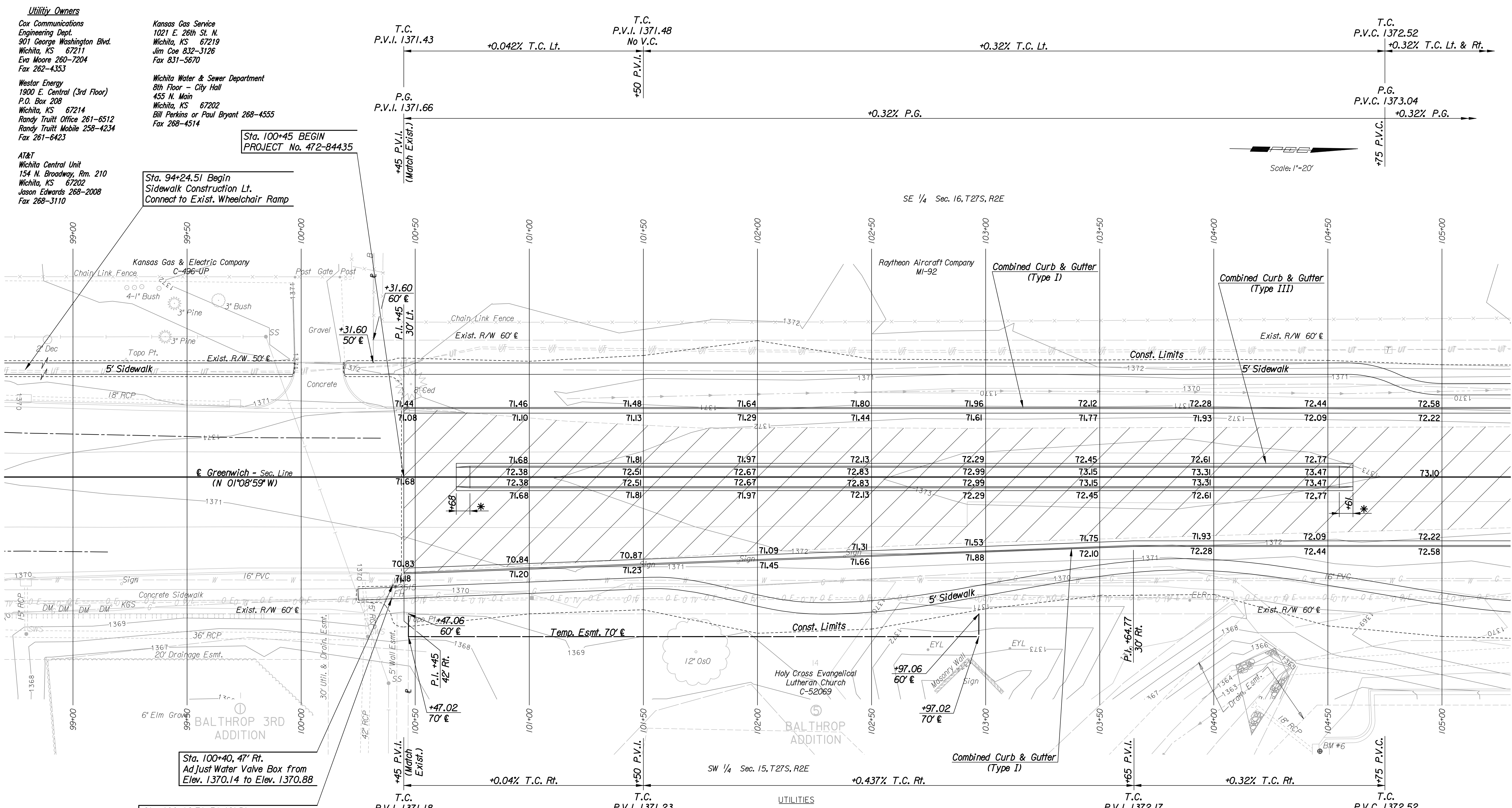

Scale: 1"=20'

GREENWICH ROAD PLAN STA. 99+00 TO STA. 105+00 JAMES L. ARMOUR, P.E. - CITY ENGINEER CITY OF WICHITA PROJECT NO. 472-84435 Professional Engineering Consultants, P.A. 303 S. TOPKA • WICHITA, KANSAS 67202 316-262-2691 • FAX 316-262-3003	No. _____ Revision _____ By _____ Date _____ Designed by JPS Job No. 06471 Drawn by SVB Date June, 2007 Sht. 4 of 97
------------------------------------------------------------------------------------------------------------------------------------------------------------------------------------------------------------------------------------------------------------------------------	----------------------------------------------------------------------------------------------------------------------------