

P.I. & Sta. 120+23.77=
 W 1/4 Cor. Sec. 15, T27S, R2E
 Deflection Angle= 00°05'22" Rt.
 I. See References Below

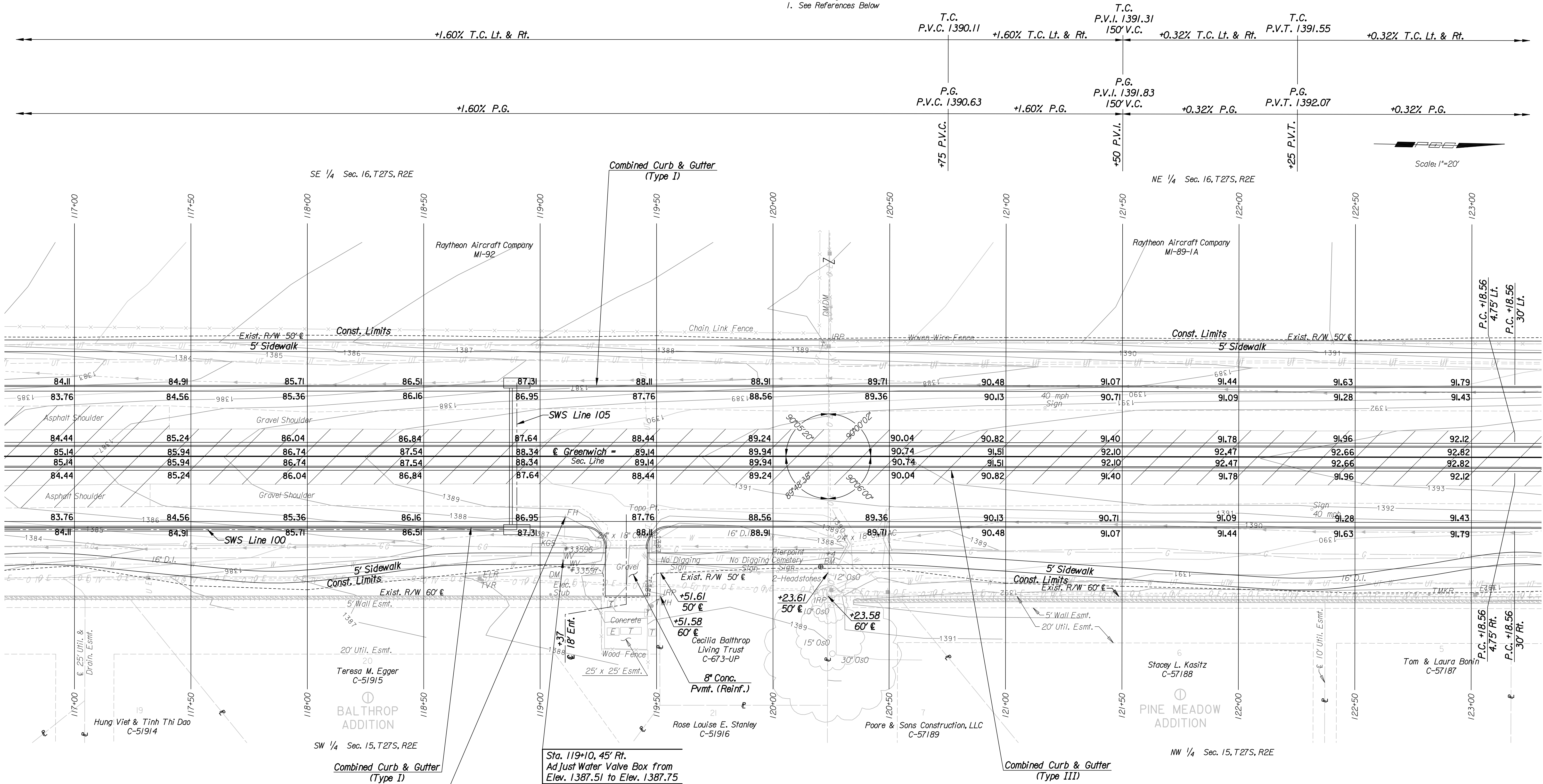

REMOVAL OF EXISTING STRUCTURES *		
STATION	SIDE	ITEM
119+37	Rt.	24" x 18" CMMAC with End Sects.
119+55	Rt.	Sign
120+24-123+00	Lt.	Fence
120+41	Rt.	24" x 18" CMMAC
121+17	Lt.	Sign
122+31	Rt.	Sign

* For Information Only

Sta. 119+10.80, 26.18' Rt.
 Relocate Existing Fire Hydrant Assembly
 to Sta. 119+10.32, 36.00' Rt.
 Bury Line Elev.= 1387.58
 See Sh. No. 78

BM #4 - Found City of Wichita BM Disk in concrete ± 47.6' E and ± 1.4' S
 of 1/4 Section Line between Central & 13th St. on Greenwich Rd.
 (48' Rt. & Greenwich Rd. Sta. 120+21) Elev. 1389.29

- W 1/4 Corner Sec. 15, T27S, R2E
- Found 3/4" I.P. in Center of Traveled Way ± 0.3' Below Surface
 - N 1,691,819.3587 E 1,686,339.5104
 - & Sta. 120+23.77
 - Center of Travel Way on Greenwich 1/2 Mile North of Central
 - City of Wichita Benchmark Disk in Concrete 47.42' E
 - 60d Nail in N Face of Power Pole 63.75' E
 - Center of Fire Hydrant 115.95' SSE
 - 60d Nail in S Face of Power Pole 47.28' W

UTILITIES	
Cable TV	Cox Communications
Gas	Kansas Gas Service
Power	Westar Energy
Telephone	AT&T
Water	Wichita Water & Sewer Dept.

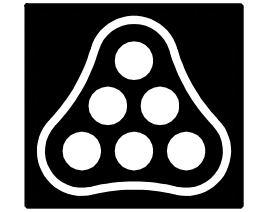

No.	Revision	By	Date
GREENWICH ROAD			
PLAN			
STA. 117+00 TO STA. 123+00			
JAMES L. ARMOUR, P.E.—CITY ENGINEER CITY OF WICHITA PROJECT NO. 472-84435			
Professional Engineering Consultants, P.A. 303 S. TOPEKA • WICHITA, KANSAS 67202 316-262-2691 • FAX 316-262-3003			
Designed by	JPS	Job No.	06471
Drawn by	SVB	Date	June, 2007
			Sht. 7 of 97

DSNR: JPS OPER: SVB SCALE: 1"=20'
 I:/2006/06471/PLAN/06471-Plan 117.DGN 04-23-2007 16:00:00 LAST REV: 5-31-2007 BY: svb