

DSNR: JPS OPER: SVB SCALE: 1"=20' I:/2006/06471/PLAN/06471-Plan 123.DGN 04-23-2007 16:00:00 LAST REV: 5-31-2007 BY: svb

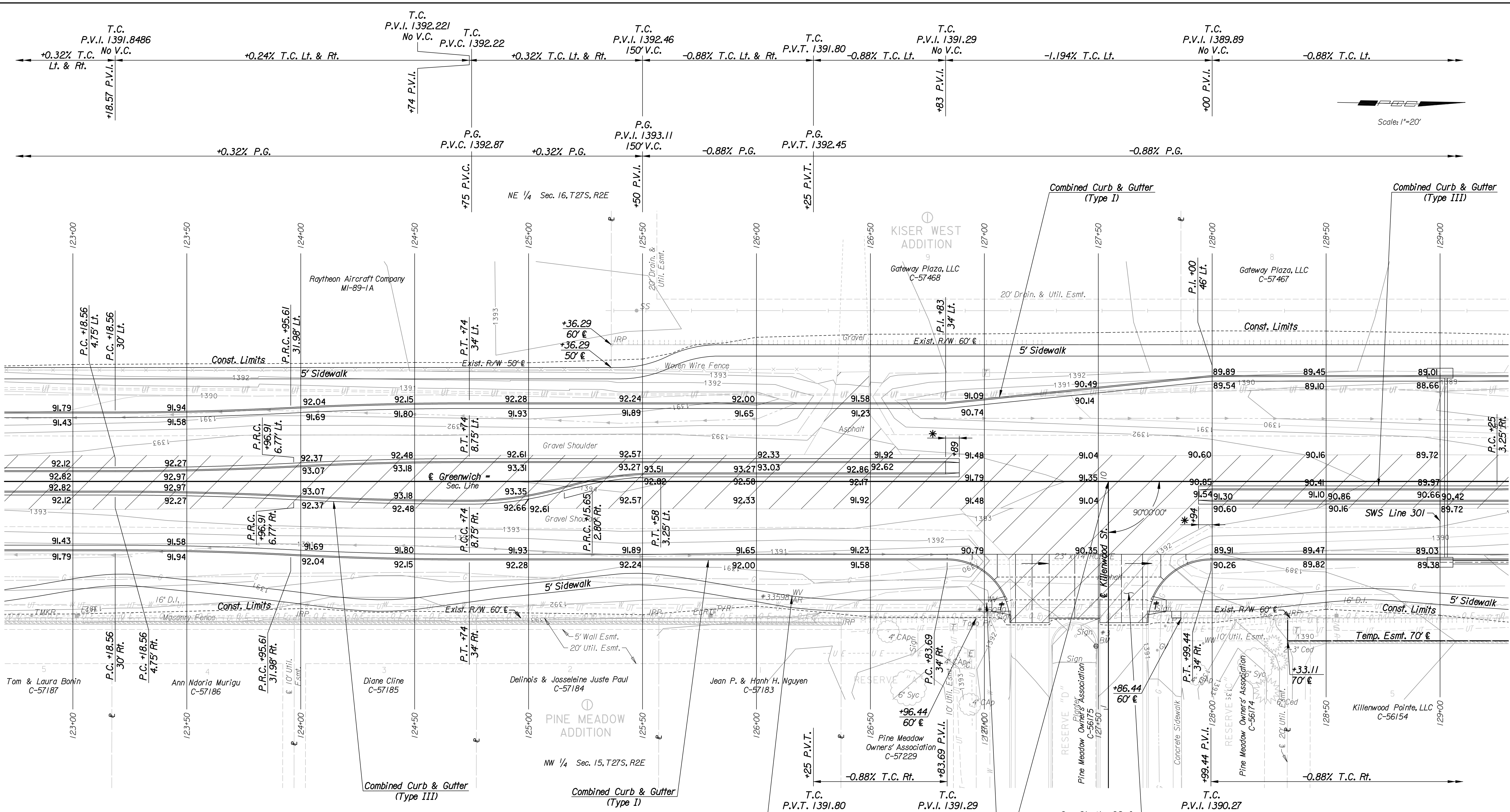

REMOVAL OF EXISTING STRUCTURES *		
STATION	SIDE	ITEM
123+00-126+33	Lt.	Fence
127+40	Rt.	23' x 14' RCPHE with End Sects.
127+75	Rt.	Sign

\* For Information Only

- UTILITIES
- Cable TV Cox Communications
  - Gas Kansas Gas Service
  - Power Westar Energy
  - Sanitary Sewer Wichita Water & Sewer Dept.
  - Telephone AT&T
  - Water Wichita Water & Sewer Dept.

- † Wheelchair Ramp
- \* 6' Transition from Combined Curb & Gutter (Type III) to no curb.

Sta. 126+16.51' Rt.  
Adjust Water Valve Box from  
Elev. 1391.81 to Elev. 1392.20

Sta. 127+01, 54' Rt.  
Adjust Water Valve Box from  
Elev. 1391.98 to Elev. 1391.90

Sta. 127+54.44 @ Greenwich Rd.-  
Sta. 10+00.00 @ Killenwood St.

BM #3 - Set Chiseled "D" on top of curb, NW PC of median in Killenwood.  
(72' Rt. @ Greenwich Rd. Sta. 127+49) Elev. 1392.20

See Sh. No. 28 for  
Intersection Details

No.	Revision	By	Date
GREENWICH ROAD			
<b>PLAN</b>			
<b>STA. 123+00 TO STA. 129+00</b>			
JAMES L. ARMOUR, P.E.-CITY ENGINEER CITY OF WICHITA PROJECT NO. 472-84435			
<b>Professional Engineering Consultants, P.A.</b>			
303 S. TOPEKA • WICHITA, KANSAS 67202 316-262-2691 • FAX 316-262-3003			
Designed by	JPS	Job No.	06471
Drawn by	SVB	Date	June, 2007
			Sht. 8 of 97

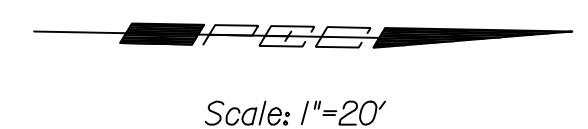
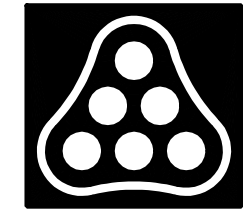

Scale: 1"=20'