

DSNR: JPS OPER: SVB SCALE: 1"=20'
 I:/2006/06471/PLAN/06471-Plan 141.DGN 04-23-2007 16:00:00 LAST REV: 5-31-2007 BY: svb

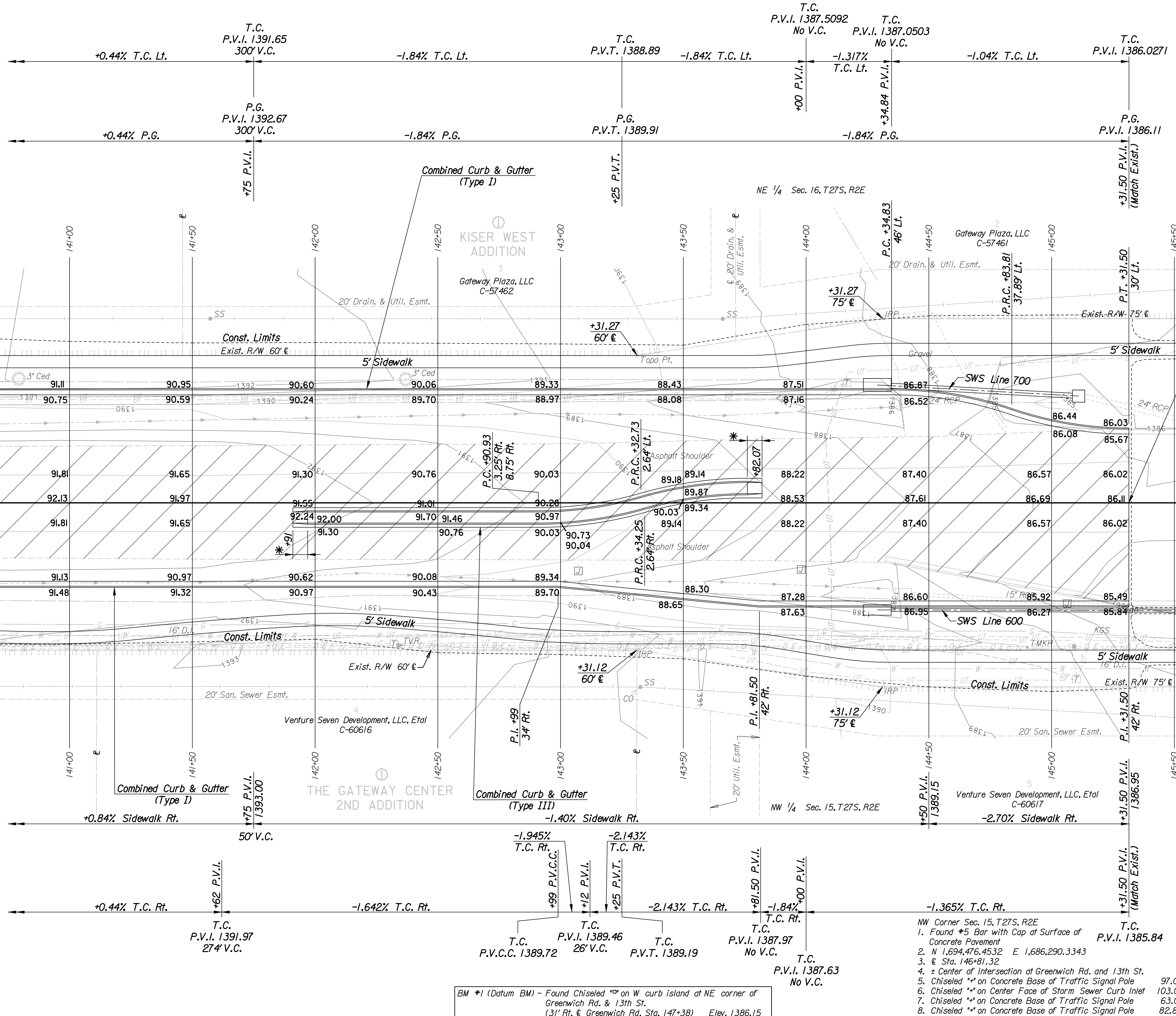

REMOVAL OF EXISTING STRUCTURES *		
STATION	SIDE	ITEM
144+40	Rt.	Area Inlet
144+56	Lt.	24" RCP with End Sects.
145+02	Rt.	15" RCP
145+10	Lt.	Area Inlet
145+28	Rt.	Sign
145+30	Rt.	Sign

* For Information Only

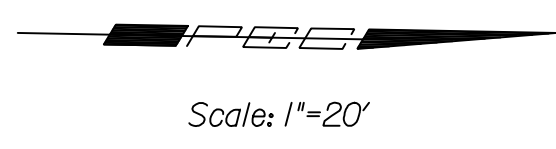

Sta. 145+31.50 END
 PROJECT No. 472-84435

- UTILITIES
- Cable TV
 - Gas
 - Power
 - Sanitary Sewer
 - Telephone
 - Water
 - Cox Communications
 - Kansas Gas Service
 - Westar Energy
 - Wichita Water & Sewer Dept.
 - AT&T
 - Wichita Water & Sewer Dept.

* 6' Transition from Combined Curb & Gutter (Type III) to no curb.

BM *1 (Datum BM) - Found Chiseled "a" on W curb island at NE corner of Greenwich Rd. & 13th St. (31' Rt. & Greenwich Rd. Sta. 147+38) Elev. 1386.15

- NW Corner Sec. 15, T27S, R2E
- Found #5 Bar with Cap at Surface of Concrete Pavement
 - N 1,694,476.4532 E 1,686,290.3343
 - Sta. 146+81.32
 - ± Center of Intersection at Greenwich Rd. and 13th St.
 - Chiseled ** on Concrete Base of Traffic Signal Pole
 - Chiseled ** on Center Face of Storm Sewer Curb Inlet
 - Chiseled ** on Concrete Base of Traffic Signal Pole
 - Chiseled ** on Concrete Base of Traffic Signal Pole

- 97.07' SW
- 103.01' SSE
- 63.01' NE
- 82.82' NW

No.	Revision	By	Date
GREENWICH ROAD			
PLAN			
STA. 141+00 TO STA. 147+00			
JAMES L. ARMOUR, P.E. - CITY ENGINEER CITY OF WICHITA PROJECT NO. 472-84435			
Professional Engineering Consultants, P.A.			
303 S. TOPEKA • WICHITA, KANSAS 67202 316-262-2691 • FAX 316-262-3003			
Designed by	JPS	Job No.	06471
Drawn by	SVB	Date	June, 2007
			Sht. 11 of 97