

CURVE DATA

NO.	Δ	R	T	L	E	P.C. COORDINATES		P.I. COORDINATES		P.T. COORDINATES		C.C. COORDINATES	
						NORTH	EAST	NORTH	EAST	NORTH	EAST	NORTH	EAST
100	17°18'13" Lt.	400.00'	60.86'	120.80'	4.60'	1,692,552.5056	1,686,466.5857	1,692,553.6319	1,686,527.4396	1,692,572.8072	1,686,585.2044	1,692,952.4371	1,686,459.1840
101	22°54'25" Rt.	500.00'	101.30'	199.90'	10.16'	1,692,577.7882	1,686,600.2093	1,692,609.7039	1,686,696.3538	1,692,601.6799	1,686,797.3389	1,692,103.2508	1,686,757.7348
FC204	90°00'00" Rt.	28.00'	28.00'	43.98'	11.60'	1,692,479.7948	1,686,361.2932	1,692,507.7900	1,686,360.7751	1,692,508.3081	1,686,388.7703	1,692,480.3129	1,686,389.2884
FC205	90°00'00" Rt.	28.00'	28.00'	43.98'	11.60'	1,692,568.0479	1,686,387.6646	1,692,567.5298	1,686,359.6694	1,692,595.5250	1,686,359.1513	1,692,596.0431	1,686,387.1465
FC500	02°56'54" Lt.	1498.00'	38.55'	77.08'	0.50'	1,692,113.5437	1,686,304.0606	1,692,152.0870	1,686,303.3473	1,692,190.5426	1,686,300.6524	1,692,085.8243	1,684,806.3171
FC501	02°56'54" Rt.	1524.00'	39.22'	78.42'	0.50'	1,692,190.5426	1,686,300.6524	1,692,229.6657	1,686,297.9108	1,692,268.8779	1,686,297.1851	1,692,297.0785	1,687,820.9241
FC502	02°56'54" Rt.	1498.00'	38.55'	77.08'	0.50'	1,692,114.6540	1,686,364.0503	1,692,153.1973	1,686,363.3370	1,692,191.7262	1,686,364.6070	1,692,142.3734	1,687,861.7938
FC503	02°56'54" Rt.	1524.00'	39.22'	78.42'	0.50'	1,692,191.7262	1,686,364.6070	1,692,230.9240	1,686,365.8991	1,692,270.1362	1,686,365.1734	1,692,241.9357	1,684,841.4344
FC610	02°56'54" Lt.	1523.25'	39.20'	78.38'	0.50'	1,692,114.0109	1,686,329.3063	1,692,153.2039	1,686,328.5809	1,692,192.3077	1,686,325.8406	1,692,085.8243	1,684,806.3171
FC611	02°56'54" Rt.	1498.75'	38.57'	77.12'	0.50'	1,692,192.3077	1,686,325.8406	1,692,230.7826	1,686,323.1444	1,692,269.3452	1,686,322.4307	1,692,297.0785	1,687,820.9241
FC613	16°15'37" Lt.	151.25'	21.61'	42.92'	1.54'	1,692,353.4326	1,686,326.3754	1,692,331.8291	1,686,326.7753	1,692,311.2018	1,686,333.2081	1,692,356.2313	1,686,477.5995
FC614	16°15'37" Rt.	148.75'	21.25'	42.21'	1.51'	1,692,311.2018	1,686,333.2081	1,692,290.9154	1,686,339.5345	1,692,269.6690	1,686,339.9277	1,692,266.9165	1,686,191.2032
FC615	02°56'54" Rt.	1498.75'	38.57'	77.12'	0.50'	1,692,269.6690	1,686,339.9277	1,692,231.1064	1,686,340.6414	1,692,192.5581	1,686,339.3707	1,692,241.9357	1,684,841.4344
FC616	02°56'54" Lt.	1523.25'	39.20'	78.38'	0.50'	1,692,192.5581	1,686,339.3707	1,692,153.3797	1,686,338.0793	1,692,114.1867	1,686,338.8046	1,692,142.3734	1,687,861.7938
FC618	16°15'37" Lt.	151.25'	21.61'	42.92'	1.54'	1,692,720.4900	1,686,326.0832	1,692,742.0935	1,686,325.6834	1,692,762.7208	1,686,319.2506	1,692,717.6912	1,686,174.8591
FC619	16°15'37" Rt.	148.75'	21.25'	42.21'	1.51'	1,692,762.7208	1,686,319.2506	1,692,783.0072	1,686,312.9242	1,692,804.2536	1,686,312.5309	1,692,807.0061	1,686,461.2555

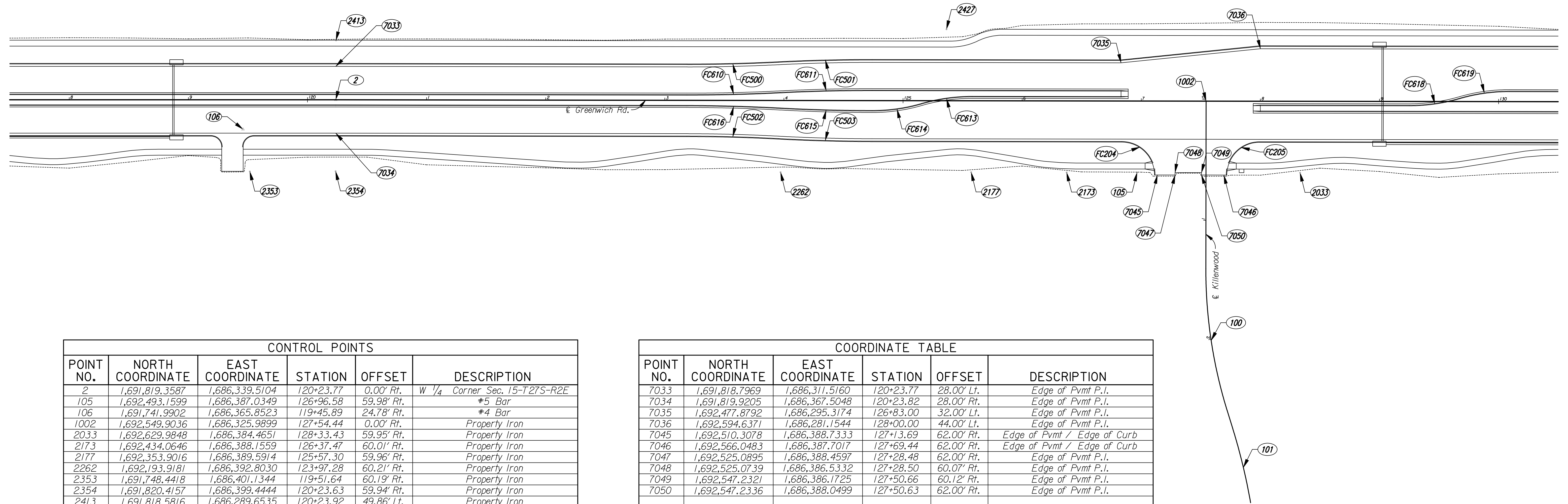

CONTROL POINTS

POINT NO.	NORTH COORDINATE	EAST COORDINATE	STATION	OFFSET	DESCRIPTION
2	1,691,819.3587	1,686,339.5104	120+23.77	0.00' Rt.	W 1/4 Corner Sec. 15-T27S-R2E
105	1,692,493.1599	1,686,387.0349	126+96.58	59.98' Rt.	#5 Bar
106	1,691,741.9902	1,686,365.8523	119+45.89	24.78' Rt.	#4 Bar
1002	1,692,549.9036	1,686,325.9899	127+54.44	0.00' Rt.	Property Iron
2033	1,692,629.9848	1,686,384.4651	128+33.43	59.95' Rt.	Property Iron
2173	1,692,434.0646	1,686,388.1559	126+37.47	60.01' Rt.	Property Iron
2177	1,692,353.9016	1,686,389.5914	125+57.30	59.96' Rt.	Property Iron
2262	1,692,193.9181	1,686,392.8030	123+97.28	60.21' Rt.	Property Iron
2353	1,691,748.4418	1,686,401.1344	119+51.64	60.19' Rt.	Property Iron
2354	1,691,820.4157	1,686,399.4444	120+23.63	59.94' Rt.	Property Iron
2413	1,691,818.5816	1,686,289.6535	120+23.92	49.86' Lt.	Property Iron
2427	1,692,330.7841	1,686,270.0901	125+36.40	59.94' Lt.	Property Iron

COORDINATE TABLE

POINT NO.	NORTH COORDINATE	EAST COORDINATE	STATION	OFFSET	DESCRIPTION
7033	1,691,818.7969	1,686,311.5160	120+23.77	28.00' Lt.	Edge of Pvmf P.I.
7034	1,691,819.9205	1,686,367.5048	120+23.82	28.00' Rt.	Edge of Pvmf P.I.
7035	1,692,477.8792	1,686,295.3174	126+83.00	32.00' Lt.	Edge of Pvmf P.I.
7036	1,692,594.6371	1,686,281.1544	128+00.00	44.00' Lt.	Edge of Pvmf P.I.
7045	1,692,510.3078	1,686,388.7333	127+13.69	62.00' Rt.	Edge of Pvmf / Edge of Curb
7046	1,692,566.0483	1,686,387.7017	127+69.44	62.00' Rt.	Edge of Pvmf / Edge of Curb
7047	1,692,525.0895	1,686,388.4597	127+28.48	62.00' Rt.	Edge of Pvmf P.I.
7048	1,692,525.0739	1,686,386.5332	127+28.50	60.07' Rt.	Edge of Pvmf P.I.
7049	1,692,547.2321	1,686,386.1725	127+50.66	60.12' Rt.	Edge of Pvmf P.I.
7050	1,692,547.2336	1,686,388.0499	127+50.63	62.00' Rt.	Edge of Pvmf P.I.

DSNR: JPS OPER: MJW SCALE: I:/2006/06471/GEOMETRY/06471-GEOMETRY118.DGN LAST REV: 5-31-2007 BY: svb

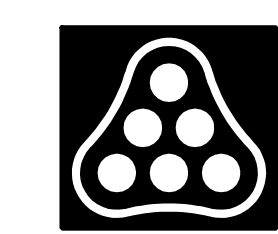

No.	Revision	By	Date
GREENWICH ROAD			
<b>COORDINATE GEOMETRY PLAN</b>			
STA. 118+00 TO STA. 130+00			
JAMES L. ARMOUR, P.E. - CITY ENGINEER CITY OF WICHITA PROJECT NO. 472-84435			
<b>Professional Engineering Consultants, P.A.</b>			
303 S. TOPEKA • WICHITA, KANSAS 67202 316-262-2691 • FAX 316-262-3003			
Designed by	JPS	Job No.	06471
Drawn by	MJW	Date	June, 2007
			Sht. 14 of 97