

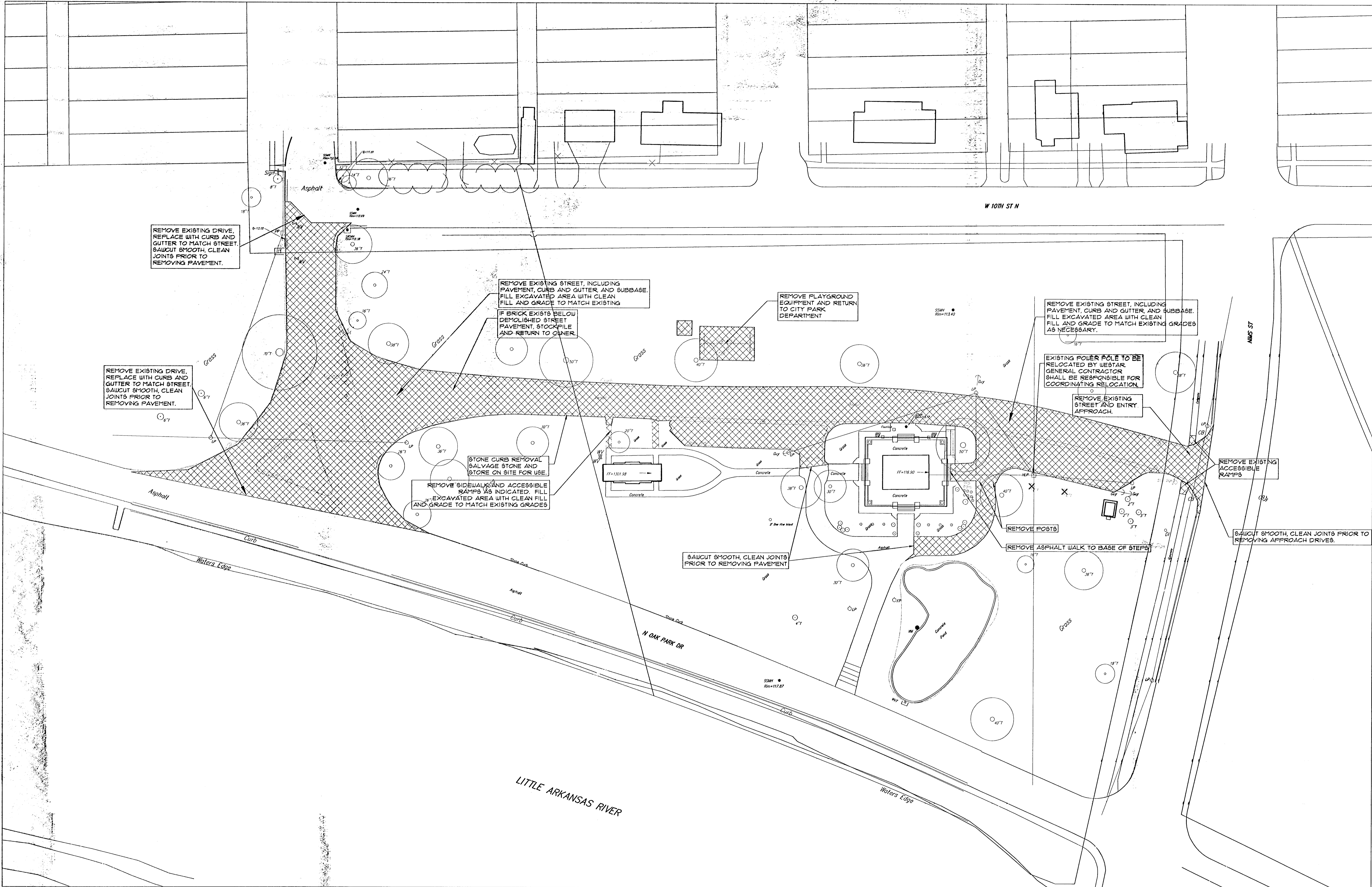

RIVERSIDE PARK SYSTEM
Riverside Pavement Contract
Wichita, Kansas



REMOVE EXISTING DRIVE, REPLACE WITH CURB AND GUTTER TO MATCH STREET. SAWCUT SMOOTH, CLEAN JOINTS PRIOR TO REMOVING PAVEMENT.

REMOVE EXISTING STREET, INCLUDING PAVEMENT, CURB AND GUTTER, AND SUBBASE. FILL EXCAVATED AREA WITH CLEAN FILL AND GRADE TO MATCH EXISTING.

REMOVE PLAYGROUND EQUIPMENT AND RETURN TO CITY PARK DEPARTMENT.

REMOVE EXISTING STREET, INCLUDING PAVEMENT, CURB AND GUTTER, AND SUBBASE. FILL EXCAVATED AREA WITH CLEAN FILL AND GRADE TO MATCH EXISTING GRADES AS NECESSARY.

EXISTING POWER POLE TO BE RELOCATED BY WESTAR. GENERAL CONTRACTOR SHALL BE RESPONSIBLE FOR COORDINATING RELOCATION.

REMOVE EXISTING STREET AND ENTRY APPROACH.

REMOVE EXISTING ACCESSIBLE RAMPS.

SAWCUT SMOOTH, CLEAN JOINTS PRIOR TO REMOVING APPROACH DRIVES.

REMOVE EXISTING DRIVE, REPLACE WITH CURB AND GUTTER TO MATCH STREET. SAWCUT SMOOTH, CLEAN JOINTS PRIOR TO REMOVING PAVEMENT.

STONE CURB REMOVAL SALVAGE STONE AND STORE ON SITE FOR USE.

REMOVE SIDEWALK AND ACCESSIBLE RAMPS AS INDICATED. FILL EXCAVATED AREA WITH CLEAN FILL AND GRADE TO MATCH EXISTING GRADES.

SAWCUT SMOOTH, CLEAN JOINTS PRIOR TO REMOVING PAVEMENT.

REMOVE POSTS.

REMOVE ASPHALT WALK TO BASE OF STEPS.

- LEGEND:**
- PAVEMENT TO BE REMOVED
 - TREE TO BE REMOVED

- NOTES**
1. REFER TO RIVERSIDE PARK IMPROVEMENT DOCUMENT SHEET VI-DJ FOR ADDITIONAL DEMOLITION WORK RELATED TO PARK IMPROVEMENTS IN THIS AREA.
 2. ALL TREE REMOVAL AS NOTED MUST BE APPROVED BY L.A. OR PARK DEPT. REPRESENTATIVE PRIOR TO REMOVAL.
 3. REMOVE ANY ITEMS NOT SHOWN THAT CONFLICT WITH CONSTRUCTION. CONTRACTOR SHALL CONTACT OWNER'S REPRESENTATIVE PRIOR TO REMOVAL.
 4. SALVAGE ALL STONE MATERIALS (STONE VENEER, RETAINING WALL STONE, STONE CURBS, ROADWAY BRICK, ETC) AND RETURN TO CITY.

PARK VILLA DEMOLITION PLAN

SCALE: 1" = 30'-0"

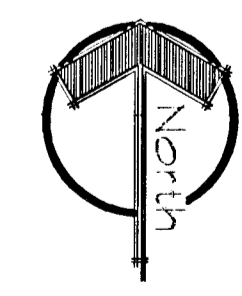

KEY PLAN

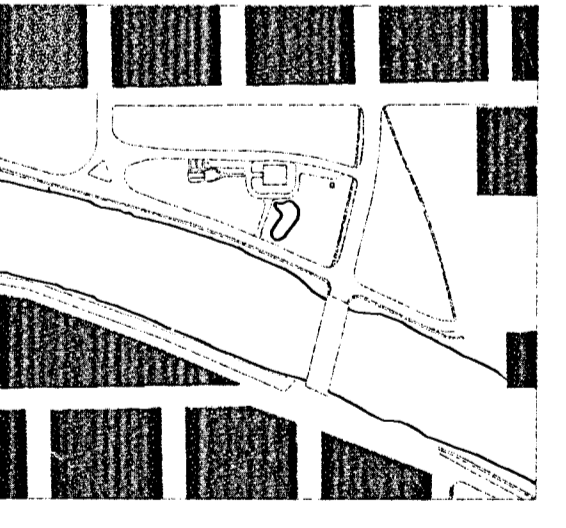

PARK VILLA

PRINTS ISSUED
MAY 3, 2002 - 50% REVIEW
JULY 1, 2002 - 85% REVIEW
SEPTEMBER 6, 2002 - FOR BID

WDM No. 00113
Drawn: BOT/KDM
Checked: PJM/NBW

Park Villa Demolition Plan

SECTION ONE
4 of 6