

BENCHMARKS:

BM #1: "X" on the West End of the Steel Casing Pipe at the Railroad Crossing South of 37th Street North Sta. 25+90, 41' Rt. Elev. = 1336.58 MSL

BM #2: Steel T-Post Driven 4' Deep Sta. 18+00, 25' Rt. Elev. = 1337.73 MSL

BM #3: "□" in the Concrete Footing of the SBC Pedestal in the South West Corner of 37th Street North and Tyler Road Sta. 8+56, 95' Rt. Elev. = 1342.17 MSL

BM #4: Railroad Spike in the East Face of the 2nd Power Pole North of 37th Street and West of Tyler Road Sta. 94+24, 48' Lt. Elev. = 1342.85 MSL

Sta 5+30.75, 36' Lt. Install std. D3 (SNS) ass'y as per City specs. "Conrey" & Metro SNS "Forest Ridge Ct" (-----).

Sta 5+48.03, 36' Lt. Install std. D3 (SNS) ass'y as per City specs. "Conrey" & Metro SNS "Forest Ridge Ct" (-----).

Sta 5+22.95, 36' Lt. Install std. D3 (SNS) ass'y as per City specs. "Forest Ridge" & Metro SNS "Forest Ridge Ct" (-----).

Sta 5+75.59, 26' Lt. Install std. D3 (SNS) ass'y as per City specs. "Forest Ridge".

Sta 5+90.23, 36' Lt. Construct std. D3 (SNS) ass'y as per City specs. "Forest Ridge" & Metro SNS "Forest Ridge Ct" (-----).

Sta 5+61.37, 36' Lt. Install std. D3 (SNS) ass'y as per City specs. "Forest Ridge".

Sta 5+97.00, 36' Lt. Construct std. D3 (SNS) ass'y as per City specs. "Forest Ridge" & Metro SNS "Forest Ridge Ct" (-----).

Sta 7+93.45, 36' Lt. Construct std. D3 (SNS) ass'y as per City specs. "Forest Ridge" & Metro SNS "Forest Ridge Ct" (-----).

Sta 8+27.45, 36' Lt. Install std. D3 (SNS) ass'y as per City specs. "Forest Ridge" & Metro SNS "Forest Ridge Ct" (-----).

Sta 8+61.45, 36' Lt. Install std. D3 (SNS) ass'y as per City specs. "Forest Ridge" & Metro SNS "Forest Ridge Ct" (-----).

Curve #3
Curve Data Based on Centerline
Rad. = 100' Delta = 71° 48' 18" Tangent = 72.39'
Arc = 125.32' L.C. = 117.28' Def/Ft. = 17.18920 Min.

Station	Arc	FACE CHORD LENGTHS		Defl.	T. Defl.
		8' Lt.	8' Rt.		
4+36.05	-	-	-	0°00'00"	0°00'00"
4+50.00	13.95'	17.42'	10.45'	3°59'47"	3°59'47"
4+75.00	25.00'	31.17'	18.70'	7°09'44"	11°09'31"
5+00.00	25.00'	31.17'	18.70'	7°09'44"	18°19'15"
5+22.95	22.95'	28.63'	17.18'	6°34'29"	24°53'44"
5+48.03	25.09'	31.27'	18.76'	7°11'08"	32°04'51"
5+61.37	13.34'	16.66'	10.00'	3°49'18"	35°54'09"

P.V.I.
Elev. = 148.00
70' V.C.

Scale: 1" = 20'
• = Iron

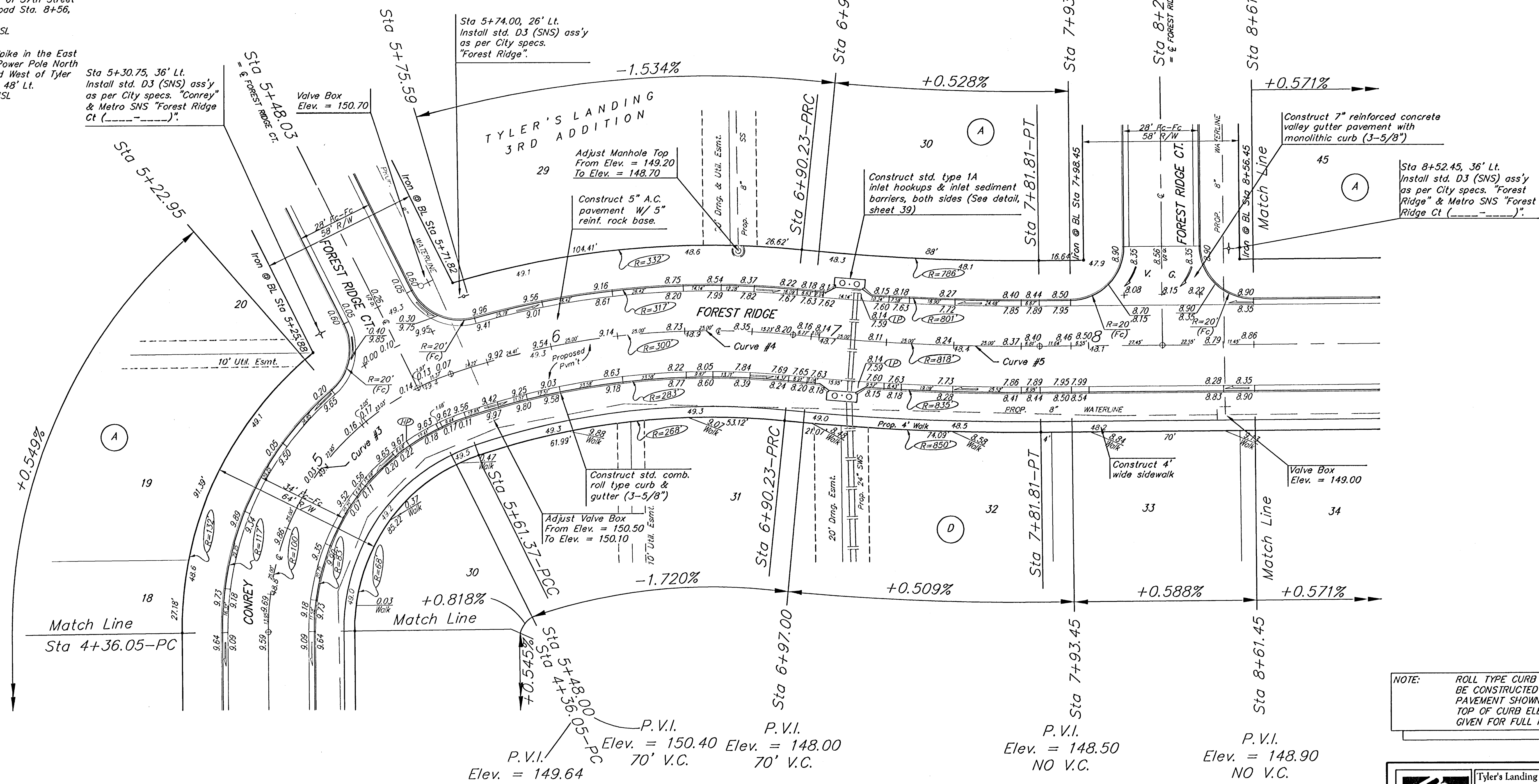

Curve #4
Curve Data Based on Centerline
Rad. = 300' Delta = 24° 36' 35" Tangent = 65.44'
Arc = 128.86' L.C. = 127.87' Def/Ft. = 5.72941 Min.

Station	Arc	FACE CHORD LENGTHS		Defl.	T. Defl.
		8' Lt.	8' Rt.		
5+61.37	-	-	-	0°00'00"	0°00'00"
5+75.59	14.22'	15.40'	13.03'	1°21'28"	1°21'28"
6+00.00	24.41'	26.44'	22.37'	2°19'51"	3°41'19"
6+25.00	25.00'	27.07'	22.91'	2°23'14"	6°04'34"
6+50.00	25.00'	27.07'	22.91'	2°23'14"	10°51'02"
6+75.00	25.00'	27.07'	22.91'	2°23'14"	12°18'17"

Curve #5
Curve Data Based on Centerline
Rad. = 818' Delta = 6°24'54" Tangent = 45.84'
Arc = 91.58' L.C. = 91.54' Def/Ft. = 2.10144 Min.

Station	Arc	FACE CHORD LENGTHS		Defl.	T. Defl.
		8' Lt.	8' Rt.		
6+90.23	-	-	-	0°00'00"	0°00'00"
6+97.00	6.77'	6.56'	6.98'	0°14'14"	0°14'14"
7+00.00	3.00'	2.91'	3.09'	0°08'18"	0°20'32"
7+25.00	25.00'	24.24'	25.76'	0°52'32"	1°13'04"
7+50.00	25.00'	24.24'	25.76'	0°52'32"	2°05'36"
7+75.00	25.00'	24.24'	25.76'	0°52'32"	2°58'08"
7+81.81	6.81'	6.60'	7.02'	0°14'19"	3°12'27"

NOTE: ROLL TYPE CURB & GUTTER TO BE CONSTRUCTED ON THE PAVEMENT SHOWN ON THIS SHEET. TOP OF CURB ELEVATIONS ARE GIVEN FOR FULL HEIGHT CURB.

Adjust water valve boxes as needed to grade. Incidental to 'Site Clearing and Restoration'.

Contractor to remove existing trees, fence, etc. as needed to complete paving project. Removal shall be incidental to bid item 'Site Clearing and Restoration'.

Tyler's Landing 3rd Addition - Phase I
Forest Ridge
STA 4+36.05 TO STA 8+61.45

Baughman
Engineering | Surveying | Planning | Landscape Architecture

PROJECT NUMBER: 472-84262
DESIGN: AEO
DRAWN: JWH/TMS
APPROVED: [Signature]
DATE: 08/05

SCALE: Noted
SHEET: 7 OF 52

tylers landing 3rd add.dwg 0507-E283